



Dometic

THE SIGN OF COMFORT



EN	Alcohol stoves Operating manual	8
DE	Spirituskocher Bedienungsanleitung	24
FR	Cuisinières à alcool Notice d'utilisation	41
ES	Hornillos de alcohol Instrucciones de uso	58
NL	Spirituskooktoestellen Gebruiksaanwijzing	76
IT	Fornelli ad alcool Istruzioni per l'uso	92
FI	Spriikeitin Käyttöohje	108
SV	Spritkök Bruksanvisning	124

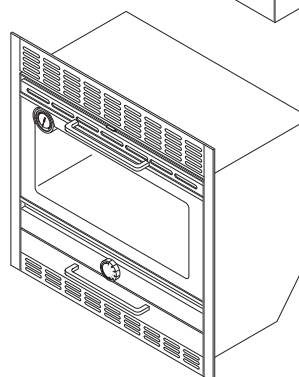
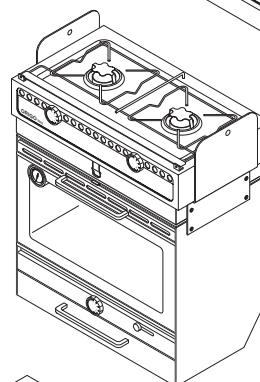
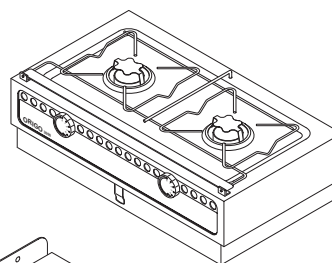

ORIGO 1500, 3000
ORIGO 6000, 6100, 6200





Dometic ORIGO

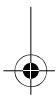
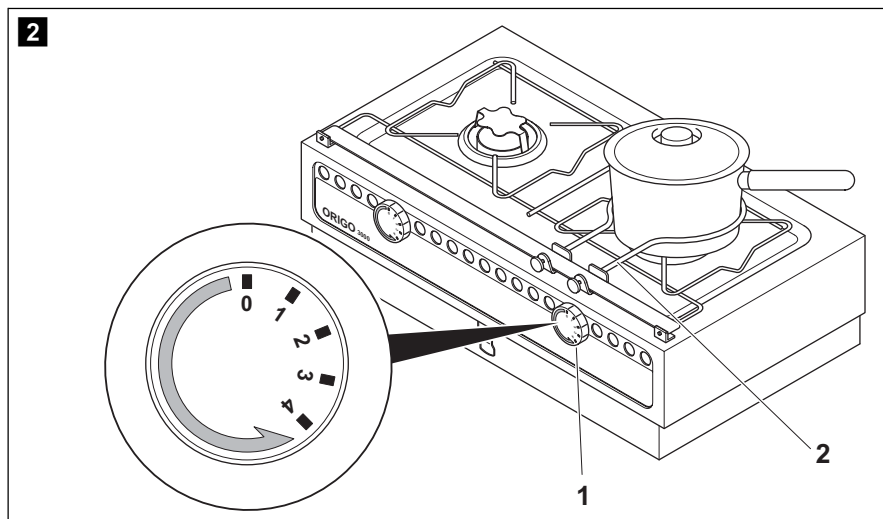
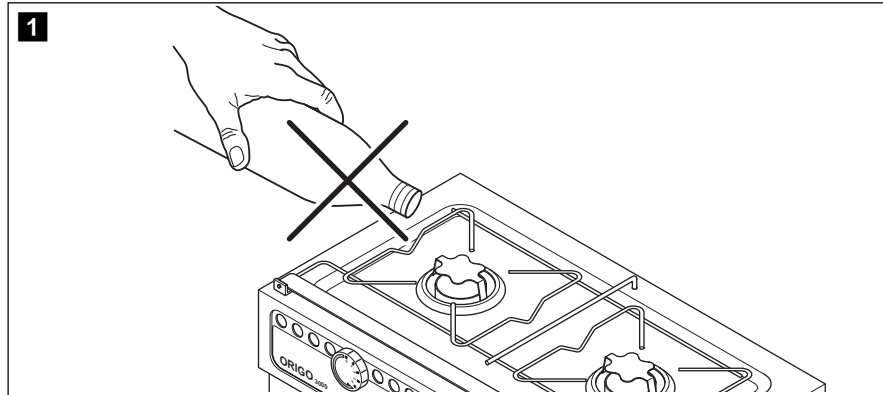

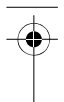

Dometic ORIGO

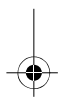
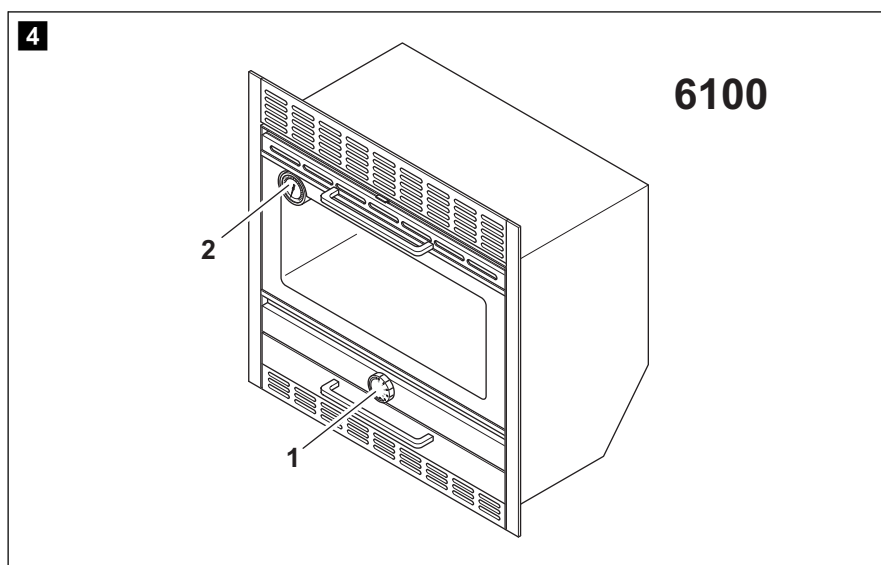
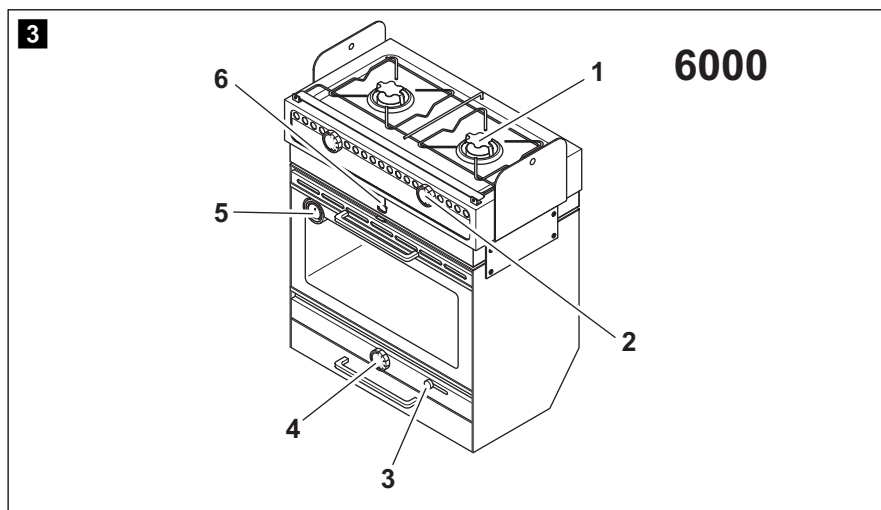



Dometic ORIGO

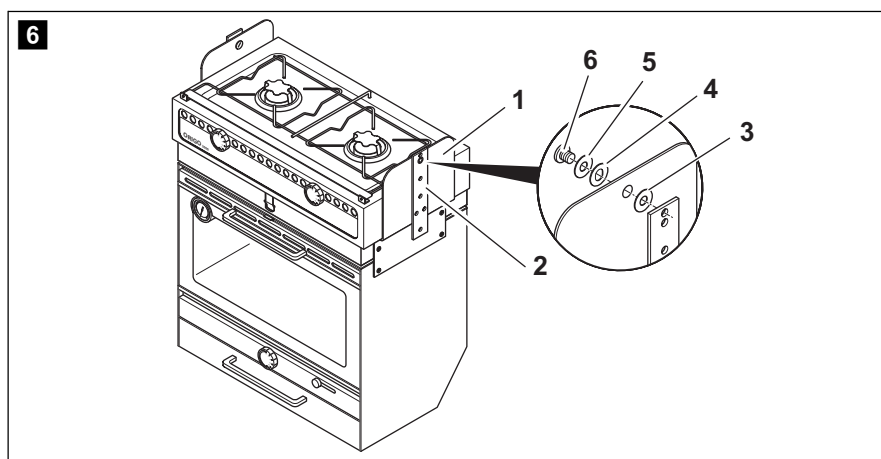
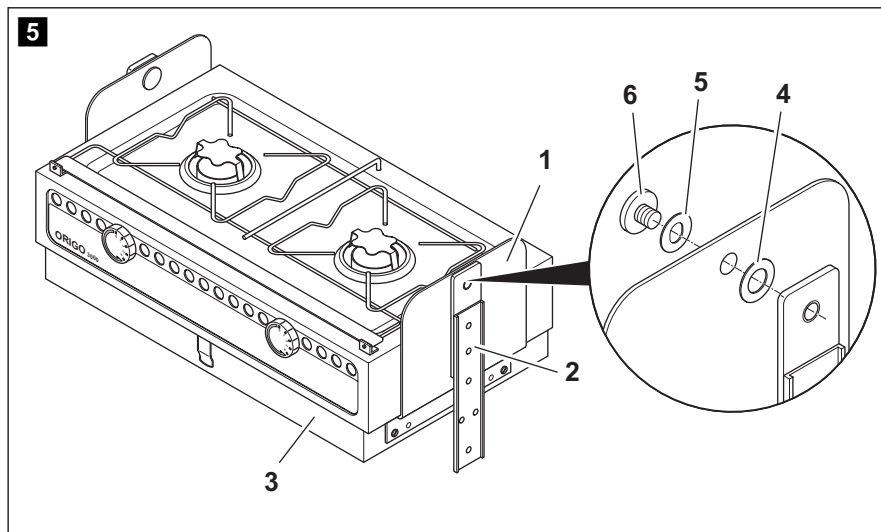



Dometic ORIGO

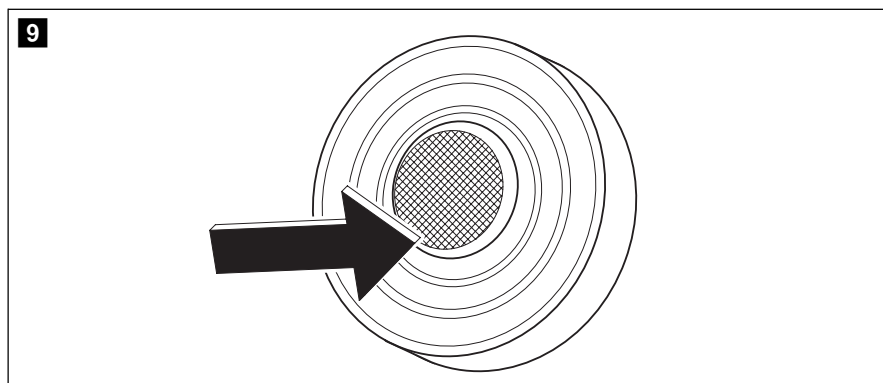
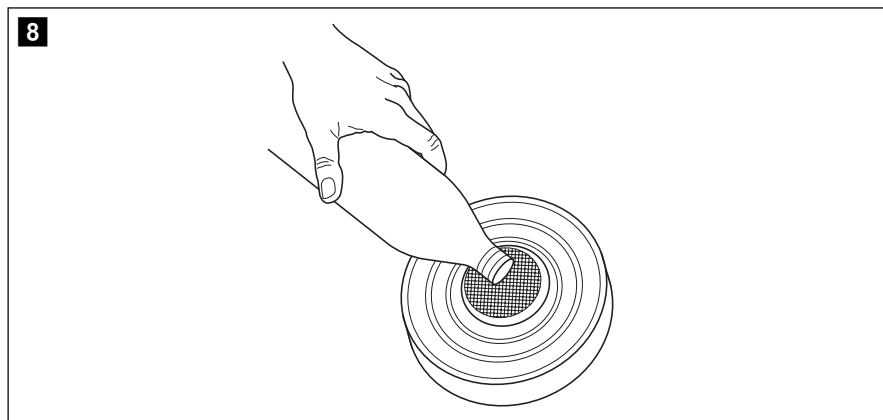
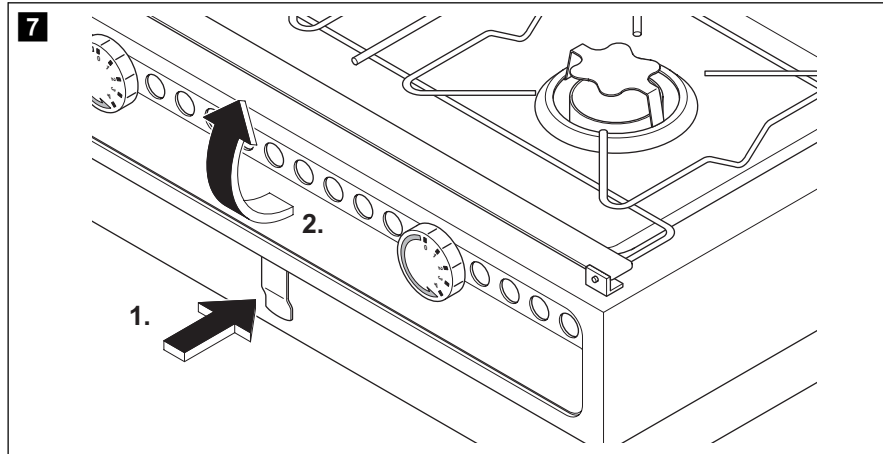



Dometic ORIGO

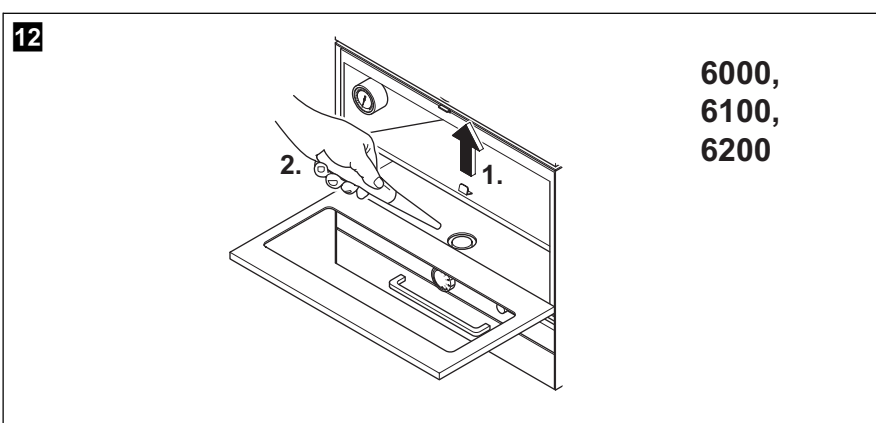
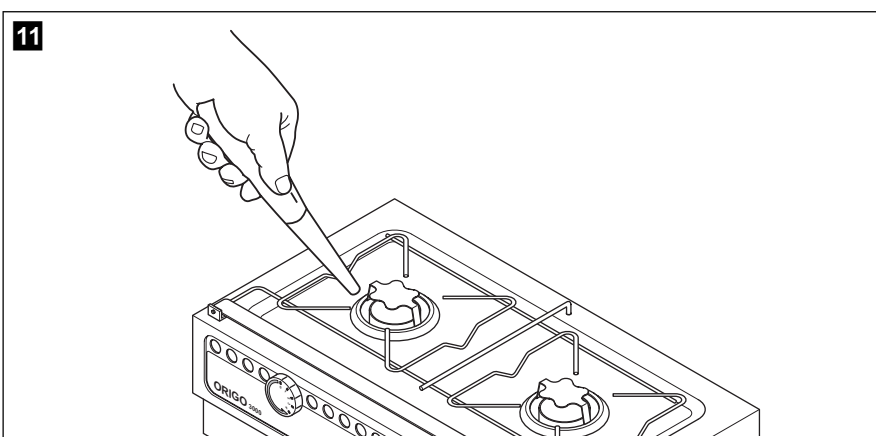
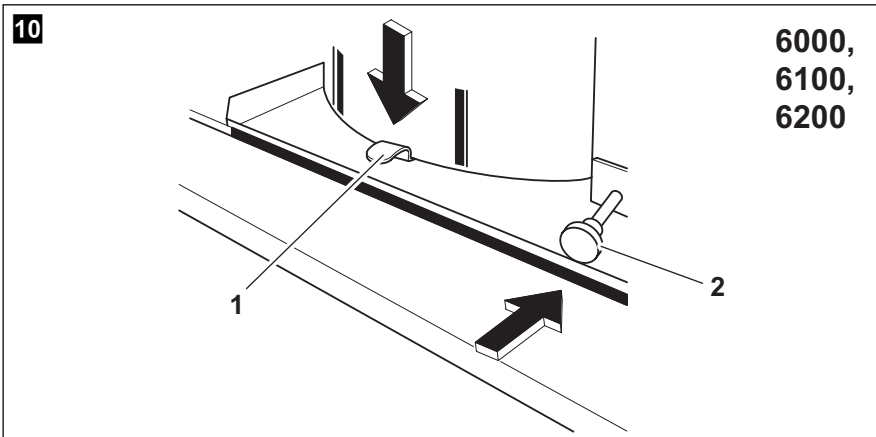

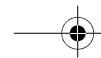

Dometic ORIGO

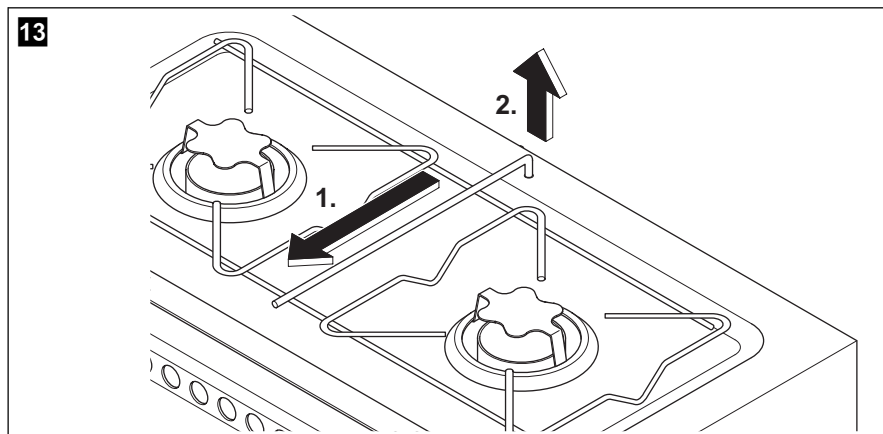



Dometic ORIGO

Please read this manual carefully before installing and starting up the device, and store it in a safe place. If the device is passed on to another person, this manual must also be handed over with it.

Table of contents

1	Notes on using the manual	9
2	General safety instructions	9
3	Scope of delivery	11
4	Accessories	12
5	Intended use	12
6	Technical description	12
7	Mounting the stove.	14
8	Using the stove	17
9	Cleaning and maintaining the stove.	21
10	Guarantee	22
11	Disposal	22
12	Technical data	22

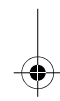
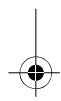



1 Notes on using the manual



Warning!

Safety instruction: failure to observe this instruction can cause material damage or personal injury.



Caution!

Safety instruction: Failure to observe this instruction can cause material damage and impair the function of the device.



Note

Supplementary information for operating the device.

► **Action:** This symbol indicates that action is required on your part. The required action is described step-by-step.

✓ This symbol describes the result of an action.

fig. 1 5, page 3: This refers to an element in an illustration. In this case, item 5 in figure 1 on page 3.

Please observe the following safety instructions.

2 General safety instructions

The manufacturer will not be held liable for claims for damage resulting from the following:

- Faulty assembly or connection
- Damage to the appliance resulting from mechanical influences and excess voltage
- Alterations to the device without express permission from the manufacturer
- Use for purposes other than those described in the operating manual





General safety instructions

Dometic ORIGO

2.1 General safety



- Use denatured alcohol only. Do **not** use other fuels such as gasoline, diesel, methanol, propane or charcoal lighter.
- **Danger of asphyxiation!**
Before starting the device, ensure that the area is sufficiently ventilated.
- Place a class A fire extinguisher (for alcohol fires) in reaching distance.
Ensure the fire extinguisher is regularly checked by qualified personnel.
- Persons whose physical, sensory or mental capacities prevent them from using this device safely should not operate it without the supervision of a responsible adult.



- Use the stove only as intended.

2.2 Safety precautions when handling denatured alcohol



- Keep inflammable substances apart from heating and cooking devices and other light and heat sources.
- Store alcohol in suitable containers only and in sufficient distance from the stove.
- Eliminate all sources of sparks or flames where the alcohol is stored or filled-in.
- Never fill the canisters while still in the stove. Never pour fuel through the burner openings in top of the stove (fig. **1**, page 2).
- Overfilling, spilt alcohol and hot objects can cause severe burns.
- Denatured alcohol burns with almost invisible flame, so great damage can arise before you notice the danger.



- Mop up any spilt alcohol immediately to prevent uncontrollable burning.
- Do not smoke when handling alcohol or when operating the stove.



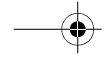

Dometic ORIGO

Scope of delivery

- Fill the canister to the maximum capacity only. Alcohol expands in the canister when heated. Overfilled alcohol can cause uncontrollable burning inside the stove.

2.3 Operating the device safely



- Use long matches or long lighters to light the burner. Quickly remove your hand as soon as the burner ignites.
- Wear proper clothing when operating the stove. Do not wear hanging garments which can catch fire.



- Let the stove cool down to ambient temperature before you touch it with bare hands.
- Keep the area surrounding the stove and interior parts free of grease, fat, alcoholic substances, plastic or inflammable cloths (for instance curtains, towels, kitchen utensils).
- Use only pots and pans with a maximum diameter of 23 cm.
- When cooking ensure that pans and pots are securely in position. Recommended is the use of pot holders (fig. **2** 2, page 2, **accessory**).
- Be careful when heating grease or oil. Grease and oil catch fire when exposed to great heat.
- Use only dry pot cloths to prevent the formation of steam. Do not use towels or the like instead of pot cloths as these can catch fire.
- Never leave the stove unattended when cooking. Pots boiling over can cause smoke and fires.
- Move the burner control (fig. **2** 1, page 2) to the off position before removing the pot.
- Do not use the stove to heat the environment.

3 Scope of delivery

- Stove
- Gasket per canister
- **6000, 6200 only:** Gimbals





Accessories

Dometic ORIGO

4 Accessories

Description	Item no.				
	1500	3000	6000	6100	6200
Gimbals	958148201	—	—	—	—
Pot Holder	958148001	958148001	—	—	958148001
Cutting Board	388015415	388004630	388004630	—	388004630

5 Intended use

The Dometic ORIGO stoves are designed for use in vehicles or boats.

6 Technical description

6.1 Function

Stoves and ovens are made of stainless steel and use the absorption principle. The canister has a capacity of 1.2 l. Denatured alcohol is used as fuel.

Alcohol is absorbed into a non-flammable material in the canister. They are not equipped with fuel valve or fuel lines, which can develop leaks, or with other such components requiring regular service.

6.2 Specifications for the device variants

Various stove versions are available.

- **1500:** single-burner unit
- **3000:** double-burner unit
- **6000:** double-burner unit with additional oven
- **6100:** oven without cooktop for build-in mounting
- **6200:** oven without cooktop, can be combined with 3000

To define your device see the item number on the type plate.





6.3 Operating elements

Operating elements for operation with denatured alcohol (fig. **2**, page 2):

No.	Description
1	Control knob – “0”: burner closed – “4”: burner open
2	Pot holder (accessory)

Operating elements of Origo 6000 and 6200 (fig. **3**, page 3):

No.	Description
1	Burner opening of stove
2	Knob for regulating the stove
3	Swing locking device
4	Oven knob for regulating the oven – “0”: burner closed – “4”: burner open
5	Oven thermometer
6	Catch of stove top

Operating elements of Origo 6100 (fig. **4**, page 3):

No.	Description
1	Oven knob for regulating the oven – “0”: burner closed – “4”: burner open
2	Oven thermometer

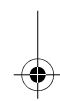
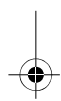



7 Mounting the stove

You can fit the stove (1500/3000) into the countertop of your kitchen. Place Origo 6000 – 6200 into your kitchen.

7.1 Selecting the installation location

When selecting the installation location, observe the following instructions:

- Select a well-ventilated location for the device.
- Avoid draft at the installation location.
If you fit the stove in an open cockpit or other open areas mount an additional wind protection.
- Do **not** operate the device in spaces where danger of explosion is present.
- Leave a clearance of at least 50 mm to the side walls and 750 mm to uninsulated surface above the stove.
- If gimbals are used (**accessory for 1500 and 3000**), ensure that the stove can swing freely.
- **6000, 6200:** Leave at least 100 mm to the back wall and 750 mm to uninsulated surface above the oven.
- **6000, 6200:** Ensure you have ample room to swing the gimballed range.

7.2 Installing the stove (fig. 5, page 4)



Caution – Danger of damaging the device!

Before drilling any holes, make sure that no electrical cables or other parts of the vehicle can be damaged by drilling, sawing and filing.

If you don't use gimbals, mount the stove as follows:

- Drill through the markings in the stove bottom.
- Fasten the stove through the holes in place.





Dometic ORIGO

Mounting the stove

The manufacturer recommends the use of gimbals to mount ORIGO 1500 or 3000 (**accessory**). Mount the gimbals as follows:

- Fasten the gimbal sideplates (1) to the lower body of the stove (3) using the enclosed nuts and bolts.



Note

The gimbal arms (2) can be turned to enable the stove (3) to be lowered forwards or backwards.

- Before mounting the gimbal arms (2), make a test by attaching them to the gimbal sideplates (1) in order to determine which alternative is right for your boat.

Remember, when the gimbals are in down position, the stovetop must be raised to full upright position in order to remove the fuel canisters for filling.

Ensure the installation is done according to fig. 5, page 4.

- Place the fibre washers (4) with round holes on the gimbal arms (2).
- Lift the stove into position.
- Place the fibre washers (5) with oblong holes on the gimbal sidearms (2).
- Fasten the screws (6).
- Adjust the tension of the screws to the desired friction.
- Place a class B-1 fire extinguisher in reaching distance.

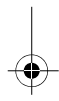



Mounting the stove

Dometic ORIGO

7.3 Installing Origo 6000 and 6200 (fig. **6**, page 4)



Caution – Danger of damaging the device!

Before drilling any holes, make sure that no electrical cables or other parts of the vehicle can be damaged by drilling, sawing and filing.

- Determine the best position for the pivot points by placing the range in the desired position.
- Open the stovetop.
- Mark the fixing points through the holes in the gimbal sideplates (1).
- Remove the range.
- Fasten the gimbal arms (2) with fibre washers and screws removed.
- Fit one fibre washer with round hole (3) on each gimbal arm (2).
- Lift the range in-between gimbal arms (2) so that the gimbal sideplates will spring into place on the gimbal arms (2).
- With open stovetop fit the fibre washers with oblong holes (4) to the gimbal arm (2).
Ensure they fit properly on the gimbal arms (2) so they can't rotate.
- Fit steel washers (5), screws (6) and tighten.
- Adjust the tension of the screws to desired friction.
- Place a class B-1 fire extinguisher in reaching distance.

7.4 Installing Origo 6100



Caution – Danger of damaging the device!

Before drilling any holes, make sure that no electrical cables or other parts of the vehicle can be damaged by drilling, sawing and filing.

- Make a cutout with the following dimensions (W x H x D):
490 x 530 x 400 mm.
- Place the oven into the cutout.
- Fix the oven.
- Place a class B-1 fire extinguisher in reaching distance.





8 Using the stove

8.1 Filling-in denatured alcohol



Caution! Danger of injury!

Never pour fuel through the burner openings in top of the stove (fig. **1**, page 2).

Overfilling, spilt alcohol and hot objects can cause severe burns.



Note

If the stove is mounted with gimbals located in down position, the stovetop must be raised to full upright position in order to remove the fuel tanks for filling.

- Ensure all burners are turned off: turn the knob to "0". Otherwise the stove top cannot be opened.
- Ensure the stove is cooled down to room temperature.
- Pull the lower edge of the stovetop slightly forward while simultaneously pressing the catch (fig. **7**, page 5).
- Lift the stovetop.
- Check canister opening ensuring there's neither fire nor glow.
- Take out the canister.
- Hold the canister tilted down (fig. **8**, page 5).
- Fill the denatured alcohol through the wire mesh into the opening of the canisters.
The maximum capacity per canister must not exceed 1.2 l.
- Check the fuel level by tilting the canister vertically (fig. **9**, page 5).
Keep it in this position for 20 s, to make sure it's not overfilled. In addition, in the case of accidental overfilling you can get rid of the surplus fuel.
- ✓ The maximum fuel level is reached when the fuel is visible at the bottom of the opening.



Note

The stove will operate even if the canister isn't filled with the maximum capacity.





Using the stove

Dometic ORIGO

- Wipe possible spilt alcohol off the outside of the canister.
- Replace the canister.
- Close the stovetop.
The knobs must be in "0"-position; otherwise the stove top will not fold.
- ✓ The catch locks.
- Ensure the regulating plates cover the burner openings so that stovetop is level.

8.2 Filling-in denatured alcohol for the oven (6000 – 6200 only)



Caution! Danger of injury!

Never pour fuel through the burner opening in top of the oven.
Overfilling, spilt alcohol and hot objects can cause severe burns.

- Ensure the burner is turned off: turn the oven knob to "0".
- Ensure the oven is cooled down to room temperature.
- Open the burner lid.
- Push the knob (fig. 10 2, page 6) while simultaneously pressing the catch (fig. 10 1, page 6).
- Take out the canister.
- Check canister opening ensuring there's neither fire nor glow.
- Hold the canister tilted down (fig. 8, page 5).
- Fill the denatured alcohol through the wire mesh into the opening of the canisters.
The maximum capacity per canister must not exceed 1.2 l.
- Check the fuel level by tilting the canister vertically (fig. 9, page 5).
Keep it in this position for 20 s, to make sure it's not overfilled. In addition, in the case of accidental overfilling you can get rid of the surplus fuel.
- ✓ The maximum fuel level is reached when the fuel is visible at the bottom of the opening.





Note

The oven will operate even if the canister isn't filled with the maximum capacity.

- Wipe possible spilt alcohol off the outside of the canister.
- Replace the canister into the compartment.
- ✓ The catch locks.

8.3 Lighting the stove



Caution! Danger of injury!

Use long matches or long lighters to light the burner.
Quickly remove your hand as soon as the burner ignites.

- Turn the knob to "4".
- ✓ The burner is open.
- Light the stove by placing a long match or a long lighter to the burner opening (fig. 11, page 6).
- Adjust the flame so it does not extend beyond the edge of the pot.
- Choose the desired power setting via knob.



Note

If the stove hasn't cooled down from previous use, the burner may ignite but immediately extinguish. In this case blow air into the burner opening to dissipate vapour.
Afterwards light the stove as described above.





Using the stove

Dometic ORIGO

8.4 Lighting the oven



Caution! Danger of injury!

Use long matches or long lighters to light the burner.
Quickly remove your hand as soon as the burner ignites.

- Turn the oven knob to “4”.
- ✓ The burner is open.
- ✓ Open the oven door.
- Lift the burner lid (fig. 12 1, page 6).
- Light the oven by placing a long match or a long lighter to the burner opening (fig. 12 2, page 6).
- Choose the desired power setting via oven knob.



Note

If the oven hasn't cooled down from previous use, the burner may ignite but immediately extinguish. In this case blow air into the burner opening to dissipate vapour.
Afterwards light the oven as described above.

8.5 Extinguish the flame

- Turn the knob to “0”.
- ✓ The burner is closed.
- Wait about five seconds.
- Turn the knob to “4” to make sure the flame is extinguished.
- ✓ The burner is open.
- Turn the knob to “0”.
- ✓ The burner is closed.





8.6 Covering the stove canister with a gasket

To prevent the evaporation of denatured alcohol the burners are covered with rubber gaskets, when the stove is not to be used for a long period.

- Ensure the stove is cooled down to room temperature.
- Pull the lower edge of the stovetop slightly forward while simultaneously pressing the catch (fig. **7**, page 5).
- Lift the stovetop.
- Place the gasket over the canister opening.
- Close the stovetop.
- ✓ The catch locks.



Note

Remove the gaskets before using the stove.

9 Cleaning and maintaining the stove



Caution

Do not use any sharp or hard objects for cleaning since they may damage the device.

- Remove the grate from the stovetop. Therefore slide the retainer off the hole and lift the grate (fig. **13**, page 7).
- Clean the stovetop. In particular remove carefully sticky grease and oil.
- **6000**: Clean the oven. In particular remove carefully sticky grease and oil.





Guarantee

Dometic ORIGO

10 Guarantee

The statutory warranty period applies. If the product is defective, please contact the manufacturer's branch in your country (see the back of the instruction manual for the addresses) or your retailer.

For repair and guarantee processing, please include the following documents when you send in the device:

- A copy of the receipt with purchasing date
- A reason for the claim or description of the fault

11 Disposal

- Place the packaging material in the appropriate recycling waste bins wherever possible.



If you wish to finally dispose of the device, ask your local recycling centre or specialist dealer for details about how to do this in accordance with the applicable disposal regulations.



12 Technical data

	Dometic ORIGO stove	
	1500	3000
Item no.:	958140101	958140501
Number of burners:	1	2
Burning duration:	approx. 4.5 h	
Power of burner:	2000 W	
Cooking time for 1 l water:	10 min	
Canister capacity:	1.2 l	
Dimensions (W x D x H)/mm:	236 x 137 x 262	464 x 137 x 262
Dimensions including gimbals (W x D x H)/mm:	282 x 228 x 262	510 x 228 x 262
Weight:	3.4 kg	6.3 kg





Dometic ORIGO

Technical data

	Dometic ORIGO oven		
	6000	6100	6200
Item no.:	958145001	958145010	958145020
Number of burners:	2 + 1	1	1
Burning duration:	approx. 4.5 h	approx. 4.5 h	approx. 4.5 h
Power of burner:	2000 W	–	–
Power of oven:	1500 W	1500 W	1500 W
Cooking time for 1 l water:	10 min	–	–
Canister capacity:	1.2 l	1.2 l	1.2 l
Dimensions (W x D x H)/mm:	465 x 562 x 335	510 x 554 x 335	465 x 335 x 562
Dimensions including gimbals (W x D x H)/mm:	510 x 562 x 335	–	–
Weight:	28.8 kg	22.5 kg	24 kg

Variations, technical improvements and delivery options reserved.

