

9.2.3 Seawater pump Inspection

(Refer to 2.2.4(5).)

- (1) Inspect the rubber impeller, checking for splitting around the outside, damage or cracks, and replace if necessary.

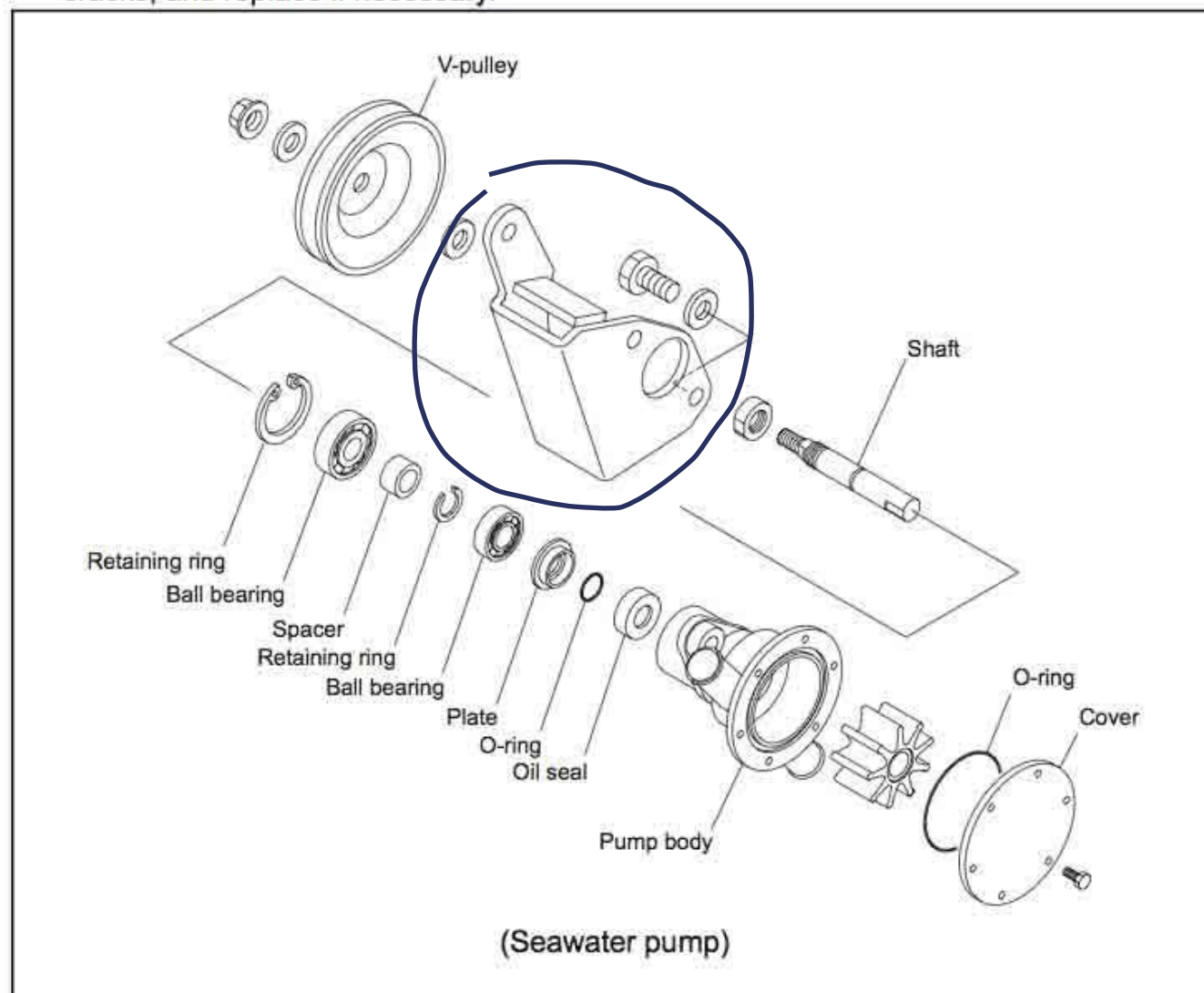

- (2) Inspect the oil seal and replace if it is damaged. Also replace the oil seal if there is considerable water leakage during operation.

Cooling water leakage	less than 3 cm ³ /h
-----------------------	--------------------------------

- (3) Make sure the ball bearings rotate smoothly. Replace if there is excessive play.