

Australian Yacht Winch (Sales) Pty. Ltd.  
4 NARENS Place  
ST. Mary's, N.S.W. 2760 Australia  
ATTN: Allen Hutton  
Tel + 612 96233448  
Web: www.huttonwinches.com  
Email: winches@attglobal.net

**MAXWELL**

Quality Winches & Marine Equipment

MAXWELL MARINE, INC.

629 Terminal Way, Suite 27  
Costa Mesa, California 92627  
(714) 631-2634 • TELEX 704153 WIN UD  
FAX 714-631-2846

MAXWELL MARINE LTD.

P.O. Box 33-401  
Takapuna, Auckland 9, New Zealand  
Tel. 444-7396 • TELEX NZ 60030  
FAX 64-9-444-0090

**MAXWELL**  
PARTS MANUAL

# MAXWELL 16P 16BP 16CP 16CP

One-speed Direct drive — Ratcheting

MODEL	FINISH	PRODUCT CODE
16AP	Alloy	51164/A
16BP	Bronze	51165/B
16CP	Chrome	51166/C

ITEM	PART No	DESCRIPTION	QTY
1	E178	Lock Screw	1
2	D166	Drive Boss	1
3	E179	Lock Spring	1
4	E271	Spring	4
5	E272	Pawl	4
6	D398	Cap	1
7	C161/2"	Drum	1
8	D165	Pedestal	1

\*Designate /A for Aluminum or /B for Bronze or /C for Chrome

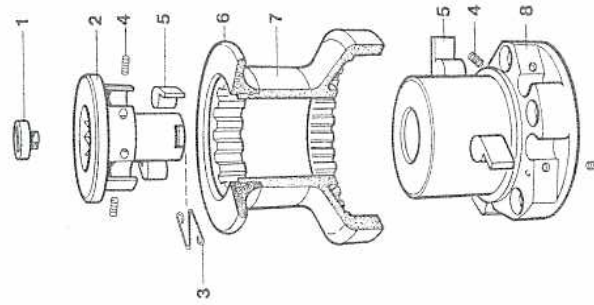

View on end of item 2  
showing item 3 in position  
assembled with item 1

**1** Insert screwdriver in slot of Quik-Loc™ mechanism and rotate 1/4 turn anti-clockwise.

**2** Lift drive boss and drum from pedestal. Remove drive boss, pawls and springs.

**3** Thoroughly clean all parts with kerosene (paraffin) and dry with a clean, non-fluffy cloth. Make sure springs, pawls and ratchet are in good condition.

**4** Lightly grease bearing areas, pawls, springs and ratchet teeth.

**5** Check action of pawls against springs. Re-fit drum and drive boss, checking engagement of pawls.

**6** Test action. Using screwdriver, turn Quik-Loc™ anti-clockwise until it snaps into lock position.

**7** Re-assemble with pawls in stations marked "C" for clockwise rotation of drum. Unmarked stations for anti-clockwise rotation.

# MAXWELL 14A 14B 14C 14C MK1

One-speed Direct drive — Ratcheting

MODEL	FINISH	PRODUCT CODE
14A Mk 1	Alloy	51144/A
14B Mk 1	Bronze	51145/B
14C Mk 1	Chrome	51146/C

ITEM	PART No.	DESCRIPTION	QTY
1	E167	Retaining Screw	1
2	D168	Drive Boss	1
3	E271	Spring	4
4	E272	Pawl	4
5	E291	Thrust Washer	1
6	D145	Cap	1
7	D142/2*	Drum	1
8	147	Needle Roller Bearing	1
9	E143	Thrust Washer	1
10	D144/A	Pedestal	1

\*Designate /A for Aluminum or /B for Bronze or /C for Chrome

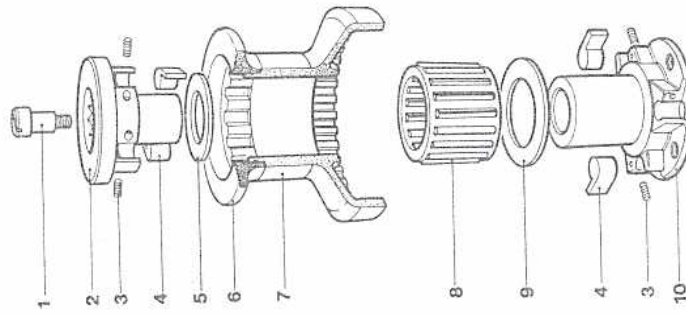

(b) Using screwdriver, turn Quik-Loc™ anti-clockwise until it snaps into lock position.

(c) Test action.

(c) Check action of pawls against springs.  
(d) Refit main thrust washer, bearing and top thrust washer.  
(e) Refit drum and drive boss, checking engagement of pawls.

4 (a) Lightly grease thrust washers, needle roller bearings, pawls and springs, ratchet teeth and drive boss bearing.  
(b) Re-assemble with pawls in stations marked "C" for clockwise rotation of drum. Unmarked stations for anti-clockwise rotation.



3 Remove and thoroughly clean all parts with kerosene (paraffin) and dry with a clean, non-fluffy cloth. Make sure all parts are in good condition.



2 Lift drive boss and drum from pedestal.



1 Insert screw driver in slot of Quik-Loc™ mechanism and rotate 1/4 turn anti-clockwise.





# MAXWELL 17A

## One-Speed Geared — Ratcheting

MODEL	FINISH	PRODUCT CODE
17A	Alloy	53174

  

ITEM	PART No.	DESCRIPTION	QTY
1	E423	Retaining Cap	1
2	D427	Cap	1
3	G201/2A	Drum	1
4	E103	Bearing Outer Race	1
5	E107	Needle Roller Bearing	1
6	E104	Bearing Inner Race	1
7	E395	Thrust Washer	1
8	D174	Drive Shaft	1
9	E291	Thrust Washer	1
10	E171	Bush	1
11	E274	Cheese Head Screw	3
12	G172	Pedestal	1
13	E233	Shaft — Idler Gear	1
14	E236	11 Tooth Idler Gear	1
15	E268	Bush	1
16	E219	Clutch — Anticlockwise	2
17	E271	Spring	8
18	E439	Bush (Assembled with E173)	1
19	E173	19 Tooth Clutch Gear	1
20	E216	Clutch — Clockwise	2
21	SP506	Helix-Coil Insert	3
22	E438	Bush	1
23	C176	Base	1

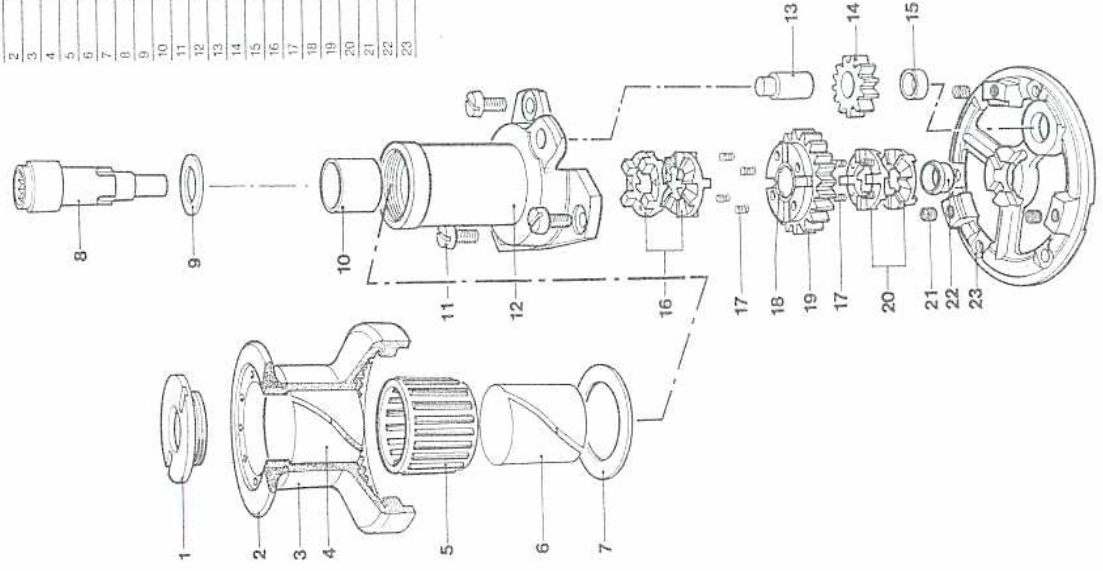

- Remove retaining cap — tap undone in anti-clockwise direction.
- Lift drum.
- Extract drive shaft and thrust washer (use lock-in handle). Remove needle roller bearing, thrust washer, stainless steel bearing race and on Ultra-tight models — bearing race from bore of drum.
- Undo 3 cheese head screws, removing pedestal, gears, clutch sets with springs (8 off), from base.
- Thoroughly clean all parts with kerosene (paraffin). Take care to remove any salt build up and bearing races including mating faces on drum and on pedestal. Dry parts with non-fluffy cloth. Check condition of parts for wear or damage. Replace if necessary.
- Spray inside drum, base and pedestal with CRC6-65 or WD40 and replace bearing race(s) making sure they are properly seated.
- Lightly grease gears — teeth and bores, clutches, drive shaft, thrust washers and needle roller bearing.
- Position idler gear, replace pedestal and tighten down firmly.
- Place thrust washer in top of pedestal and fit drive shaft checking alignment to engage dogs on clutch. Test action.
- Fit thrust washer, main bearing and drum.
- Lightly grease thread and underside of retaining cap, refit, tighten firmly, and test action.



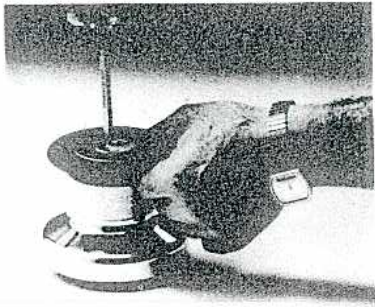

**1** Insert screwdriver in slot of Quik-Loc™ mechanism and rotate 1/4 turn anti-clockwise.



**2** Lift drive boss and drum from pedestal.



**3** Remove needle roller bearing, two thrust washers, pawls and springs (4 sets), stainless steel bearing race and on Ultra-light models — bearing race from bore of drum.



**4** Thoroughly clean all parts with kerosene (paraffin). Take care to remove any salt build up and crusting from surfaces of bearing races and mating faces in drum and on pedestal.



**5** (a) Spray pedestal and inside drum with CRC6-66 or WD40 and replace bearing race(s), making sure they are properly seated.

(b) Lightly grease thrust washers, needle roller bearing, pawls and springs, ratchet teeth and drive boss bearing.

(c) Re-assemble with pawls in stations marked "C" for clockwise rotation of drum. Unmarked stations for anti-clockwise rotation.

(d) Check action of pawls against springs. Refit main thrust washer, bearing and top thrust washer.

(e) Refit drum and drive boss checking engagement of pawls. Using screwdriver, turn Quik-Loc™ anti-clockwise until it snaps into lock position.

(f) Test action.

## MAXWELL 17B 17C

One-speed Geared — Ratcheting

MODEL	FINISH	PRODUCT CODE
17B	Bronze	53752/J
17C	Chrome	53756/C

ITEM	PART No	DESCRIPTION	QTY
1	E423	Retaining Cap	1
2	D427	Cap	1
3	C201/2*	Drum	1
4	E187	Needle Roller Bearing	1
5	E184	Bearing Inner Race	1
6	E395	Thrust Washer	1
7	D174	Drive Shaft	1
8	E391	Thrust Washer	1
9	E171	Bush	1
10	E274	Chesse Head Screw	3
11	C172	Pedestal	1
12	E293	Shaft — Idle Gear	1
13	E295	11 Tooth Idle Gear	1
14	E298	Bush	1
15	E219	Clutch — Anticlockwise	2
16	E271	Spring	8
17	E439	Bush (Assembled with E173)	1
18	E173	18 Tooth Clutch Gear	1
19	E218	Clutch — Clockwise	2
20	SP586	Helix-Coil Insert	3
21	E438	Bush	1
22	C176	Base	1

\*Designate /B for Bronze or /C for Chrome

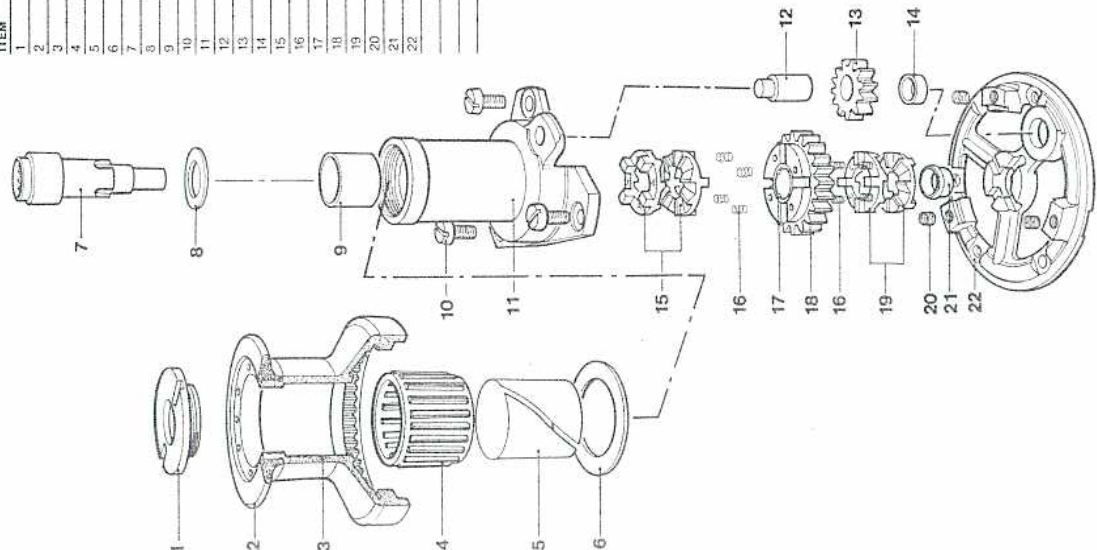

Drawing Number  
**C 100024**  
© Maxwell 1986

# MAXWELL 18A

One-speed Direct drive — Ratcheting

MODEL	FINISH	PRODUCT CODE
18A	Alloy	51184

ITEM	PART No.	DESCRIPTION	QTY
1	E178	Lock Screw	1
2	D166	Drive Boss	1
3	E179	Lock Spring	1
4	E271	Spring	4
5	E272	Pawl	4
6	D401	Cap	1
7	D181/2A	Drum	1
8	E163	Bearing Outer Race	1
9	207	Needle Roller Bearing	1
10	E164	Bearing Inner Race	1
11	E395	Thrust Washer	1
12	C182/2	Pedestal	1

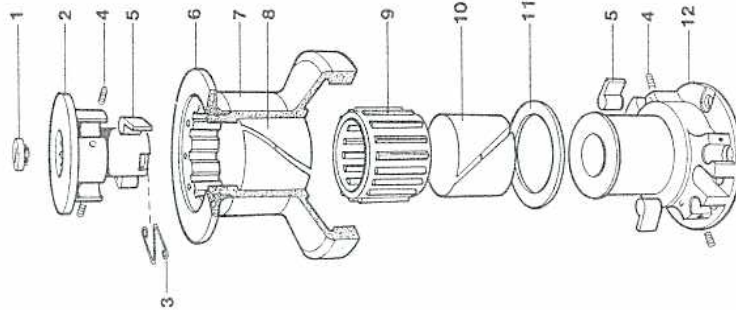

View on end of item 2  
showing item 3 in position  
assembled with item 1



Drawing Number  
**C 100029**  
© Copyright 1985

# MAXWELL 18B 18C

One-speed Direct drive — Ratcheting

MODEL	FINISH	PRODUCT CODE
18B	Bronze	51185/B
18C	Chrome	51186/C

ITEM	PART No.	DESCRIPTION	QTY
1	E178	Lock Screw	1
2	D166	Drive Boss	1
3	E179	Lock Spring	1
4	E271	Spring	4
5	E272	Pawl	4
6	D401	Cap	1
7	D181/2*	Drum	1
8	207	Needle Roller Bearing	1
9	E164	Bearing Inner Race	1
10	E395	Thrust Washer	1
11	C182/2	Pedestal	1

\*Designate /B for Bronze or  
/C for Chrome

View on end of item 2  
showing item 3 in position  
assembled with item 1



Drawing Number  
**C 100030**  
© Copyright 1985



## One-speed Direct drive — Ratcheting

**MAXWELL** 18BH One-speed Bottom handle — Ratcheting

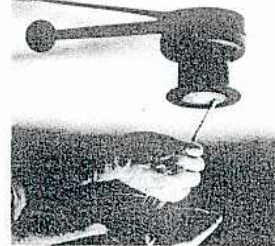

- Remove retaining cap — tap undone in anti-clockwise direction.



- Spray inside base, drum and pedestal with CRC6-66 or WD40 and replace bearing race(s) making sure they are properly seated.





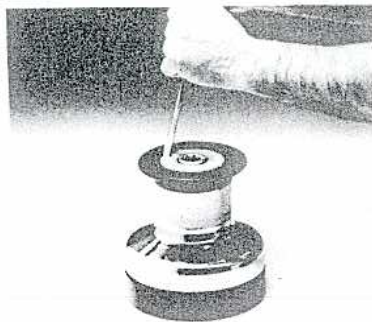

1 Remove retaining cap — tap undone in anti-clockwise direction.



2 Lift drum.

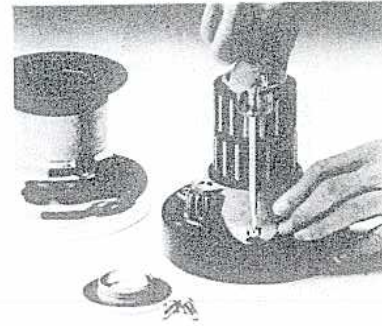

3 Undo cheese head screws — 3 off on models 20 through 27, 4 off on models 28 and 29.



4 Lift pedestal from base.



5 (a) Remove all parts by hand including drive shaft, bearings and stainless steel bearing races from inside top and bottom of pedestal (Models 22 through 29 only).  
(b) Also remove stainless steel bearing race on pedestal main bearing.

(c) On Ultra-light models, also remove bearing race from bore on drum.

(d) On models 26 through 29, idler gear needle roller bearing should also be removed.

## MAXWELL 18BHB 18BHC

One-speed Bottom handle — Ratcheting

MODEL	FINISH	PRODUCT CODE
18BHB	Bronze	54185/B
18BHC	Chrome	54186/C

ITEM	PART No	DESCRIPTION	QTY
1	E422	Retaining Cap	1
2	D401	Cap	1
3	D181/2"	Drum	1
4	207	Needle Roller Bearing	1
5	E164	Bearing Inner Race	1
6	E395	Thrust Washer	3
7	E274	Cheese Head Screw	1
8	C185	Pedestal	2
9	E272	Pin	2
10	E271	Spring	2
11	E268	Bush	2
12	E280	Thrust Washer	2
13	E180	Handle Pivot Pin	1
14	SP19	Pan Head Screw	1
15	E153	Ratchet Block	1
16	E210	Pin	2
17	D158/A	Handle	1
18	E157	Knob	1
19	SP20	Screw	1
20	SP590	Helix-Coil Insert	3
21	C186	Base	1

\*Designate /B for Bronze or /C for Chrome

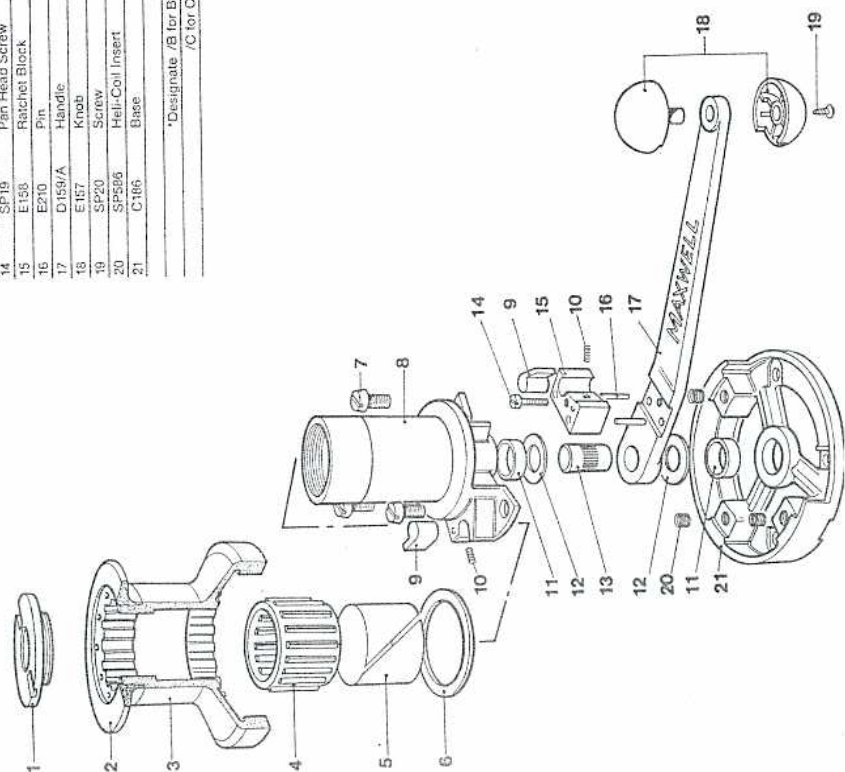

Drawing Number  
**C100032**  
© Maxwell 1981

# MAXWELL 20A

Two-speed Geared

MODEL	FINISH	PRODUCT CODE	
20A	Alloy	55204	
ITEM	PART No.	DESCRIPTION	QTY
1	E423	Retaining Cap	1
2	D399	Cap	1
3	C201/2A	Drum	1
4	E183	Bearing Outer Race	1
5	E187	Needle Roller Bearing	1
6	E184	Bearing Inner Race	1
7	E395	Thrust Washer	1
8	D213	Drive Shaft	1
9	E291	Thrust Washer	2
10	E171	Bush	2
11	C202/2	Pedestal	1
12	E274	Cheese Head Screw	3
13	E331	Shaft-Driven Gear Cluster	1
14	E237	12 Tooth Clutch Gear	1
15	E219	Clutch — Anti Clockwise	2
16	E271	Spring	8
17	E214	11 Tooth Clutch Gear	1
18	E239	Shaft — Idler Gear	1
19	E246	11 Tooth Idler Gear	1
20	E212	20 Tooth Clutch Gear	1
21	E218	Clutch — Clockwise	2
22	E211	15 Tooth Clutch Gear — Splined	1
23	E286	Bush	1
24	SP556	Helix-Coil Inset	3
25	C306/2	Base	1

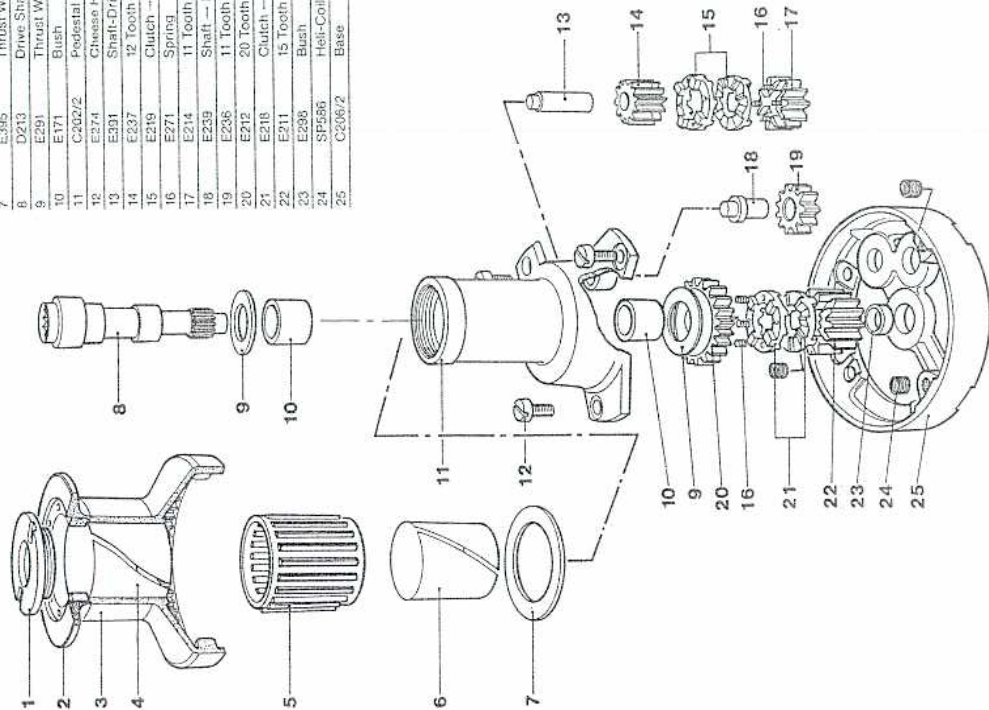

10 Test action.

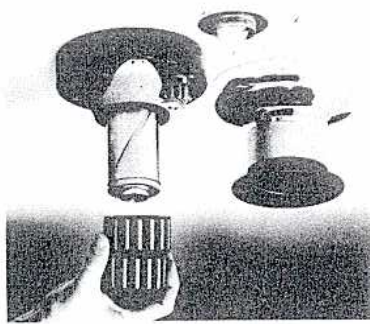

9 (a) Fit thrust washer, main bearing(s) and drum.

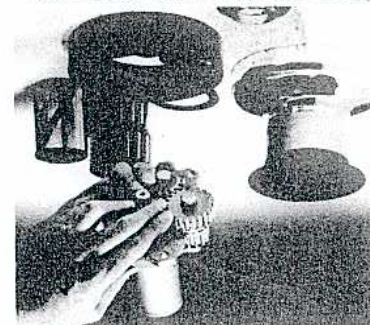

8 (a) Re-assemble parts into pedestal with clutches marked "C" on central shaft for clockwise rotation. For anti-clockwise rotation, assemble clutches marked "A" on central shaft.

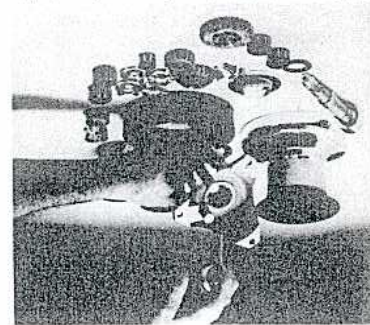

7 (a) Spray inside drum, base and pedestal with CRC6-66 or WD40 and replace bearing race(s) making sure they are properly seated. (b) Lightly grease gears — teeth and bores, clutches, drive shaft, thrust washers and needle roller bearings.

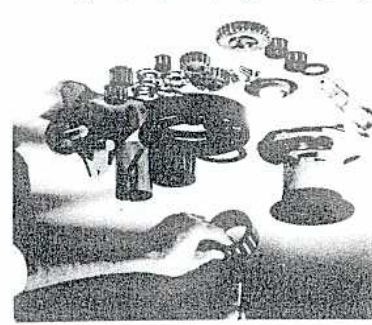

6 (a) Thoroughly clean all parts with kerosene (paraffin). Take care to remove any salt build up and crusting from faces of bearing races including mating surfaces on drum and pedestal. (b) Dry parts with non-fluffy cloth. (c) Check condition of parts for wear or damage and replace if necessary.

(b) Hold gearing on pedestal, turn pedestal over and align output gear with base and lower pedestal into place. (c) Replace screws and tighten down firmly.

(b) Lightly grease thread and underside of retaining cap, refit and tighten firmly.



# MAXWELL 20B 20C

Two-speed Geared

MODEL	FINISH	PRODUCT CODE
20B	Bronze	55205/B
20C	Chrome	55206/C

ITEM	PART No.	DESCRIPTION	QTY
1	E423	Retaining Cap	1
2	D399	Cap	1
3	C201/2*	Drum	1
4	187	Needle Roller Bearing	1
5	E184	Bearing Inner Race	1
6	E395	Thrust Washer	1
7	D213	Drive Shaft	2
8	E291	Thrust Washer	2
9	E171	Bush	2
10	C202/2	Pedestal	1
11	E274	Chesse Head Screw	3
12	E391	Shaft-Driven Gear Cluster	1
13	E237	12 Tooth Clutch Gear	1
14	E219	Clutch — Anti Clockwise	2
15	E271	Spring	8
16	E214	11 Tooth Clutch Gear	1
17	E239	Shaft — Idler Gear	1
18	E236	11 Tooth Idler Gear	1
19	E212	20 Tooth Clutch Gear	1
20	E218	Clutch — Clockwise	2
21	E211	15 Tooth Clutch Gear — Splined	1
22	E288	Bush	1
23	SP566	Helix-Coil Insert	3
24	C205/2	Base	1

\*Designate /B for Bronze or /C for Chrome

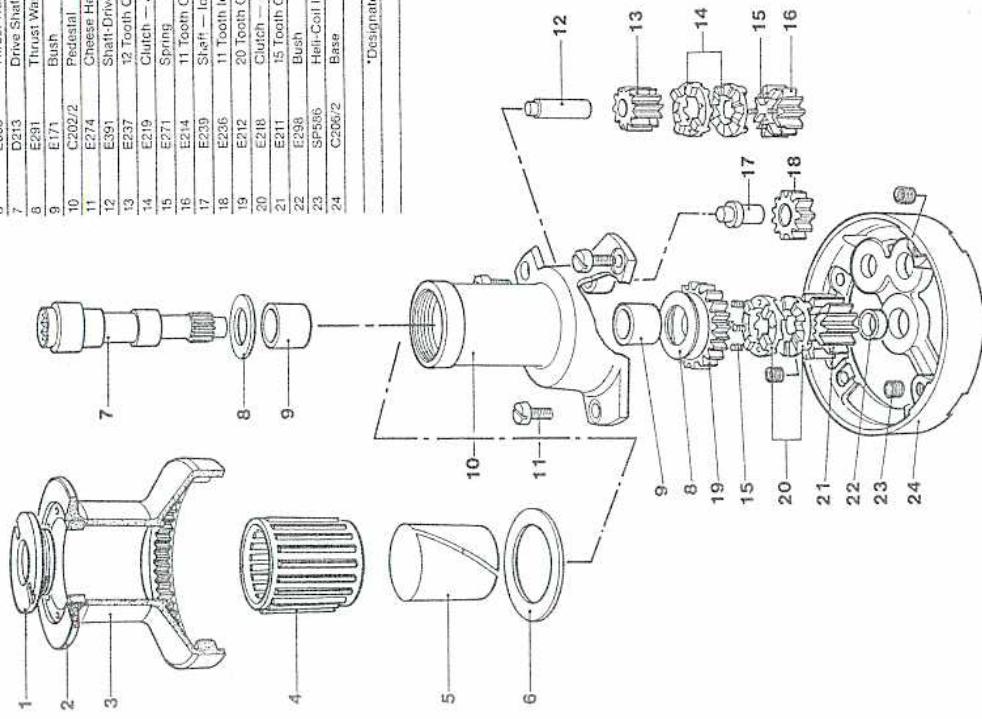

Drawing Number  
C 100038  
©Copyright 1995

# MAXWELL 21A

Two-speed Geared

MODEL	FINISH	PRODUCT CODE
21A	Alloy	55214

ITEM	PART No.	DESCRIPTION	QTY
1	E423	Retaining Cap	1
2	D400	Cap	1
3	C201/2A	Drum	1
4	E183	Bearing Outer Race	1
5	187	Needle Roller Bearing	1
6	E184	Bearing Inner Race	1
7	E395	Thrust Washer	1
8	D213	Drive Shaft	1
9	E291	Thrust Washer	2
10	E171	Bush	2
11	C202/2	Pedestal	1
12	E274	Chesse Head Screw	3
13	E391	Shaft-Driven Gear Cluster	1
14	E214	11 Tooth Clutch Gear	1
15	E219	Clutch — Anticlockwise	2
16	E271	Spring	8
17	E237	12 Tooth Clutch Gear	1
18	E239	Shaft — Idler Gear	1
19	E236	11 Tooth Idler Gear	1
20	E212	20 Tooth Clutch Gear	1
21	E218	Clutch — Clockwise	2
22	E215	14 Tooth Clutch Gear Splined	1
23	E288	Bush	1
24	SP566	Helix-Coil Insert	3
25	C206/2	Base	1

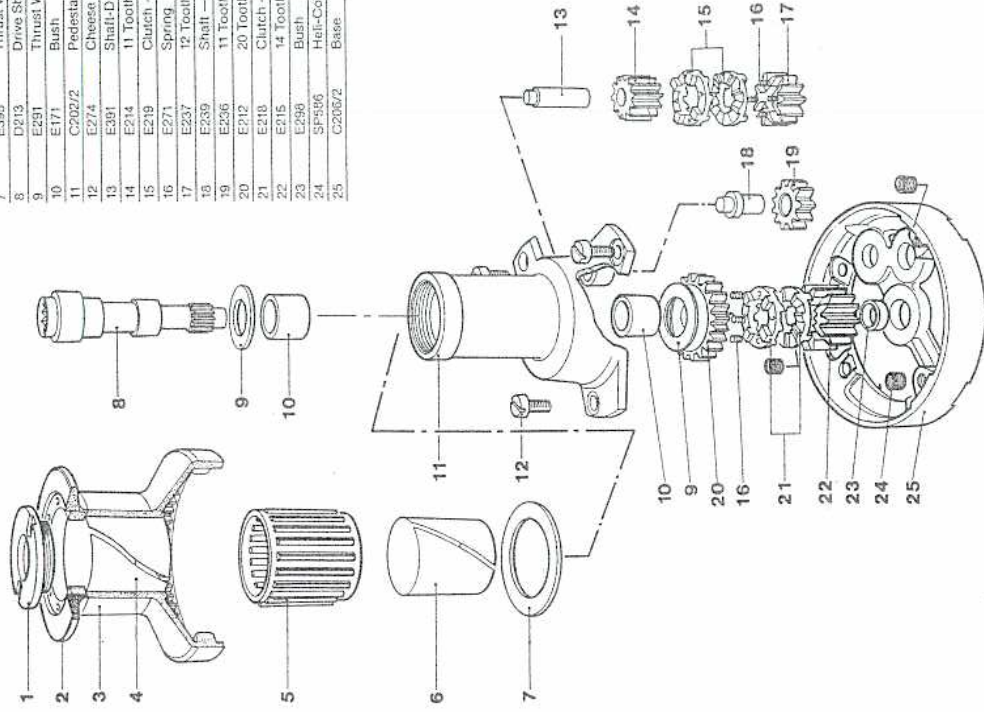

Drawing Number  
C 100041  
©Copyright 1995

# MAXWELL 21B 21C

Two-speed Geared

MODEL	FINISH	PRODUCT CODE
21B	Bronze	55215/B
21C	Chrome	55216/C

ITEM	PART No.	DESCRIPTION	QTY
1	E423	Retaining Cap	1
2	D400	Cap	1
3	C201/2*	Drum	1
4	E187	Needle Roller Bearing	1
5	E184	Bearing Inner Race	1
6	E395	Thrust Washer	1
7	D213	Drive Shaft	1
8	E291	Thrust Washer	2
9	E171	Bush	2
10	C202/2	Pedestal	1
11	E274	Cheese Head Screw	3
12	E301	Shift-Driven Gear Cluster	1
13	E214	11 Tooth Clutch Gear	1
14	E219	Clutch — Anticlockwise	2
15	E271	Spring	8
16	E237	12 Tooth Clutch Gear	1
17	E239	Shaft — Idler Gear	1
18	E236	11 Tooth Idler Gear	1
19	E212	20 Tooth Clutch Gear	1
20	E218	Clutch — Clockwise	2
21	E215	14 Tooth Clutch Gear Splined	1
22	E280	Bush	1
23	SP596	Helix-Coil Insert	3
24	C206/2	Base	1

\*Designate /B for Bronze or /C for Chrome

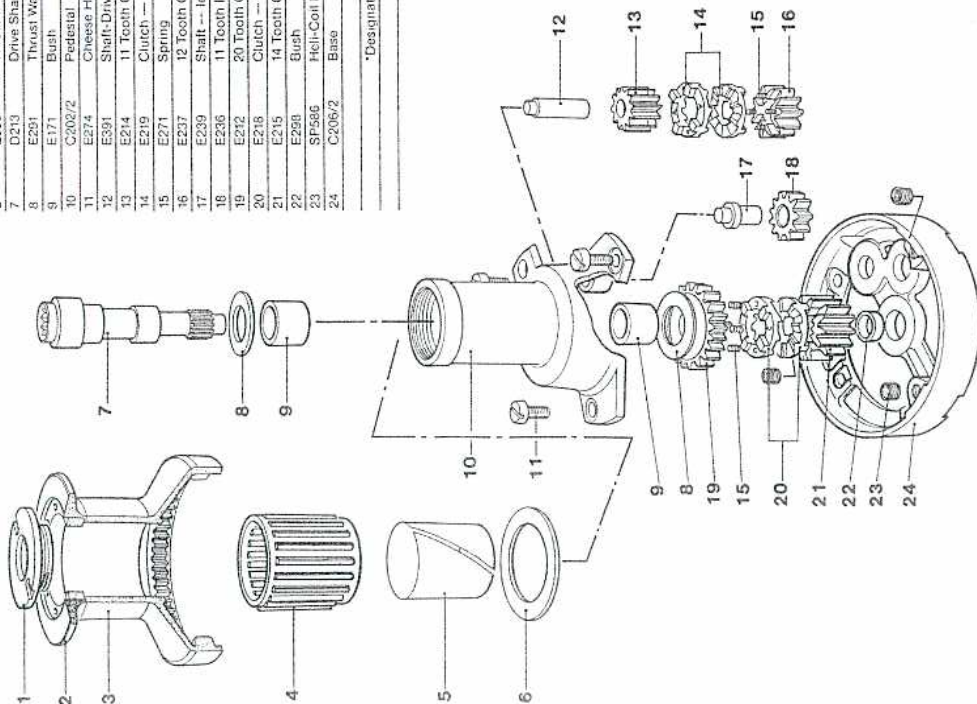

Drawing Number  
C 100042

# MAXWELL 22A

Two-speed Geared

MODEL	FINISH	PRODUCT CODE
22A	Alloy	55224

ITEM	PART No.	DESCRIPTION	QTY
1	E423	Retaining Cap	1
2	D402	Cap	1
3	C221/2A	Drum	1
4	E183	Bearing Outer Race	1
5	E187	Needle Roller Bearing	1
6	E184	Bearing Inner Race	1
7	E395	Thrust Washer	1
8	D233	Drive Shaft	1
9	E291	Thrust Washer	2
10	E247	Needle Roller Bearing	2
11	E229	Bearing Outer Race	2
12	C222/2	Pedestal	1
13	E274	Cheese Head Screw	3
14	E391	Shift-Driven Gear Cluster	1
15	E237	12 Tooth Clutch Gear	1
16	E219	Clutch — Anticlockwise	2
17	E271	Spring	8
18	E232	14 Tooth Clutch Gear	1
19	E239	Shaft — Idler Gear	1
20	E236	11 Tooth Idler Gear	1
21	E234	22 Tooth Clutch Gear	1
22	E218	Clutch — Clockwise	2
23	E231	12 Tooth — Clutch Gear — Splined	1
24	E288	Bush	1
25	SP596	Helix-Coil Insert	3
26	C226/2	Base	1

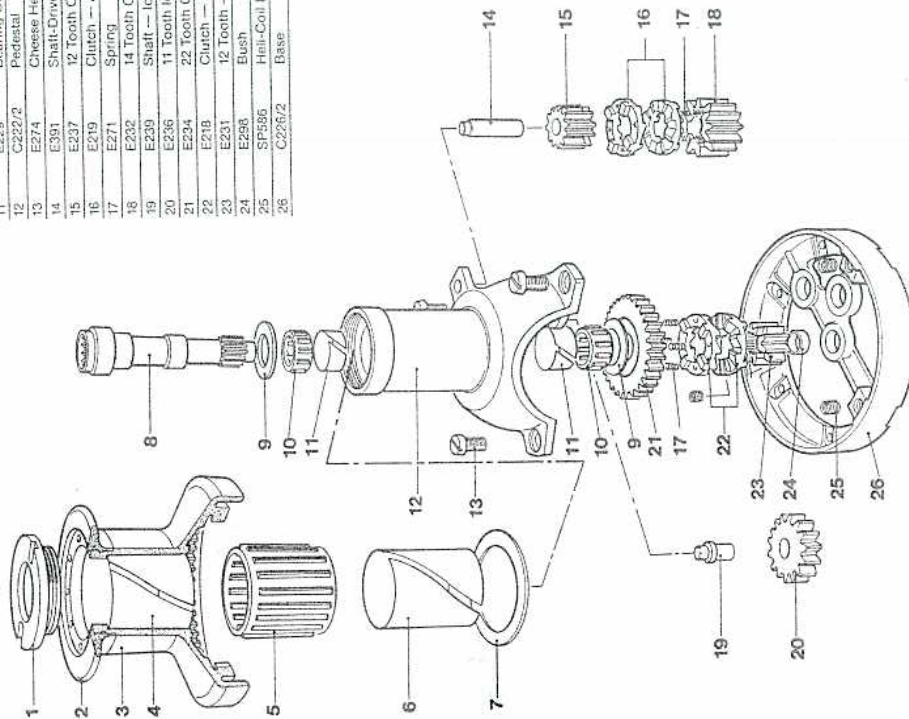

Drawing Number  
C 100047



# MAXWELL 22B 22C

Two-speed Geared

MODEL	FINISH	PRODUCT CODE
22B	Bronze	55225/B
22C	Chrome	55226/C

ITEM	PART No.	DESCRIPTION	QTY
1	E423	Retaining Cup	1
2	D403	Cap	1
3	C221/2*	Drum	1
4	E187	Needle Roller Bearing	1
5	E184	Bearing Inner Race	1
6	E395	Thrust Washer	1
7	D233	Drive Shaft	1
8	E291	Thrust Washer	2
9	E229	Needle Roller Bearing	2
10	E229	Bearing Outer Race	2
11	C222/2	Pedestal	1
12	E274	Cheese Head Screw	3
13	E239	Shaft — Idle Gear	1
14	E236	11 Tooth Idle Gear	1
15	E391	Shaft-Driven Gear Cluster	1
16	E237	12 Tooth Clutch Gear	1
17	E219	Clutch — Anticlockwise	2
18	E271	Spring	8
19	C232	14 Tooth Clutch Gear	1
20	E234	22 Tooth Clutch Gear	1
21	E218	Clutch — Clockwise	2
22	E231	12 Tooth Clutch Gear Spined	1
23	E236	Bush	1
24	SP586	Helix-Coil Insert	3
25	C226/2	Base	1

\*Designate /B for Bronze or /C for Chrome

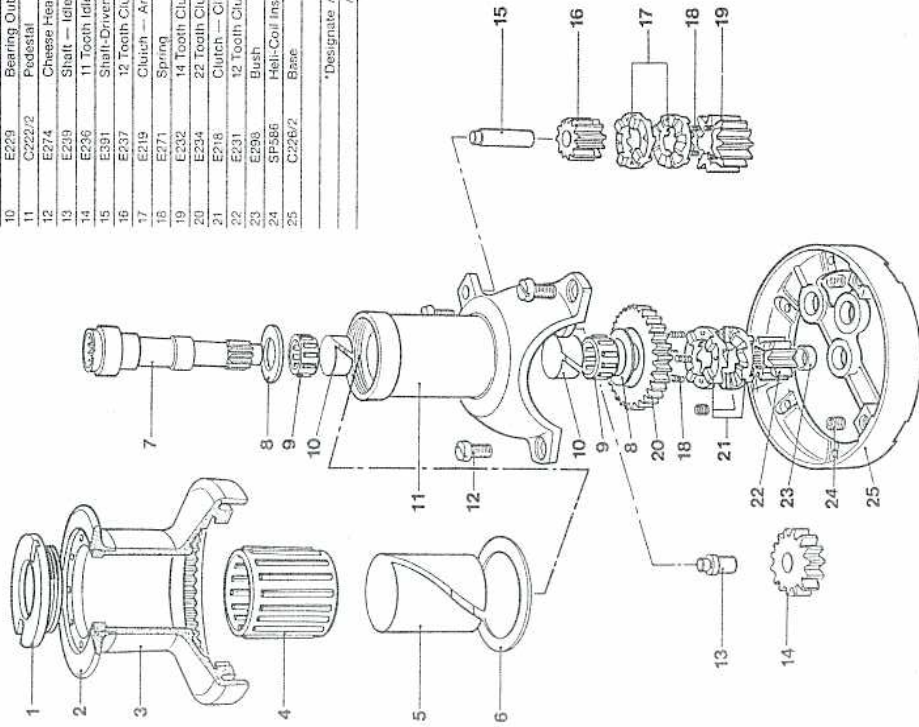

Drawing Number  
C 100048

# MAXWELL 23A

Two-speed Geared

MODEL	FINISH	PRODUCT CODE
23A	Alloy	5523A

ITEM	PART No.	DESCRIPTION	QTY
1	E423	Retaining Cup	1
2	D403	Cap	1
3	C221/2A	Drum	1
4	E187	Bearing Outer Race	1
5	E184	Bearing Inner Race	1
6	E395	Thrust Washer	1
7	E233	Drive Shaft	1
8	E291	Thrust Washer	2
9	E229	Needle Roller Bearing	2
10	E229	Bearing Outer Race	2
11	C222/2	Pedestal	1
12	E274	Cheese Head Screw	3
13	E391	Shaft-Driven Gear Cluster	1
14	E237	12 Tooth Clutch Gear	1
15	E219	Clutch — Anticlockwise	2
16	E271	Spring	8
17	E236	15 Tooth Clutch Gear	1
18	E239	Shaft — Idle Gear	1
19	E234	22 Tooth Clutch Gear	1
20	E218	Clutch — Clockwise	2
21	E235	11 Tooth — Clutch Gear — Spined	1
22	SP586	Helix-Coil Insert	3
23	C226/2	Base	1

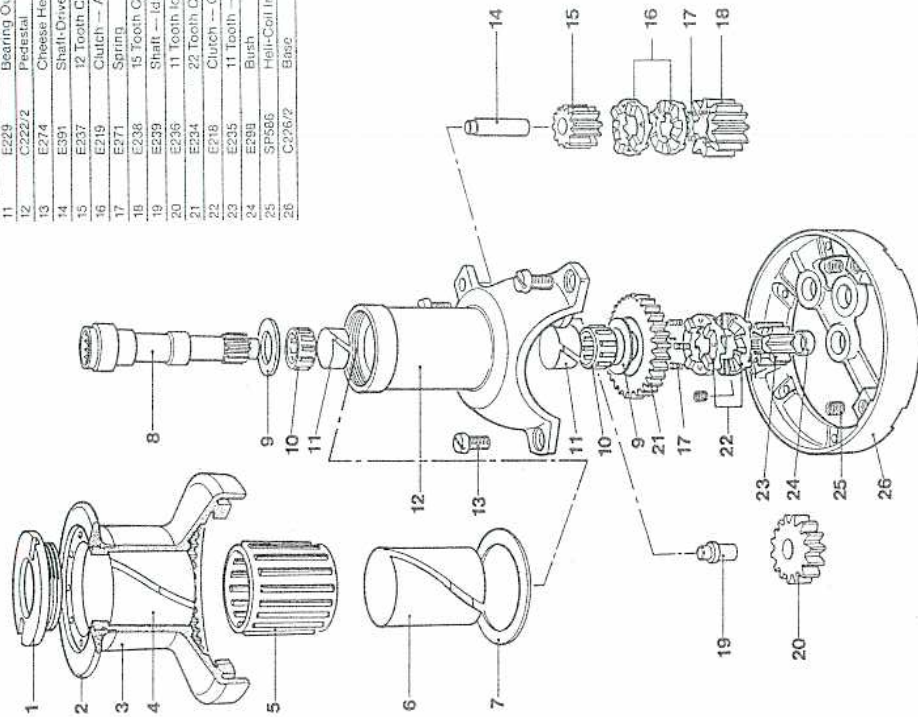

Drawing Number  
C 100051

# MAXWELL 23B 23C

Two-speed Geared

MODEL	FINISH	PRODUCT CODE
23B	Bronze	55235/B
23C	Chrome	55236/C

ITEM	PART No	DESCRIPTION	QTY
1	E423	Retaining Cap	1
2	D403	Cap	1
3	C221/2*	Drum	1
4	E187	Needle Roller Bearing	1
5	E184	Bearing Inner Race	1
6	E395	Thrust Washer	1
7	D233	Drive Shaft	1
8	E291	Thrust Washer	2
9	247	Needle Roller Bearing	2
10	E299	Bearing Outer Race	2
11	C222/2	Pedestal	1
12	E274	Cheese Head Screw	3
13	E239	Shaft — Idle Gear	1
14	E236	11 Tooth Idle Gear	1
15	E391	Shaft-Driven Gear Cluster	1
16	E237	12 Tooth Clutch Gear	1
17	E237	Clutch — Anticlockwise	2
18	E219	Spring	8
19	E238	15 Tooth Clutch Gear	1
20	E234	22 Tooth Clutch Gear	1
21	E218	Clutch — Clockwise	2
22	E235	11 Tooth Clutch Gear — Splined	1
23	E238	Bush	1
24	SP586	Helix-Coil Insert	3
25	C228/2	Base	1

\*Designate /B for Bronze or /C for Chrome

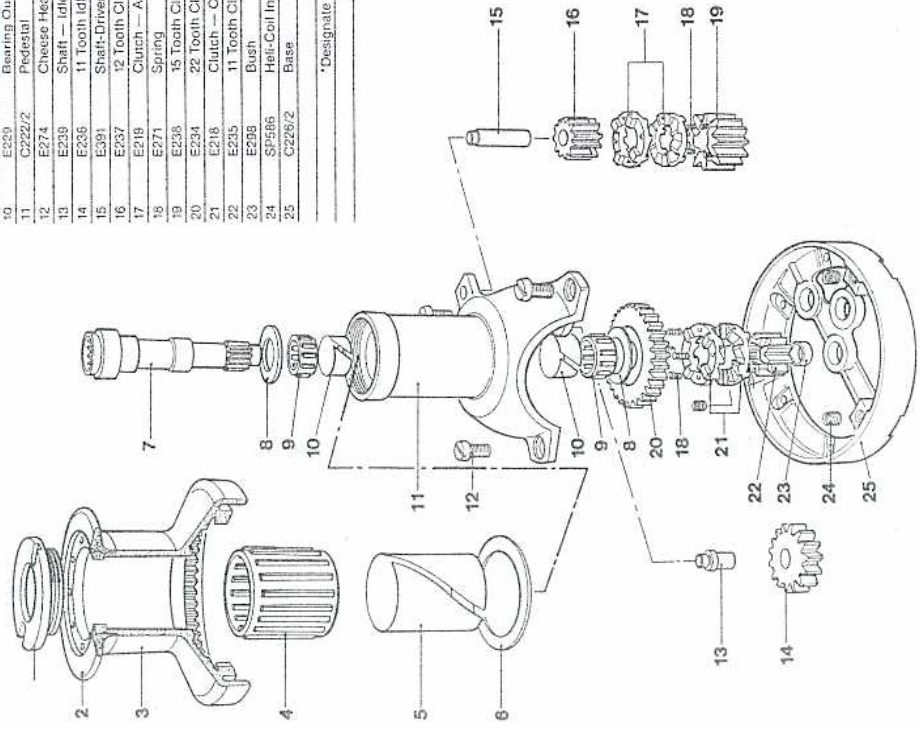

Drawing Number  
C 100052

# MAXWELL 24A

Two-speed Geared

MODEL	FINISH	PRODUCT CODE
24A	Alloy	55244

ITEM	PART No	DESCRIPTION	QTY
1	E423	Retaining Cap	1
2	D424	Cap	1
3	C241/2A	Drum	1
4	E183	Bearing Outer Race	1
5	187	Needle Roller Bearing	1
6	E184	Bearing Inner Race	1
7	E395	Thrust Washer	1
8	D244	Drive Shaft	1
9	E291	Thrust Washer	2
10	247	Needle Roller Bearing	2
11	E299	Bearing Outer Race	2
12	C242/2	Pedestal	1
13	E274	Cheese Head Screw	3
14	E391	Shaft-Driven Gear Cluster	1
15	E237	12 Tooth Clutch Gear	1
16	E219	Clutch — Anticlockwise	2
17	E271	Spring	8
18	E232	16 Tooth Clutch Gear	1
19	E239	Shaft — Idle Gear	1
20	E251	14 Tooth Idle Gear	1
21	E254	28 Tooth Clutch Gear	1
22	E218	Clutch — Clockwise	2
23	E235	11 Tooth Clutch Gear — Splined	1
24	E238	Bush	1
25	SP586	Helix-Coil Insert	3
26	C246/2	Base	1

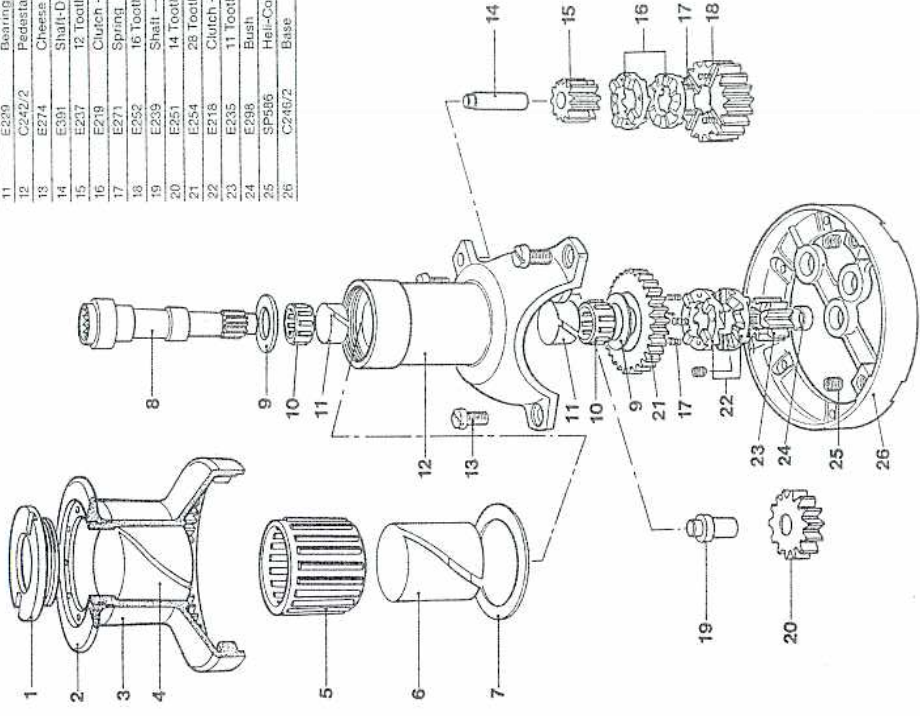

Drawing Number  
C 100057



# MAXWELL 24B 24C

Two-speed Geared

MODEL	FINISH	PRODUCT CODE
24B	Bronze	55245/B
24C	Chrome	55246/C

ITEM	PART No	DESCRIPTION	QTY
1	E423	Retaining Cap	1
2	D424	Cap	1
3	C241/2*	Drum	1
4	187	Needle Roller Bearing	1
5	E184	Bearing Inner Race	1
6	E395	Thrust Washer	2
7	D244	Drive Shaft	1
8	E291	Thrust Washer	2
9	247	Needle Roller Bearing	2
10	E229	Bearing Outer Race	2
11	C242/2	Pedestal	1
12	E274	Cheese Head Screw	3
13	E391	Shaft-Driven Gear Cluster	1
14	E237	12 Tooth Clutch Gear	1
15	E219	Clutch — Anticlockwise	2
16	E271	Spring	8
17	E252	16 Tooth Clutch Gear	1
18	E239	Shaft — Idle Gear	1
19	E251	14 Tooth Idle Gear	1
20	E254	28 Tooth Clutch Gear	1
21	E218	Clutch — Clockwise	2
22	E235	11 Tooth — Clutch Gear — Spined	1
23	E298	Bush	1
24	SP586	Helix-Coil Insert	3
25	C246/2	Base	1

\*Designate /B for Bronze or /C for Chrome

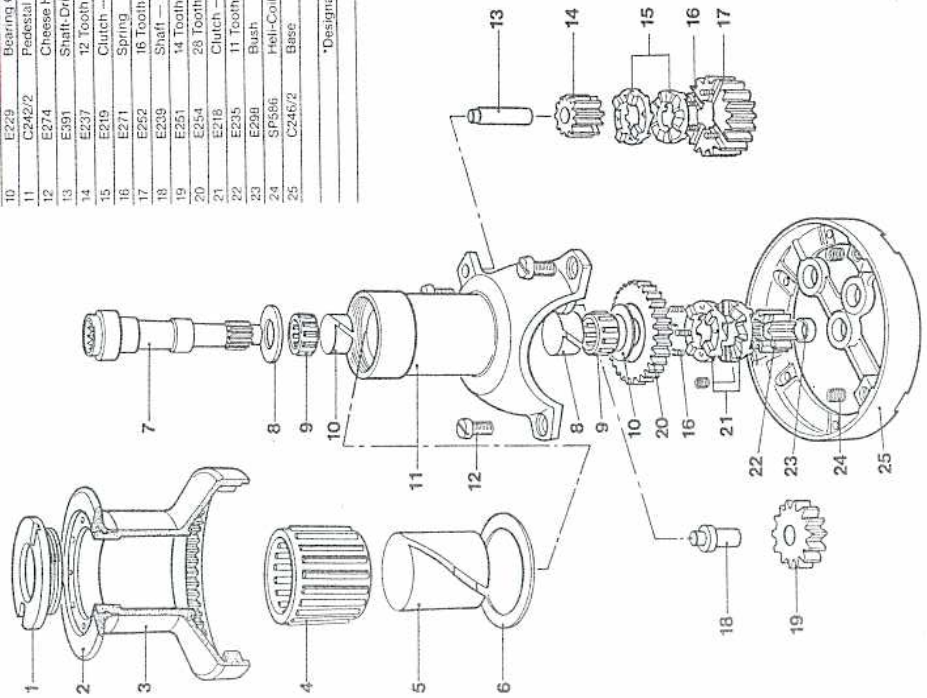

Drawing Number  
**C 100058**  
Copyright 1988

# MAXWELL 25A

Two-speed Geared

MODEL	FINISH	PRODUCT CODE
25A	Alloy	55254

ITEM	PART No	DESCRIPTION	QTY
1	E423	Retaining Cap	1
2	D424	Cap	1
3	C241/2A	Drum	1
4	E183	Bearing Outer Race	1
5	187	Needle Roller Bearing	1
6	E194	Bearing Inner Race	1
7	E395	Thrust Washer	1
8	D244	Drive Shaft	1
9	E291	Thrust Washer	2
10	247	Needle Roller Bearing	2
11	E229	Bearing Outer Race	2
12	C242/2	Pedestal	1
13	E274	Cheese Head Screw	3
14	E391	Shaft-Driven Gear Cluster	1
15	E214	11 Tooth Clutch Gear	1
16	E219	Clutch — Anticlockwise	2
17	E271	Spring	8
18	E252	16 Tooth Clutch Gear	1
19	E239	Shaft — Idle Gear	1
20	E251	14 Tooth Idle Gear	1
21	E254	28 Tooth Clutch Gear	1
22	E216	Clutch — Clockwise	2
23	E235	11 Tooth Clutch Gear — Spined	1
24	E298	Bush	1
25	SP586	Helix-Coil Insert	3
26	C246/2	Base	1

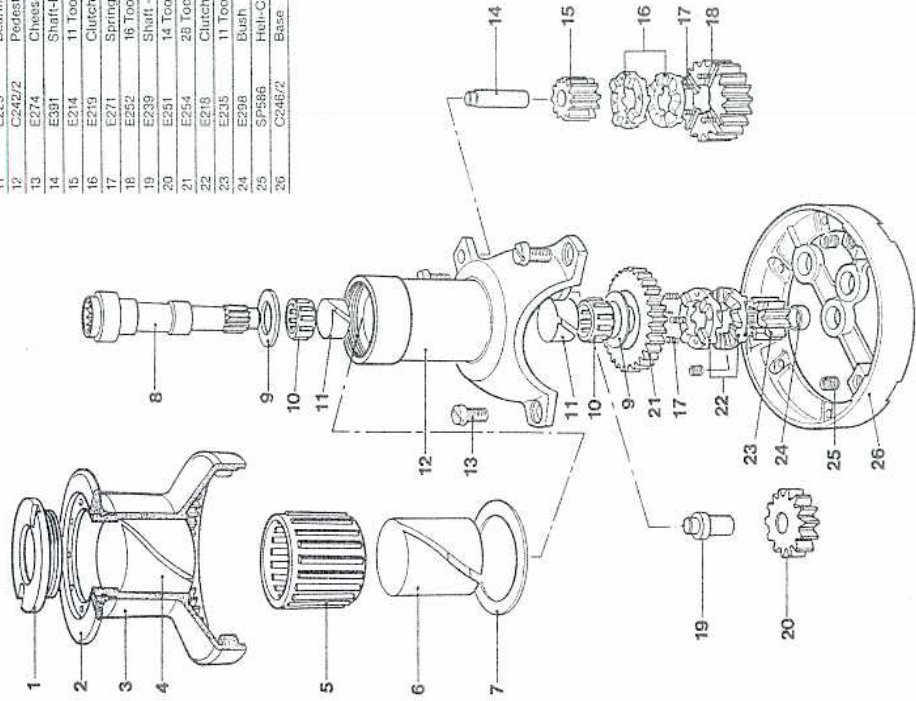

Drawing Number  
**C 100061**  
Copyright 1988

# MAXWELL 25B 25C

Two-speed Geared

MODEL	FINISH	PRODUCT CODE
25B	Bronze	55255/B
25C	Chrome	55255/C

ITEM	PART No	DESCRIPTION	QTY
1	E423	Retaining Cap	1
2	D424	Cap	1
3	C241/2*	Drum	1
4	187	Needle Roller Bearing	1
5	E184	Bearing Inner Race	1
6	E395	Thrust Washer	1
7	D244	Drive Shaft	1
8	E291	Thrust Washer	2
9	247	Needle Roller Bearing	2
10	E229	Bearing Outer Race	2
11	C242/2	Pedestal	1
12	E274	Cheese Head Screw	1
13	E391	Shaft-Driven Gear Cluster	3
14	E214	11 Tooth Clutch Gear	1
15	E219	Clutch — Anticlockwise	2
16	E271	Spring	8
17	E252	16 Tooth Clutch Gear	1
18	E239	Shaft — Idle Gear	1
19	E251	14 Tooth Idle Gear	1
20	E254	28 Tooth Clutch Gear	1
21	E218	Clutch — Clockwise	2
22	E235	11 Tooth Clutch Gear — Splined	1
23	E298	Bush	1
24	SP586	Helix-Coil Insert	3
25	C246/2	Base	1

\*Designate /B for Bronze or /C for Chrome

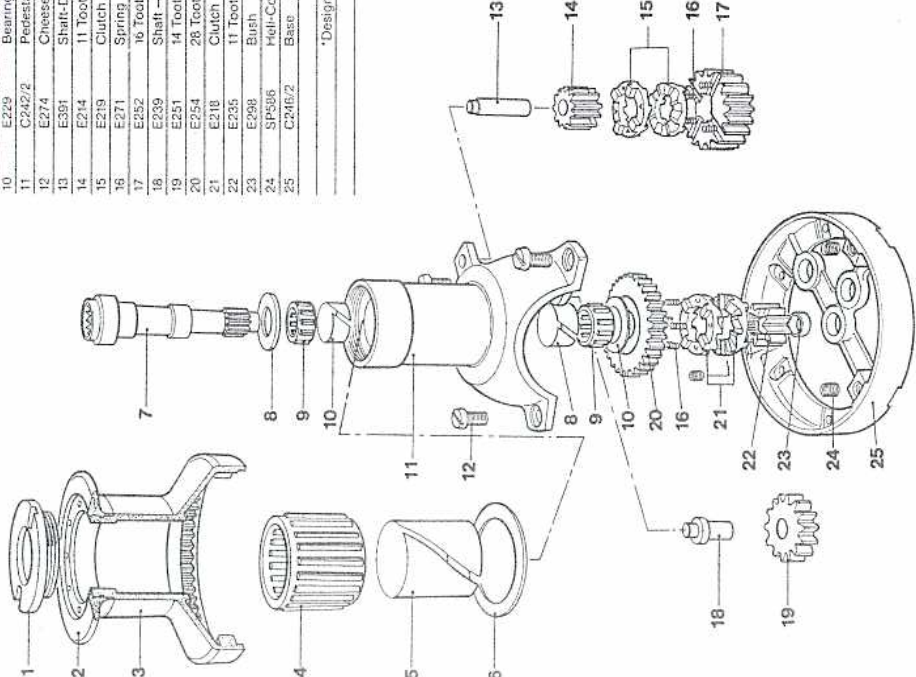

Drawing Number  
C 100062

# MAXWELL 26A

Two-speed Geared

MODEL	FINISH	PRODUCT CODE
26A	Alloy	55264

ITEM	PART No	DESCRIPTION	QTY
1	E276	Retaining Cap	1
2	D245	Cap	1
3	C261/2A	Drum	1
4	E296	Bearing Outer Race	1
5	277	Needle Roller Bearing	1
6	E297	Bearing Inner Race	1
7	E290	Thrust Washer	1
8	D253	Drive Shaft	1
9	E291	Thrust Washer	2
10	247	Needle Roller Bearing	2
11	E229	Bearing Outer Race	2
12	C242/2	Pedestal	1
13	E274	Cheese Head Screw	3
14	E294	Shaft-Driven Gear Cluster	1
15	E256	12 Tooth Clutch Gear	1
16	E295	Clutch — Anticlockwise	2
17	E271	Spring	8
18	E257	20 Tooth Clutch Gear	1
19	E293	Shaft — Idle Gear	1
20	227	Needle Roller Bearing	1
21	E255	15 Tooth Idle Gear	1
22	E254	28 Tooth Clutch Gear	1
23	E292	Clutch — Clockwise	2
24	E285	11 Tooth Clutch Gear — Splined	1
25	E298	Bush	1
26	SP586	Helix-Coil Insert	3
27	C266/2	Base	1

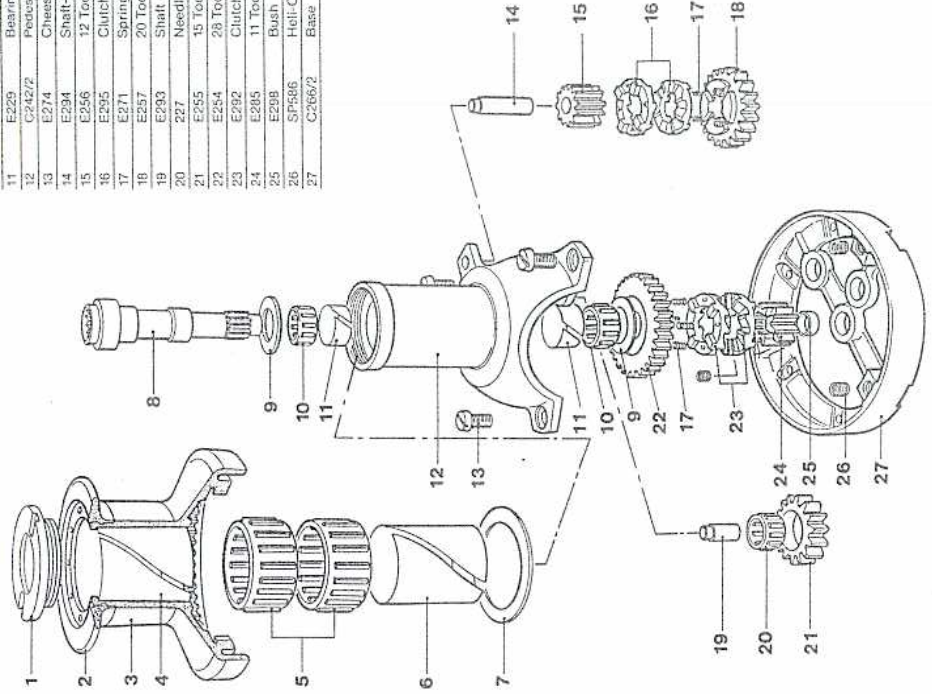

Drawing Number  
C 100067



# MAXWELL 27A

Two-speed Geared

MODEL	FINISH	PRODUCT CODE
27A	Alloy	55274

ITEM	PART No	DESCRIPTION	QTY
1	E275	Retaining Cap	1
2	D426	Cap	1
3	C261/2A	Drum	1
4	E296	Bearing Outer Race	1
5	E277	Needle Roller Bearing	1
6	E297	Bearing Inner Race	1
7	E290	Thrust Washer	1
8	D253	Drive Shaft	1
9	E291	Thrust Washer	2
10	E229	Needle Roller Bearing	2
11	E229	Bearing Outer Race	2
12	B262/2	Pedestal	1
13	E274	Cheese Head Screw	3
14	E294	Shift-Driven Gear Cluster	1
15	E256	12 Tooth Clutch Gear	1
16	E295	Clutch - Anticlockwise	2
17	E271	Spring	8
18	E259	21 Tooth Clutch Gear	1
19	E293	Shift - Idler Gear	1
20	E257	Needle Roller Bearing	1
21	E255	15 Tooth Idler Gear	1
22	E254	28 Tooth Clutch Gear	1
23	E292	Clutch - Clockwise	2
24	E285	11 Tooth Clutch Gear - Splined	1
25	E298	Bush	1
26	SP586	Helix-Coil Insert	3
27	C266/2	Base	1

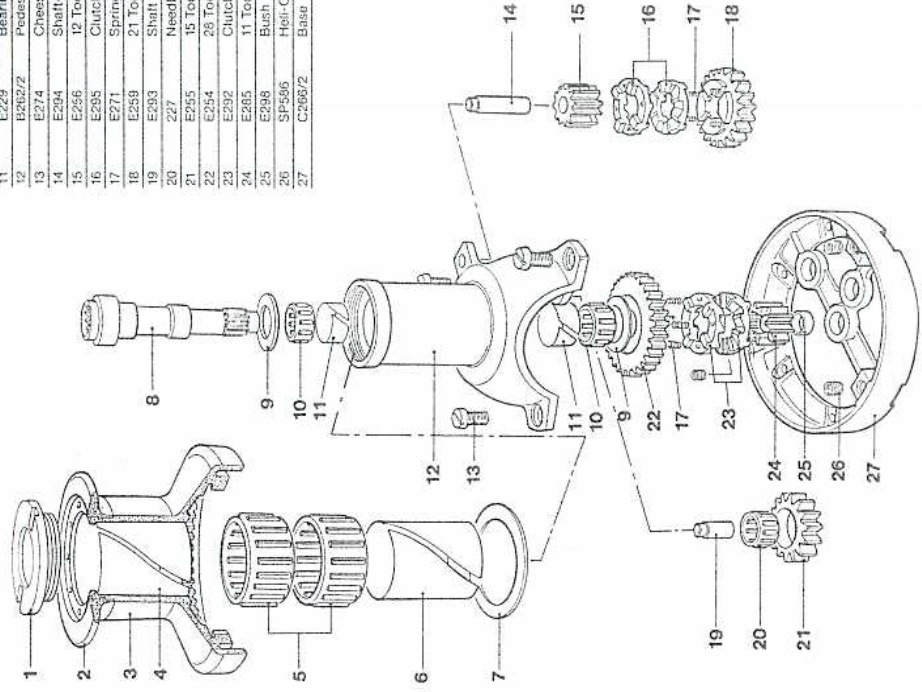

Drawing Number  
C 100071

# MAXWELL 26B 26C

Two-speed Geared

MODEL	FINISH	PRODUCT CODE
26B	Bronze	55265/B
26C	Chrome	55266/C

ITEM	PART No	DESCRIPTION	QTY
1	E276	Retaining Cap	1
2	D425	Cap	1
3	C261/2*	Drum	1
4	E277	Needle Roller Bearing	1
5	E297	Bearing Inner Race	1
6	E290	Thrust Washer	1
7	D253	Drive Shaft	1
8	E291	Thrust Washer	2
9	E229	Needle Roller Bearing	2
10	E229	Bearing Outer Race	2
11	B262/2	Pedestal	1
12	E274	Cheese Head Screw	3
13	E294	Shift-Driven Gear Cluster	1
14	E256	12 Tooth Clutch Gear	1
15	E295	Clutch - Anticlockwise	2
16	E271	Spring	8
17	E257	20 Tooth Clutch Gear	1
18	E293	Shift - Idler Gear	1
19	E255	Needle Roller Bearing	1
20	E254	15 Tooth Idler Gear	1
21	E292	28 Tooth Clutch Gear	1
22	E292	Clutch - Clockwise	2
23	E285	11 Tooth Clutch Gear - Splined	1
24	E298	Bush	1
25	SP586	Helix-Coil Insert	3
26	C266/2	Base	1

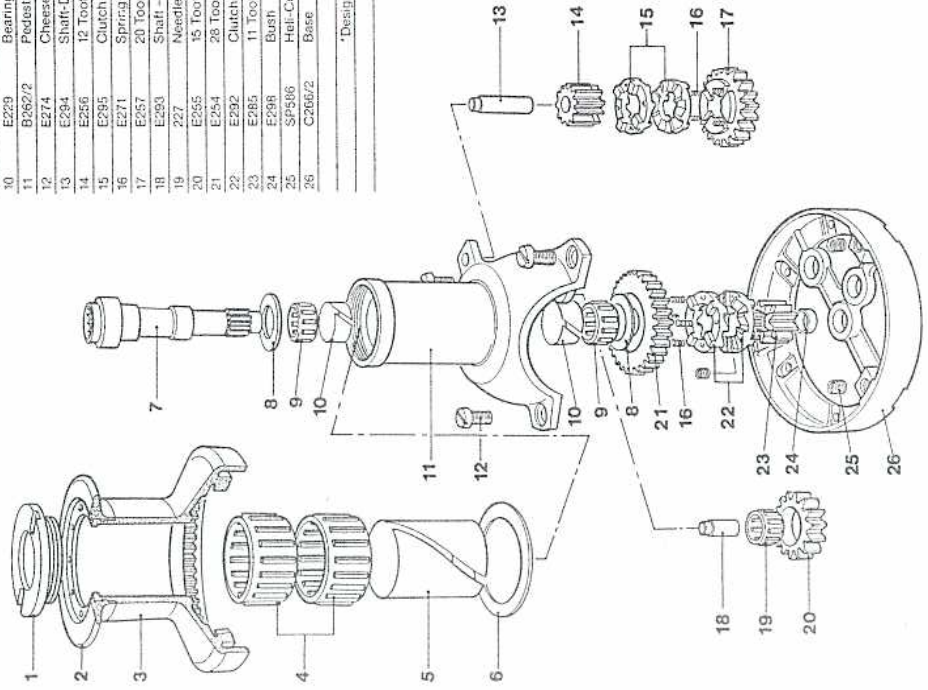

\*Designate /B for Bronze or /C for Chrome

Drawing Number  
C 100068

## MAXWELL 27B 27C

Two-speed Geared

MODEL	FINISH	PRODUCT CODE
27B	Bronze	55275/B
27C	Chrome	55276/C

ITEM	PART No	DESCRIPTION	QTY
1	E276	Retaining Cap	1
2	D426	Cap	1
3	G261/2"	Drum	1
4	277	Needle Roller bearing	2
5	E297	Bearing Inner Race	1
6	E290	Thrust Washer	1
7	E253	Drive Shaft	1
8	E291	Thrust Washer	2
9	247	Needle Roller Bearing	2
10	E290	Bearing Outer Race	2
11	3262/2A	Pedestal	1
12	E274	Cheese Head Screw	3
13	E294	Snat-Driven Gear Cluster	1
14	E256	12 Tooth Clutch Gear	1
15	E295	Clutch - Anticlockwise	2
16	E271	Spring	8
17	E259	21 Tooth Clutch Gear	1
18	E293	Shaft - Idler Gear	1
19	227	Needle Roller Bearing	1
20	E265	15 Tooth Idler Gear	1
21	E254	28 Tooth Clutch Gear	1
22	E282	Clutch - Clockwise	2
23	E285	11 Tooth Clutch Gear - Splined	1
24	E298	Bush	1
25	SP386	Hel-Coil Insert	3
26	G256/2"	Bush	1

\*Designate /B for Bronze or /C for Chrome

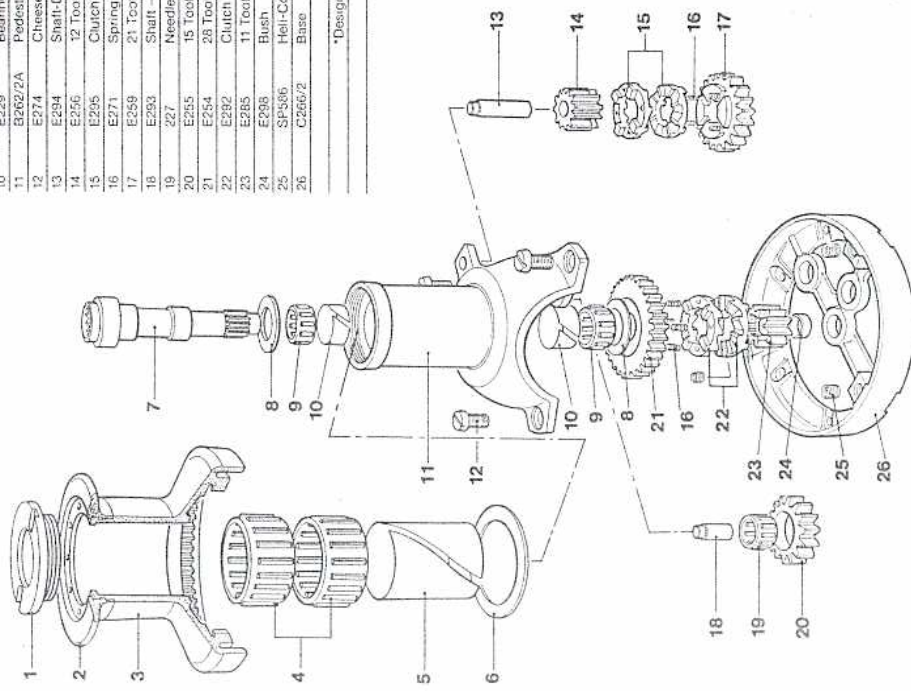

Drawing Number  
**C 100072**

## MAXWELL 28A

### Two-speed Geared

MODEL	FINISH	PRODUCT CODE
28A	Alloy	55284

ITEM	PART NO	DESCRIPTION	QTY
1	E276	Retaining Cap	1
2	D299	Cap	1
3	E296	Bearing Outer Race	1
4	B261/2A	Drum	1
5	E277	Needle Roller Bearing	1
6	E297	Bearing Inner Race	1
7	E290	Thrust Washer	1
8	D263	Drive Shaft	1
9	E291	Thrust Washer	2
10	E279	Needle Roller Bearing	2
11	E279	Bearing Outer Race	2
12	B262/2	Pedestal	1
13	E274	Cheese Head Screw	4
14	E294	Shaft-Driven Gear Cluster	1
15	E267	15 Tooth Clutch Gear	1
16	E295	Clutch — Anticlockwise	2
17	E271	Spring	8
18	E390	27 Tooth Clutch Gear	1
19	E293	Shaft — Idler Gear	1
20	E227	Needle Roller Bearing	1
21	E296	19 Tooth Idler Gear	1
22	E284	30 Tooth Clutch Gear	1
23	E292	Clutch — Clockwise	2
24	E285	11 Tooth Clutch Gear — Splined	1
25	E298	Bush	1
26	SP586	Heli-Coil Insert	4
27	C299/2	Base	1

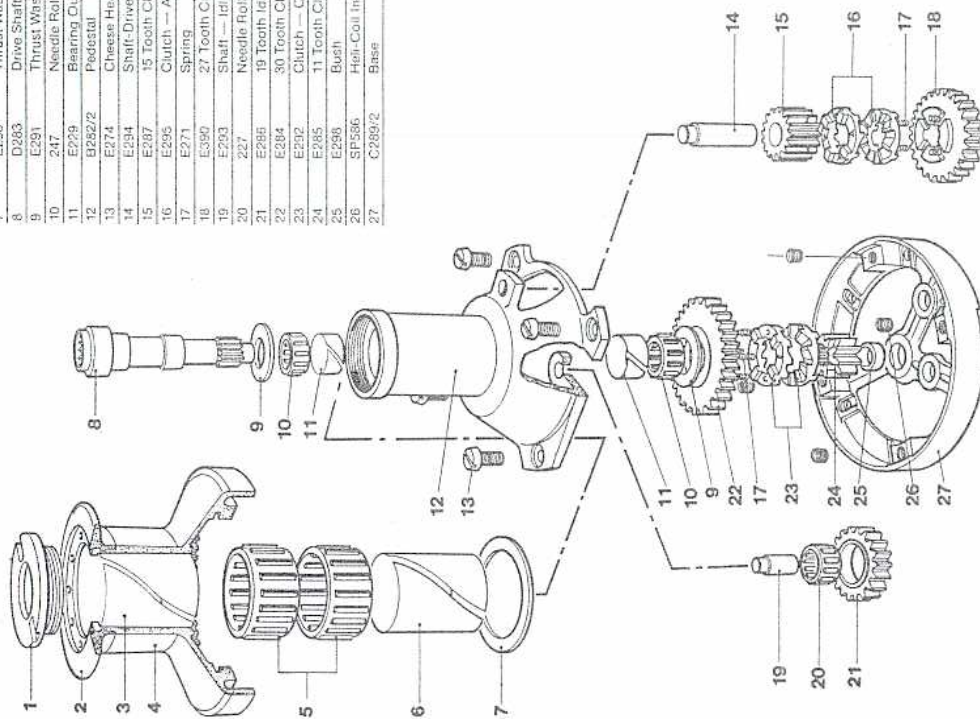
Drawing Number  
C 100079



# MAXWELL 28B 28C

Two-speed Geared

MODEL	FINISH	PRODUCT CODE
28B	Bronze	55285/B
28C	Chrome	55286/C

ITEM	PART No	DESCRIPTION	QTY
1	E276	Retaining Cap	1
2	D299	Cap	1
3	B281/2'	Drum	1
4	277	Needle Roller Bearing	2
5	E297	Bearing Inner Race	1
6	E290	Thrust Washer	1
7	D263	Drive Shaft	1
8	E291	Thrust Washer	2
9	247	Needle Roller Bearing	2
10	E229	Bearing Outer Race	2
11	B282/2	Pedestal	1
12	E274	Cheese Head Screw	4
13	E294	Shaft-Driven Gear Cluster	1
14	E287	15 Tooth Clutch Gear	1
15	E285	Clutch — Anticlockwise	2
16	E271	Spring	8
17	E390	27 Tooth Clutch Gear	1
18	E293	Shaft — Idler Gear	1
19	E296	Needle Roller Bearing	1
20	E284	30 Tooth Idler Gear	1
21	E292	Clutch — Clockwise	2
22	E285	11 Tooth Clutch Gear — Splined	1
23	E298	Bush	1
24	SP566	Helix-Coil Insert	4
25	C289/2	Base	1

\*Designate /B for Bronze or /C for Chrome

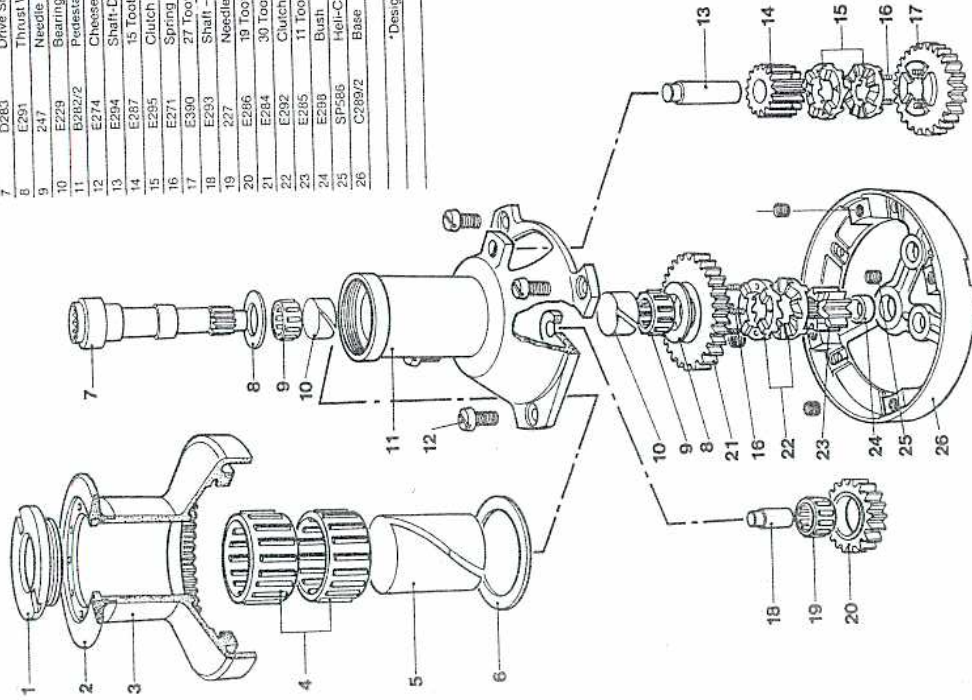

Drawing Number  
**C 100080**  
Copyright 1980

# MAXWELL 29A

Two-speed Geared

MODEL	FINISH	PRODUCT CODE
29A	Alloy	5229A

ITEM	PART No	DESCRIPTION	QTY
1	E276	Retaining Cap	1
2	D434	Cap	1
3	E296	Bearing Outer Race	1
4	B281/2A	Drum	1
5	277	Needle Roller Bearing	2
6	E297	Bearing Inner Race	1
7	E290	Thrust Washer	1
8	D263	Drive Shaft	1
9	E291	Thrust Washer	2
10	247	Needle Roller Bearing	2
11	E229	Bearing Outer Race	2
12	C282/2	Pedestal	1
13	E274	Cheese Head Screw	4
14	E294	Shaft-Driven Gear Cluster	1
15	E287	15 Tooth Clutch Gear	1
16	E285	Clutch — Anticlockwise	2
17	E271	Spring	8
18	E441	29 Tooth Clutch Gear	1
19	E293	Shaft — Idler Gear	1
20	227	Needle Roller Bearing	1
21	E296	19 Tooth Idler Gear	1
22	E284	30 Tooth Clutch Gear	1
23	E292	Clutch — Clockwise	2
24	E285	11 Tooth Clutch Gear — Splined	1
25	E298	Bush	1
26	SP566	Helix-Coil Insert	4
27	C289/2	Base	1

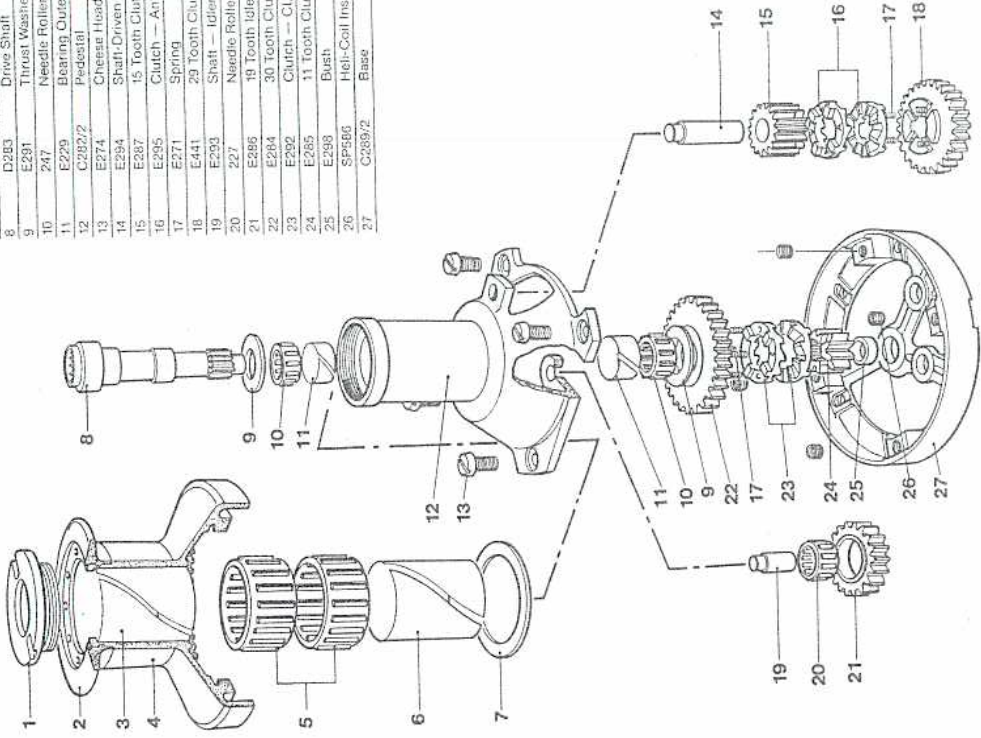

Drawing Number  
**C 100083**  
Copyright 1980



**1** After removing retaining cap, lift jaw assembly and stripper arm with drum. Proceed as for standard winches.

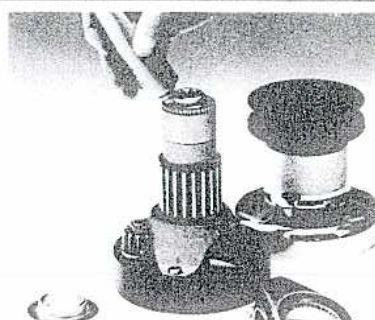

**2** Grease spline on top of pedestal.



**3** (a) Refit drum and adjust position of stripper arm on spline so as to unload rope in desired position.

(b) Lightly grease thread and underside of retaining cap, refit and tighten firmly.

(c) Test action.

## To change rotation of Self-Tailing winches

All Maxwell self-tailers can be simply set for clockwise or anti-clockwise rotation. This allows for better deck layout by passing all lines to the outside of the winch port and starboard and can save turning blocks and lines cutting across combings. **The direction of loading and rotation is clearly marked with arrows on top of the winch.**

**1** Assemble pawls or clutches as explained for standard winches to achieve desired rotation.

**2** Arrows on self-tailing jaw show direction of rotation. If opposite rotation is required:

(a) Remove stripper arm from jaws.

(b) Remove 4 screws fastening jaws to drum.

(c) Lift jaws from drum, turn pair over, relocate on spigot ring and 4 dowel pins. Replace screws and tighten them firmly.

**3** Replace stripper arm and retaining cap.

MODEL	FINISH	PRODUCT CODE
29B	Bronze	55295/B
29C	Chrome	55296/C

ITEM	PART No	DESCRIPTION	QTY
1	E276	Retaining Cap	1
2	D434	Cap	1
3	B281/2"	Drum	1
4	277	Needle Roller Bearing	2
5	E297	Bearing Inner Race	1
6	E290	Thrust Washer	1
7	D283	Drive Shaft	1
8	E291	Thrust Washer	2
9	247	Needle Roller Bearing	2
10	E299	Bearing Outer Race	2
11	C282/2	Pedestal	1
12	E274	Cheese Head Screw	4
13	E294	Shaft-Driven Gear Cluster	1
14	E287	15 Tooth Clutch Gear	1
15	E286	Clutch — Anticlockwise	2
16	E271	Spring	8
17	E441	29 Tooth Clutch Gear	1
18	E293	Shaft — Idle Gear	1
19	227	Needle Roller Bearing	1
20	E286	19 Tooth Idle Gear	1
21	E284	30 Tooth Clutch Gear	1
22	E282	Clutch — Clockwise	2
23	E285	11 Tooth Clutch Gear — Splined	1
24	E298	Bush	1
25	SP586	Helix-Coil Insert	4
26	C289/2	Base	1

\*Designate /B for Bronze or /C for Chrome



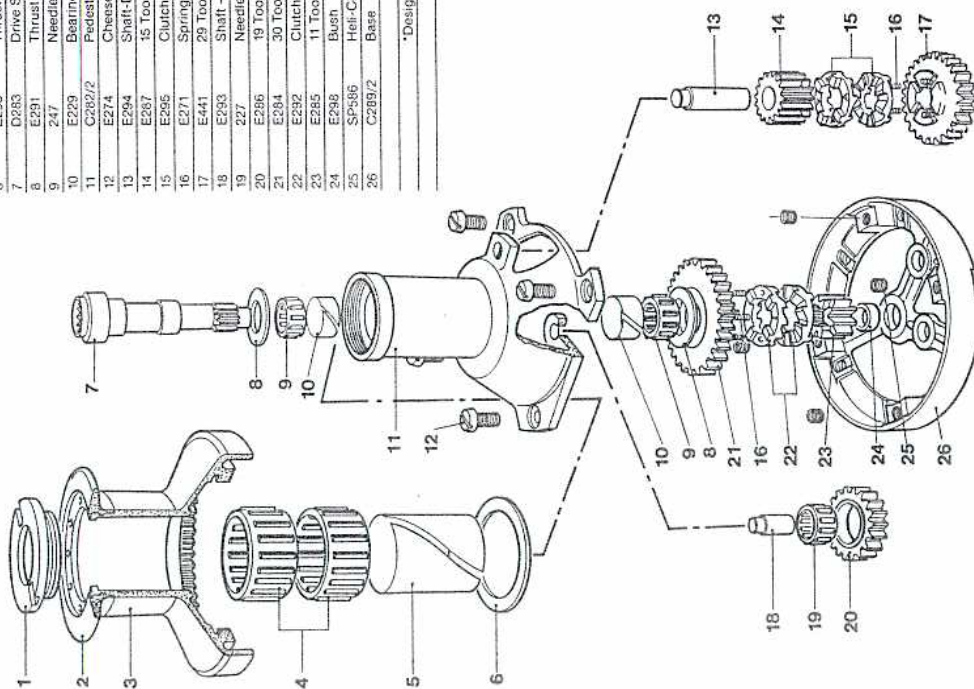

# MAXWELL 17STA

One-speed Geared — Ratcheting

MODEL	FINISH	PRODUCT CODE
17STA	Alloy	57174

ITEM	PART No.	DESCRIPTION	QTY
1	E423	Retaining Cap	1
2	D419	Stripper Ring	1
3	SP19	Pan Head Screw	4
4	D428	Jaw — Clockwise	1
5	E217	Pin	4
6	D429	Jaw — Anticlockwise	1
7	E397	Splint Ring	1
8	D427	Cap	1
9	C201/2A	Drum	1
10	E193	Bearing Outer Race	1
11	197	Needle Roller Bearing	1
12	E184	Bearing Inner Race	1
13	E395	Thrust Washer	1
14	D177	Drive Shaft	1
15	E291	Thrust Washer	1
16	E171	Bush	1
17	E437	Pedestal Extension	1
18	E274	Chicago Head Screw	3
19	C172	Pedestal	1
20	E293	Shaft — Idler Gear	1
21	E236	11 Tooth — Idler Gear	1
22	E298	Bush	1
23	E219	Clutch — Anticlockwise	2
24	E271	Spring	8
25	E439	Bush (Assembled with E173)	1
26	E173	19 Tooth Clutch Gear	1
27	E218	Clutch — Clockwise	2
28	SP586	Helix-Coil Insert	3
29	E438	Bush	1
30	C176	Base	1

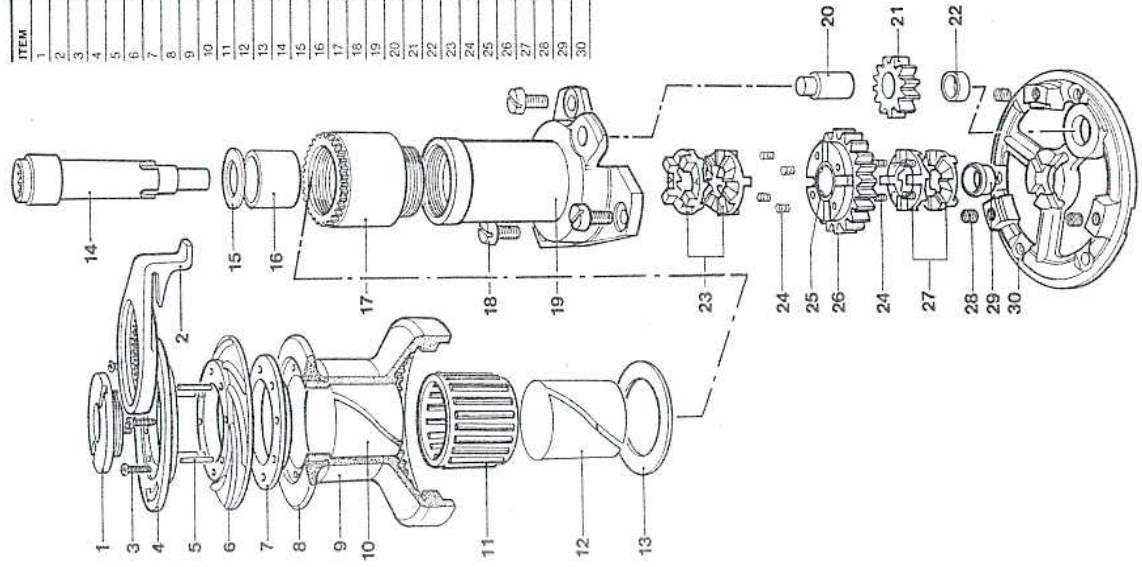

Drawing Number  
C 100025  
© Maxwell 1988

# MAXWELL 17STB 17STC

One-speed Geared — Ratcheting

MODEL	FINISH	PRODUCT CODE
17STB	Bronze	57175/B
17STC	Chrome	57175/C

ITEM	PART No.	DESCRIPTION	QTY
1	E423	Retaining Cap	1
2	D419	Stripper Ring	1
3	SP19	Pan Head Screw	4
4	D428	Jaw — Clockwise	1
5	E217	Pin	4
6	D429	Jaw — Anticlockwise	1
7	E397	Splint Ring	1
8	D427	Cap	1
9	C201/2*	Drum	1
10	187	Needle Roller Bearing	1
11	E184	Bearing Inner Race	1
12	E395	Thrust Washer	1
13	D177	Drive Shaft	1
14	E291	Thrust Washer	1
15	E171	Bush	1
16	E437	Pedestal Extension	1
17	E274	Chicago Head Screw	3
18	C172	Pedestal	1
19	E293	Shaft — Idler Gear	1
20	E236	11 Tooth — Idler Gear	1
21	E298	Bush	1
22	E219	Clutch — Anticlockwise	2
23	E271	Spring	8
24	E439	Bush (Assembled with E173)	1
25	E173	19 Tooth Clutch Gear	2
26	E218	Clutch — Clockwise	2
27	SP586	Helix-Coil Insert	3
28	E438	Bush	1
29	C176	Base	1

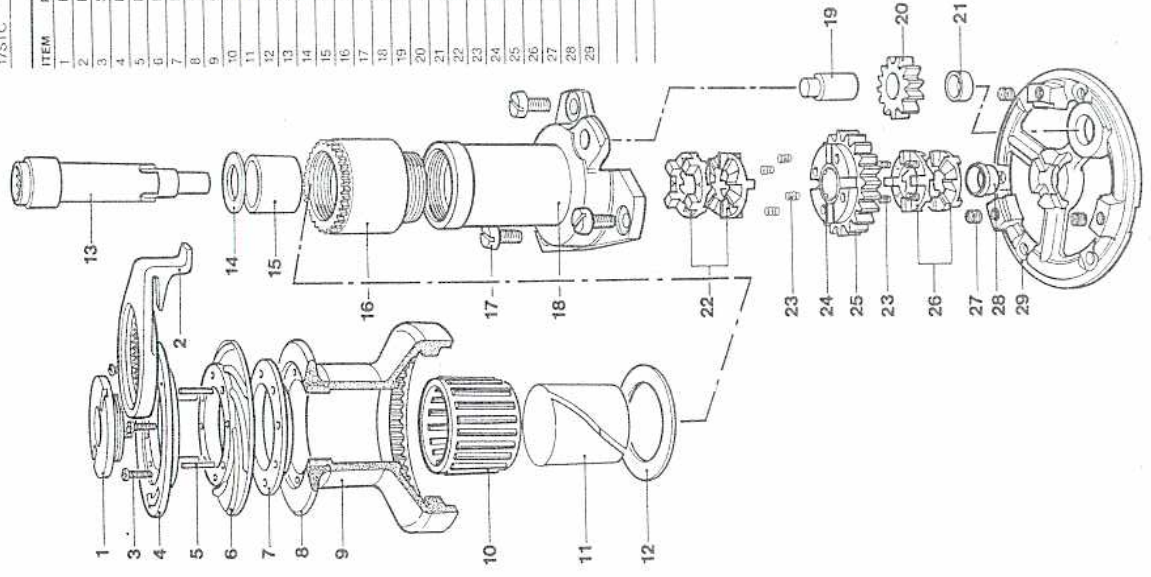

\*Designate /B for Bronze or /C for Chrome

Drawing Number  
C 100026  
© Maxwell 1988

# MAXWELL 18BHSTA

One-speed Bottom handle — Ratcheting

MODEL	FINISH	PRODUCT CODE
18BHSTA	Alloy	58184

ITEM	PART No.	DESCRIPTION	QTY
1	E422	Retaining Cap	1
2	D420	Stripper Ring	1
3	SP19	Pan Head Screw	4
4	D411	Jaw — Clockwise	1
5	E209	Pin	4
6	D412	Jaw — Anticlockwise	1
7	E397	Spigot Ring	1
8	D401	Cap	1
9	D181/2A	Drum	1
10	E163	Bearing Outer Race	1
11	207	Needle Roller Bearing	1
12	E164	Bearing Inner Race	1
13	E395	Thrust Washer	1
14	E437	Pedestal Extension	1
15	E274	Cheese Head Screw	3
16	C185	Pedestal	1
17	E272	Pawl	2
18	E271	Spring	2
19	E298	Bush	2
20	E280	Thrust Washer	2
21	E180	Handle Pivot Pin	1
22	SP19	Pan Head Screw	1
23	E158	Ratchet Block	1
24	E210	Pin	2
25	D159/A	Handle	1
26	E157	Knob	1 pr
27	SP20	Screw	1
28	SP586	Helix-Coil Insert	3
29	C185	Base	1

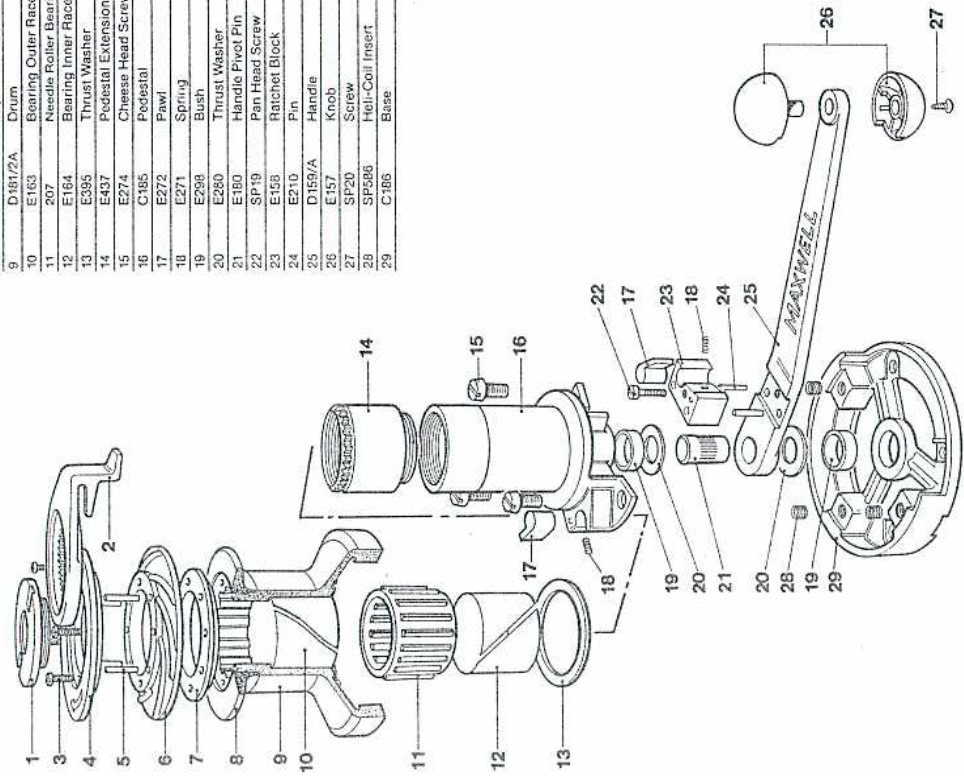

Drawing Number  
C 100033

# MAXWELL 18BHSTB 18BHSTC

One-speed Bottom handle — Ratcheting

MODEL	FINISH	PRODUCT CODE
18BHSTB	Bronze	58185/B
18BHSTC	Chrome	58186/C

ITEM	PART No.	DESCRIPTION	QTY
1	E422	Retaining Cap	1
2	D420	Stripper Ring	1
3	SP19	Pan Head Screw	4
4	D411	Jaw — Clockwise	1
5	E209	Pin	4
6	D412	Jaw — Anticlockwise	1
7	E397	Spigot Ring	1
8	D401	Cap	1
9	D181/2"	Drum	1
10	207	Needle Roller Bearing	1
11	E164	Bearing Inner Race	1
12	E395	Thrust Washer	1
13	E437	Pedestal Extension	1
14	E274	Cheese Head Screw	3
15	C185	Pedestal	1
16	E272	Pawl	2
17	E271	Spring	2
18	E298	Bush	2
19	E280	Thrust Washer	2
20	E180	Handle Pivot Pin	1
21	SP19	Pan Head Screw	1
22	E158	Ratchet Block	1
23	E210	Pin	2
24	D159/A	Handle	1
25	E157	Knob	1 pr
26	SP20	Screw	1
27	SP586	Helix-Coil Insert	3
28	C185	Base	1

\*Designate /B for Bronze or /C for Chrome

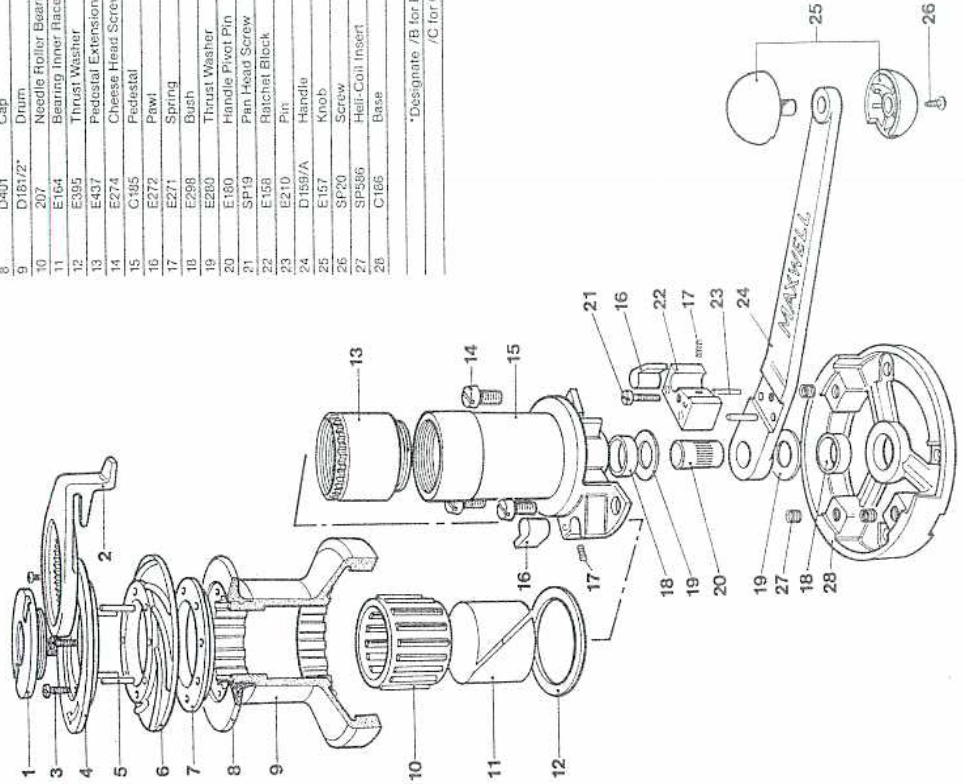

Drawing Number  
C 100034



# MAXWELL 20STA

Two-speed Geared

MODEL	FINISH	PRODUCT CODE
20STA	Alloy	58204

ITEM	PART No.	DESCRIPTION	QTY
1	E423	Retaining Cap	1
2	D419	Stripper Arm	1
3	SP19	Pan Head Screw	4
4	D407	Jaw — Clockwise	1
5	E217	Pin	4
6	D408	Jaw — Anticlockwise	1
7	E397	Spigot Ring	1
8	D399	Cap	1
9	C201/2A	Drum	1
10	E183	Bearing Outer Race	1
11	E187	Needle Roller Bearing	1
12	E184	Bearing Inner Race	1
13	E395	Thrust Washer	1
14	D216	Drive Shaft	1
15	E291	Thrust Washer	1
16	E171	Bush	2
17	E437	Pedestal Extension	1
18	C202/2	Pedestal	1
19	E274	Cheese Head Screw	3
20	E391	Shaft-Driven Gear Cluster	1
21	E237	12 Tooth Clutch Gear	1
22	E219	Clutch — Anticlockwise	2
23	E271	Spring	8
24	E214	11 Tooth Clutch Gear	1
25	E239	Shaft — Idler Gear	1
26	E236	11 Tooth Idler Gear	1
27	E212	20 Tooth Clutch Gear	1
28	E218	Clutch — Clockwise	2
29	E211	15 Tooth Clutch Gear — Spined	1
30	E280	Bush	1
31	SP506	Helix-Coil Insert	3
32	C206/2	Base	1

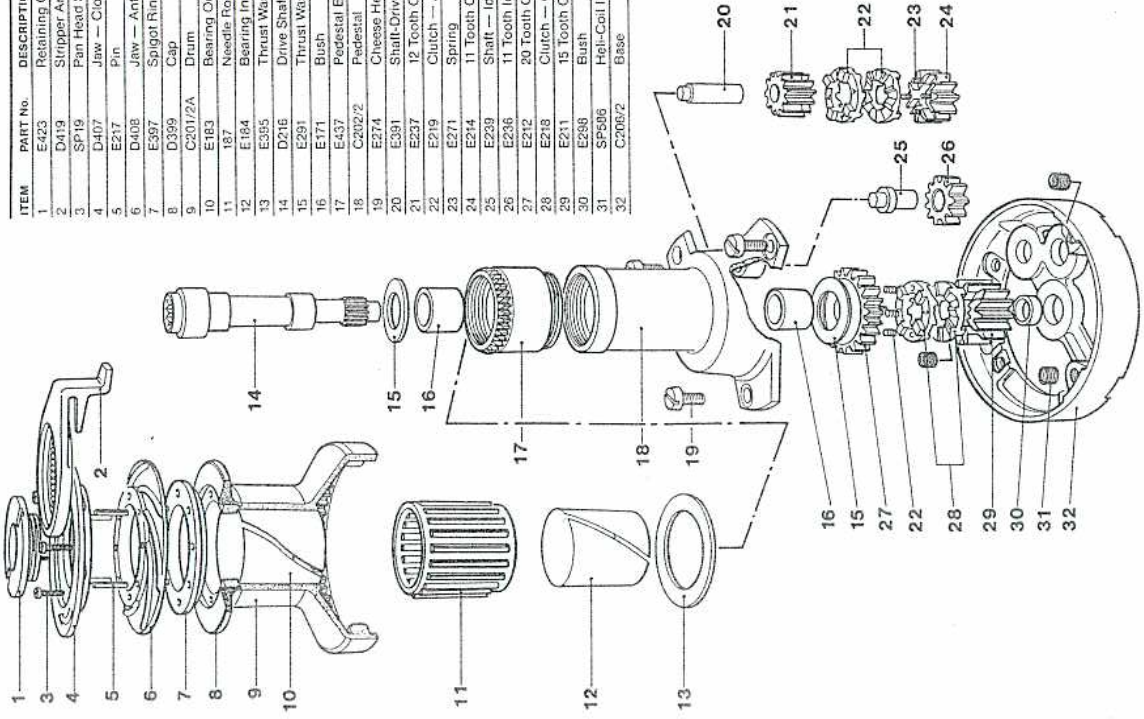

Drawing Number  
C 100039

# MAXWELL 20STB 20STC

Two-speed Geared

MODEL	FINISH	PRODUCT CODE
20STB	Bronze	58205/B
20STC	Chrome	58206/C

ITEM	PART No.	DESCRIPTION	QTY
1	E423	Retaining Cap	1
2	D419	Stripper Arm	1
3	SP19	Pan Head Screw	4
4	D407	Jaw — Clockwise	1
5	E217	Pin	4
6	D408	Jaw — Anticlockwise	1
7	E397	Spigot Ring	1
8	D399	Cap	1
9	C201/2	Drum	1
10	E187	Needle Roller Bearing	1
11	E184	Bearing Inner Race	1
12	E395	Thrust Washer	1
13	D216	Drive Shaft	1
14	E291	Thrust Washer	2
15	E171	Bush	2
16	E437	Pedestal Extension	1
17	C202/2	Pedestal	1
18	E274	Cheese Head Screw	3
19	E391	Shaft-Driven Gear Cluster	1
20	E237	12 Tooth Clutch Gear	1
21	E219	Clutch — Anticlockwise	2
22	E271	Spring	8
23	E214	11 Tooth Clutch Gear	1
24	E239	Shaft — Idler Gear	1
25	E236	11 Tooth Idler Gear	1
26	E212	20 Tooth Clutch Gear	1
27	E218	Clutch — Clockwise	2
28	E211	15 Tooth Clutch Gear — Spined	1
29	SP506	Helix-Coil Insert	3
30	E280	Bush	1
31	C206/2	Base	1

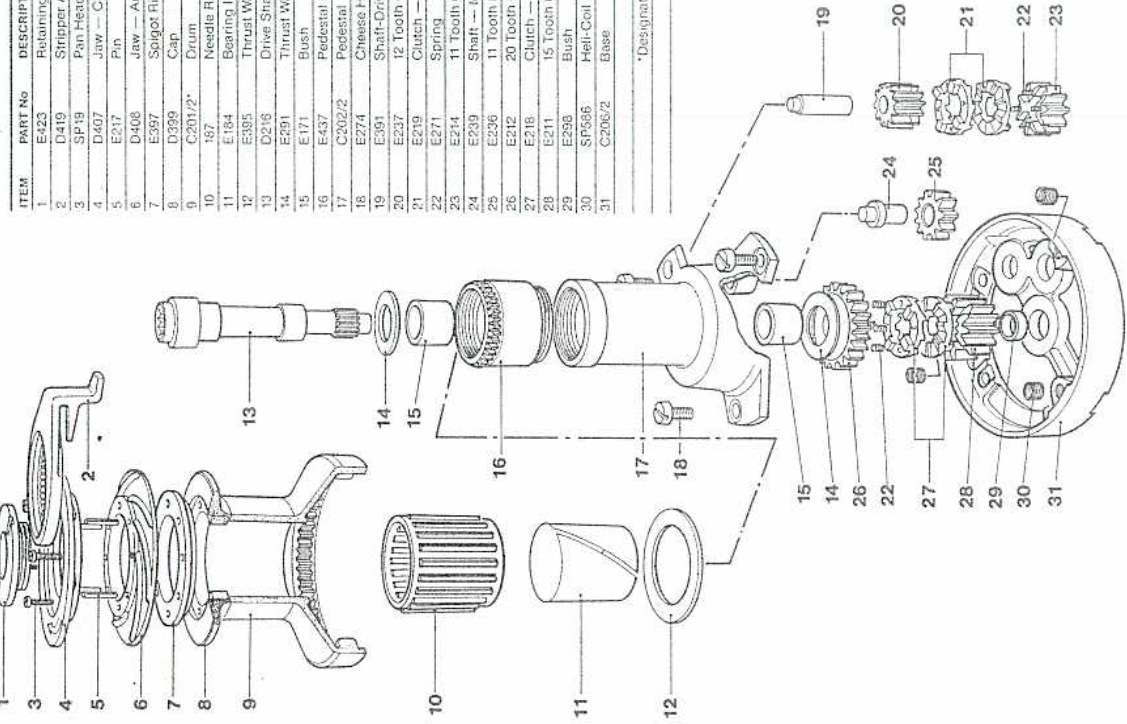

\* Designate /B for Bronze or /C for Chrome

Drawing Number  
C 100040

# MAXWELL 21STB 21STC

Two-speed Geared

MODEL	FINISH	PRODUCT CODE
21STB	Bronze	58215/B
21STC	Chrome	58216/C

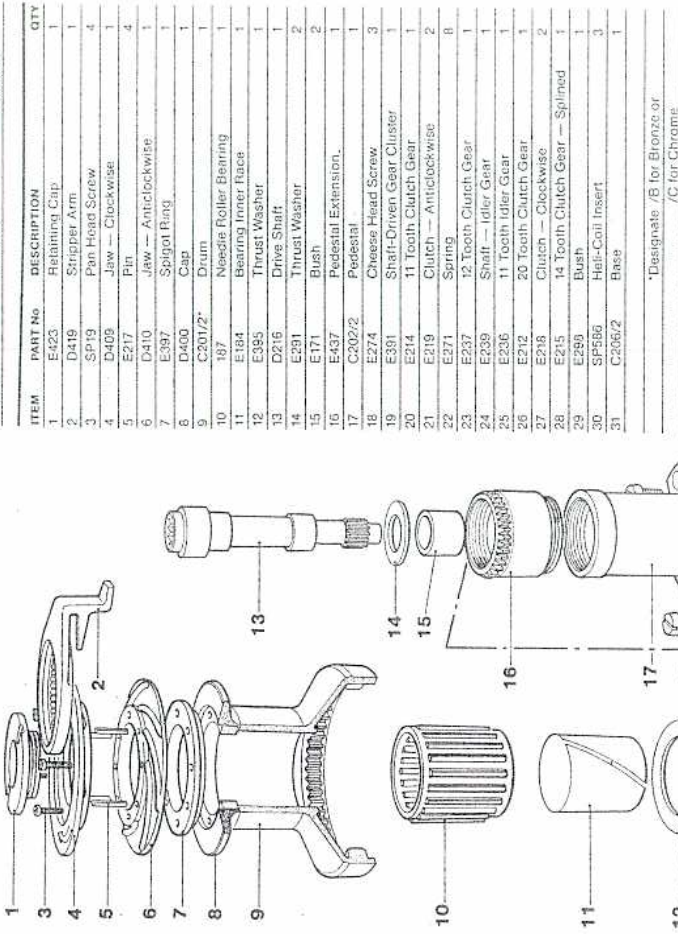

\*Designate /B for Bronze or /C for Chrome

Drawing Number  
C 100044

# MAXWELL 21STA

Two-speed Geared

MODEL	FINISH	PRODUCT CODE
21STA	Alloy	58214

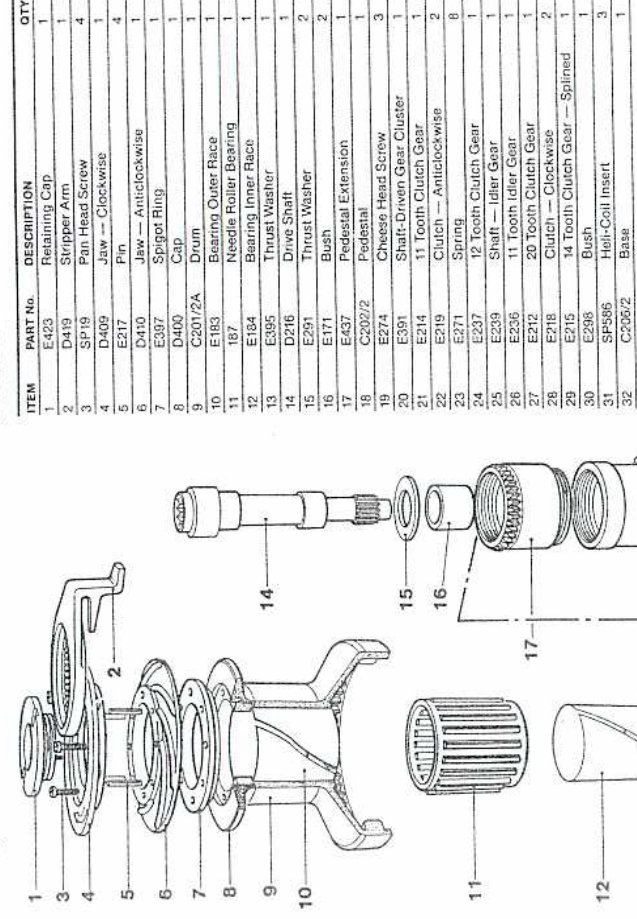

Drawing Number  
C 100043



# MAXWELL 22STA

Two-speed Geared

MODEL	FINISH	PRODUCT CODE
22STA	Alloy	58224

ITEM	PART No.	DESCRIPTION	QTY
1	E423	Retaining Cap	1
2	D420	Stripper Arm	1
3	SP19	Pin Head Screw	4
4	D413	Jaw — Clockwise	1
5	E209	Pin	4
6	D414	Jaw — Anticlockwise	1
7	E397	Spigot Ring	1
8	D402	Cap	1
9	C221/2A	Drum	1
10	E183	Bearing Outer Race	1
11	E187	Needle Roller Bearing	1
12	E184	Bearing Inner Race	1
13	E395	Thrust Washer	1
14	D393	Drive Shaft	1
15	E291	Thrust Washer	2
16	E247	Needle Roller Bearing	2
17	E229	Bearing Outer Race	2
18	E396	Pedestal Extension	1
19	C222/2	Pedestal	1
20	E274	Cheese Head Screw	3
21	E391	Shaft-Driven Gear Cluster	1
22	E237	12 Tooth Clutch Gear	1
23	E219	Clutch — Anticlockwise	2
24	E271	Spring	8
25	E232	14 Tooth Clutch Gear	1
26	E236	Shaft — Idler Gear	1
27	E235	11 Tooth Idler Gear	1
28	E234	22 Tooth Clutch Gear	1
29	E218	Clutch — Clockwise	2
30	E231	12 Tooth Clutch Gear — Splined	1
31	E298	Bush	1
32	SP586	Helix-Coil Insert	3
33	C226/2	Base	1

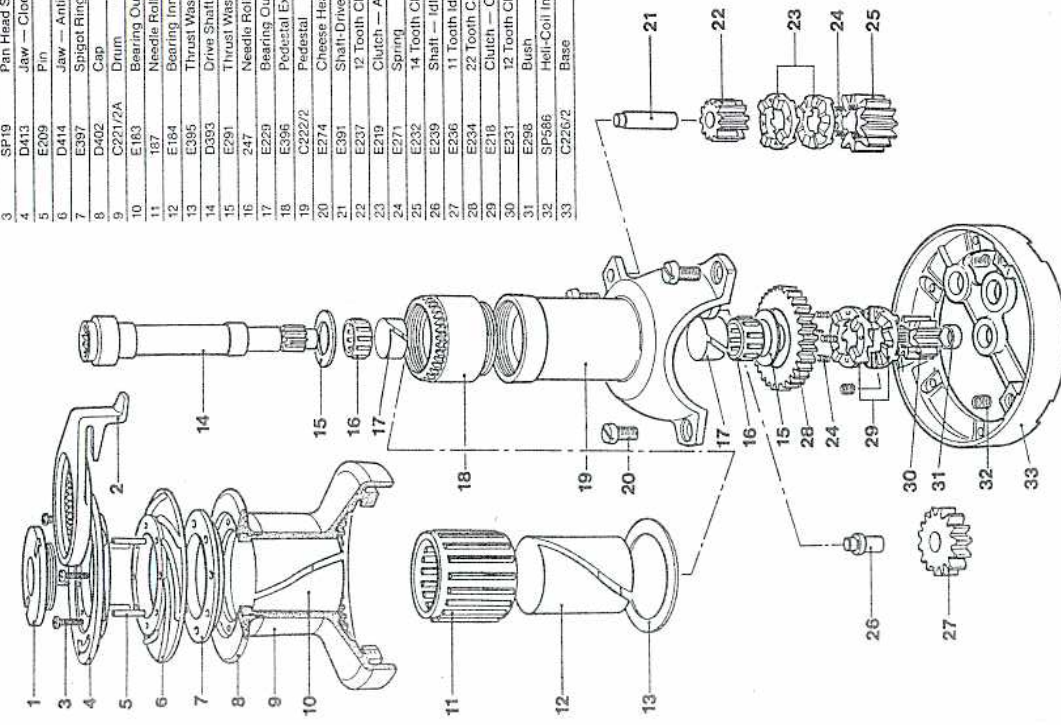

Drawing Number  
C 100049

# MAXWELL 22STB 22STC

Two-speed Geared

MODEL	FINISH	PRODUCT CODE
22STB	Bronze	58225/B
22STC	Chrome	58226/C

ITEM	PART No.	DESCRIPTION	QTY
1	E423	Retaining Cap	1
2	D420	Stripper Arm	1
3	SP19	Pin Head Screw	4
4	D413	Jaw — Clockwise	1
5	E209	Pin	4
6	D414	Jaw — Anticlockwise	1
7	E397	Spigot Ring	1
8	D402	Cap	1
9	C221/2*	Drum	1
10	E187	Needle Roller Bearing	1
11	E184	Bearing Inner Race	1
12	E395	Thrust Washer	1
13	D393	Drive Shaft	1
14	E291	Thrust Washer	2
15	E247	Needle Roller Bearing	2
16	E229	Bearing Outer Race	2
17	E396	Pedestal Extension	1
18	C222/2	Pedestal	1
19	E274	Cheese Head Screw	3
20	E391	Shaft-Driven Gear Cluster	1
21	E237	12 Tooth Clutch Gear	1
22	E219	Clutch — Anticlockwise	2
23	E271	Spring	8
24	E232	14 Tooth Clutch Gear	1
25	E239	Shaft — Idler Gear	1
26	E236	11 Tooth Idler Gear	1
27	E234	22 Tooth Clutch Gear	1
28	E218	Clutch — Clockwise	2
29	E231	12 Tooth Clutch Gear — Splined	1
30	E298	Bush	1
31	SP586	Helix-Coil Insert	3
32	C226/2	Base	1

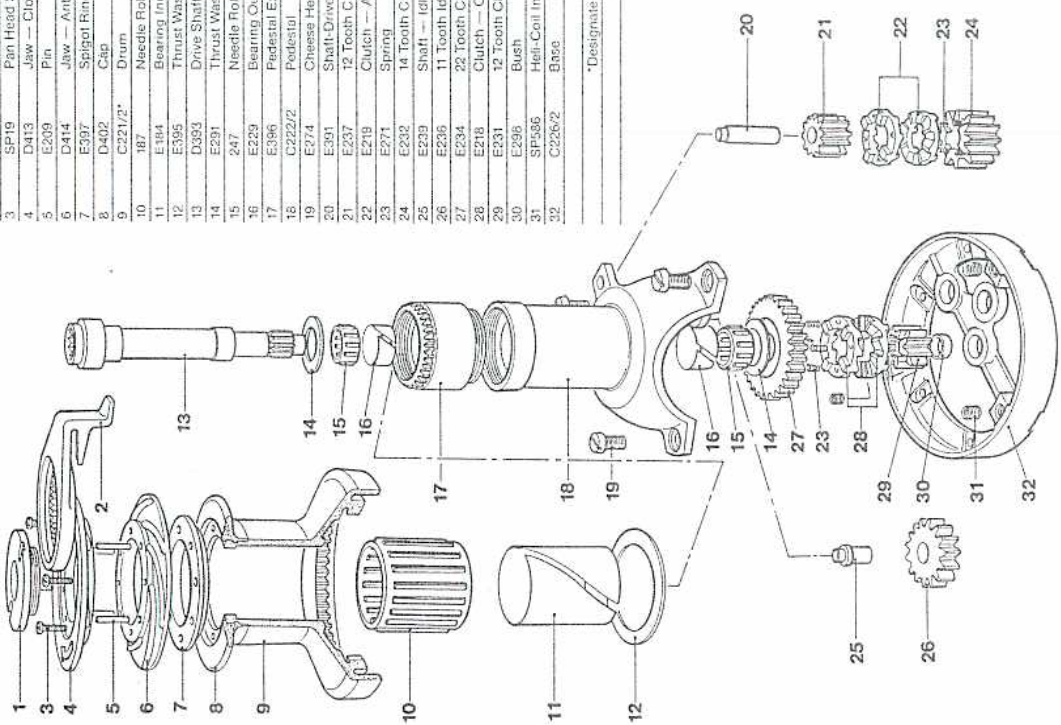

\*Designate /B for Bronze or /C for Chrome

Drawing Number  
C 100050

# MAXWELL 23STA

Two-speed Geared

MODEL	FINISH	PRODUCT CODE
23STA	Alloy	58234

ITEM	PART No.	DESCRIPTION	QTY
1	E423	Retaining Cap	1
2	D420	Stripper Arm	1
3	SP19	Pan Head Screw	4
4	D415	Jaw — Clockwise	1
5	E209	Pin	4
6	D416	Jaw — Anticlockwise	1
7	E397	Spigot Ring	1
8	D403	Cap	1
9	C221/2A	Drum	1
10	E183	Bearing Outer Race	1
11	E184	Needle Roller Bearing	1
12	E184	Bearing Inner Race	1
13	E385	Thrust Washer	1
14	D393	Drive Shaft	1
15	E291	Thrust Washer	2
16	247	Needle Roller Bearing	2
17	E229	Bearing Outer Race	2
18	E396	Podestal Extension	1
19	C222/2	Podestal	1
20	E274	Cheese Head Screw	3
21	E391	Shaft-Driven Gear Cluster	1
22	E237	12 Tooth Clutch Gear	1
23	E219	Clutch — Anticlockwise	2
24	E271	Spring	8
25	E236	15 Tooth Clutch Gear	1
26	E239	Shaft — Idle Gear	1
27	E236	11 Tooth Idle Gear	1
28	E234	22 Tooth Clutch Gear	1
29	E218	Clutch — Clockwise	2
30	E235	11 Tooth Clutch Gear — Splined	1
31	E298	Bush	1
32	SP586	Helix-Coil Insert	3
33	C226/2	Base	1

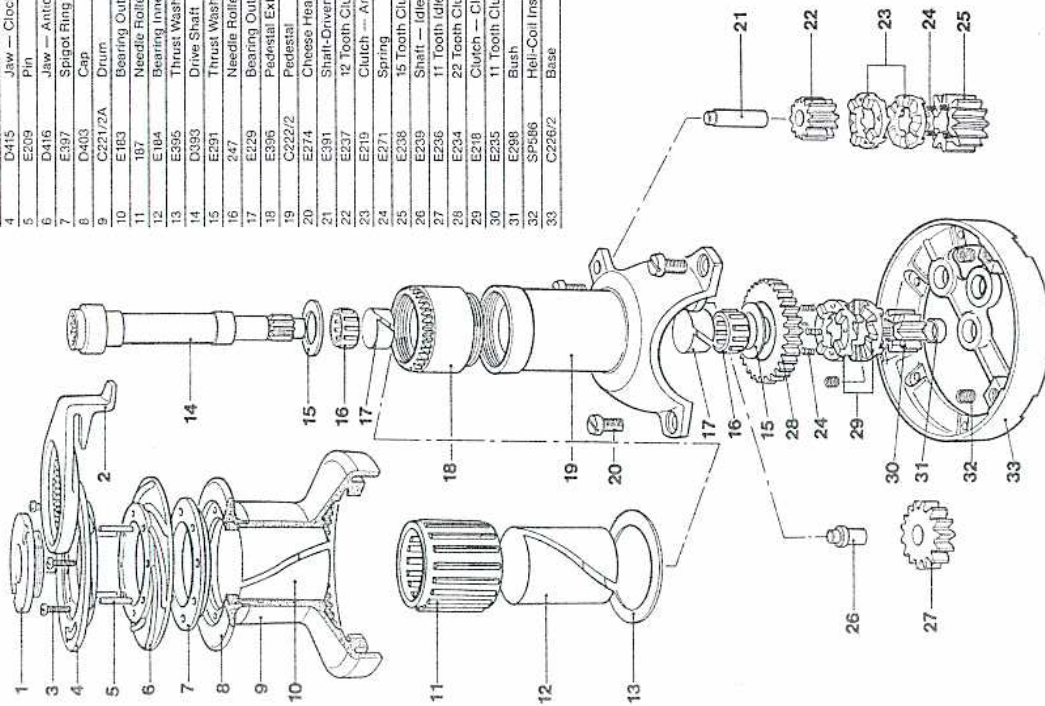

Drawing Number  
C 100053

# MAXWELL 23STB 23STC

Two-speed Geared

MODEL	FINISH	PRODUCT CODE
23STB	Bronze	58235/B
23STC	Chrome	58236/C

ITEM	PART No.	DESCRIPTION	QTY
1	E423	Retaining Cap	1
2	D420	Stripper Arm	1
3	SP19	Pan Head Screw	4
4	D415	Jaw — Clockwise	1
5	E209	Pin	4
6	D416	Jaw — Anticlockwise	1
7	E397	Spigot Ring	1
8	D403	Cap	1
9	C221/2*	Drum	1
10	187	Needle Roller Bearing	1
11	E184	Bearing Inner Race	1
12	E385	Thrust Washer	1
13	D393	Drive Shaft	1
14	E291	Thrust Washer	2
15	247	Needle Roller Bearing	2
16	E229	Bearing Outer Race	2
17	E396	Podestal Extension	1
18	C222/2	Podestal	1
19	E274	Cheese Head Screw	3
20	E391	Shaft-Driven Gear Cluster	1
21	E237	12 Tooth Clutch Gear	1
22	E219	Clutch — Anticlockwise	2
23	E271	Spring	8
24	E238	15 Tooth Clutch Gear	1
25	E239	Shaft — Idle Gear	1
26	E236	11 Tooth Idle Gear	1
27	E234	22 Tooth Clutch Gear	1
28	E218	Clutch — Clockwise	2
29	E235	11 Tooth Clutch Gear — Splined	1
30	E298	Bush	1
31	SP586	Helix-Coil Insert	3
32	C226/2	Base	1

\*Designate /B for Bronze or  
/C for Chrome

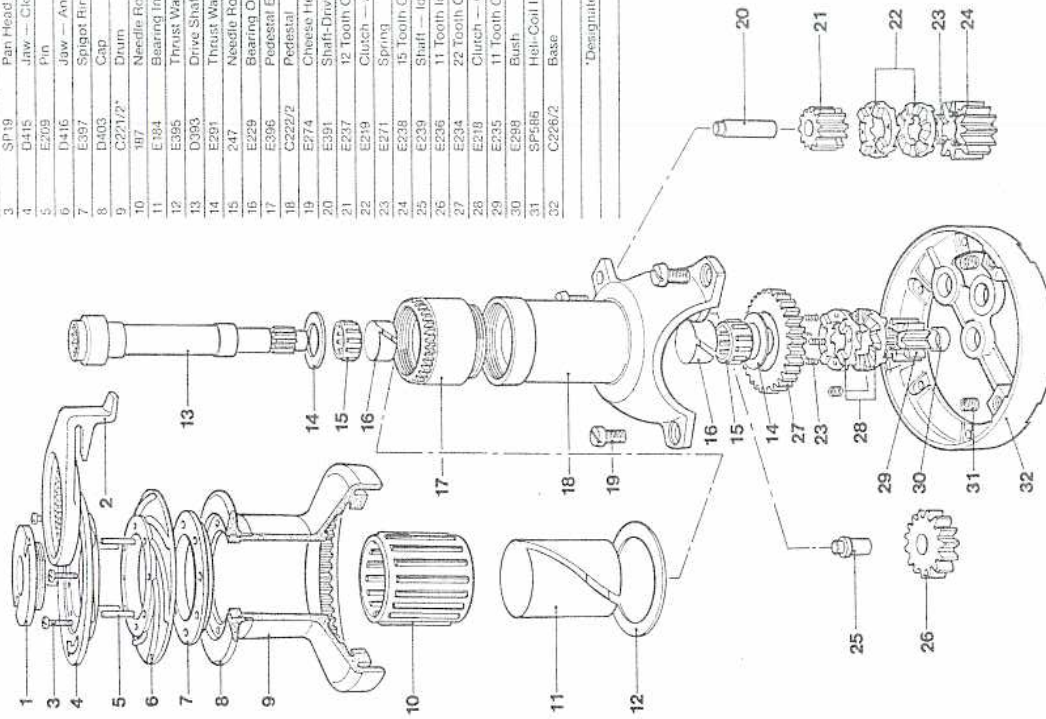

Drawing Number  
C 100054



# MAXWELL 24STA

Two-speed Geared

MODEL	FINISH	PRODUCT CODE
24STA	Alloy	58244

ITEM	PART No	DESCRIPTION	QTY
1	E423	Retaining Cap	1
2	D421	Stripper Arm	1
3	SP19	Pan Head Screw	4
4	D417	Jaw — Clockwise	1
5	E209	Pin	4
6	D418	Jaw — Anticlockwise	1
7	E397	Spiral Ring	1
8	D404	Cap	1
9	C241/2A	Drum	1
10	E183	Bearing Outer Race	1
11	E187	Needle Roller Bearing	1
12	E184	Bearing Inner Race	1
13	E395	Thrust Washer	1
14	D394	Drive Shaft	1
15	E291	Thrust Washer	2
16	247	Needle Roller Bearing	2
17	E229	Bearing Outer Race	2
18	E396	Pedestal Extension	1
19	C242/2	Pedestal	1
20	E274	Cheese Head Screw	3
21	E391	Shaft-Driven Gear Cluster	1
22	E237	12 Tooth Clutch Gear	1
23	E219	Clutch — Anticlockwise	2
24	E271	Spring	8
25	E252	16 Tooth Clutch Gear	1
26	E239	Shaft — Idler Gear	1
27	E251	14 Tooth Idler Gear	1
28	E254	28 Tooth Clutch Gear	1
29	E218	Clutch — Clockwise	2
30	E235	11 Tooth Clutch Gear — Splined	1
31	E298	Bush	1
32	SP586	Helix-Coil Insert	3
33	C246/2	Base	1

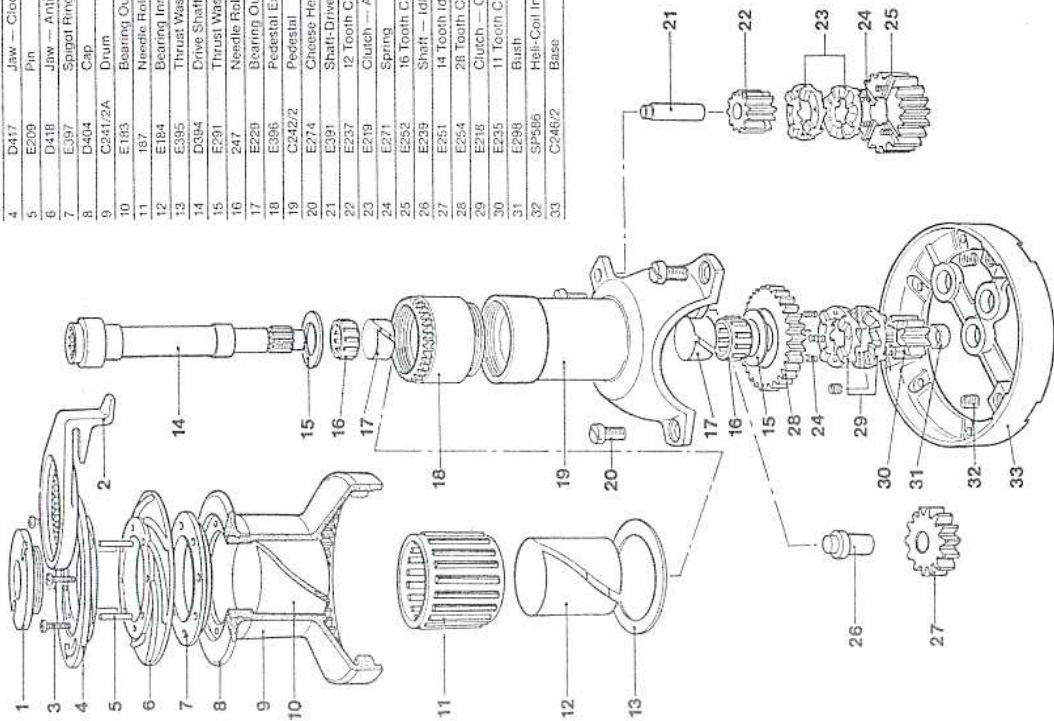

Drawing Number  
C 100059

# MAXWELL 24STB 24STC

Two-speed Geared

MODEL	FINISH	PRODUCT CODE
24STB	Bronze	58245/B
24STC	Chrome	58246/C

ITEM	PART No	DESCRIPTION	QTY
1	E423	Retaining Cap	1
2	D421	Stripper Arm	1
3	SP19	Pan Head Screw	4
4	D417	Jaw — Clockwise	1
5	E209	Pin	4
6	D418	Jaw — Anticlockwise	1
7	E397	Spiral Ring	1
8	D404	Cap	1
9	C241/2*	Drum	1
10	E187	Needle Roller Bearing	1
11	E184	Bearing Inner Race	1
12	E395	Thrust Washer	1
13	D394	Drive Shaft	1
14	E291	Thrust Washer	2
15	247	Needle Roller Bearing	2
16	E229	Bearing Outer Race	2
17	E396	Pedestal Extension	1
18	C242/2	Pedestal	1
19	E274	Cheese Head Screw	3
20	E391	Shaft-Driven Gear Cluster	1
21	E237	12 Tooth Clutch Gear	1
22	E219	Clutch — Anticlockwise	2
23	E271	Spring	8
24	E252	16 Tooth Clutch Gear	1
25	E239	Shaft — Idler Gear	1
26	E251	14 Tooth Idler Gear	1
27	E254	28 Tooth Clutch Gear	1
28	E218	Clutch — Clockwise	2
29	E235	11 Tooth Clutch Gear — Splined	1
30	E298	Bush	1
31	SP586	Helix-Coil Insert	3
32	C246/2	Base	1

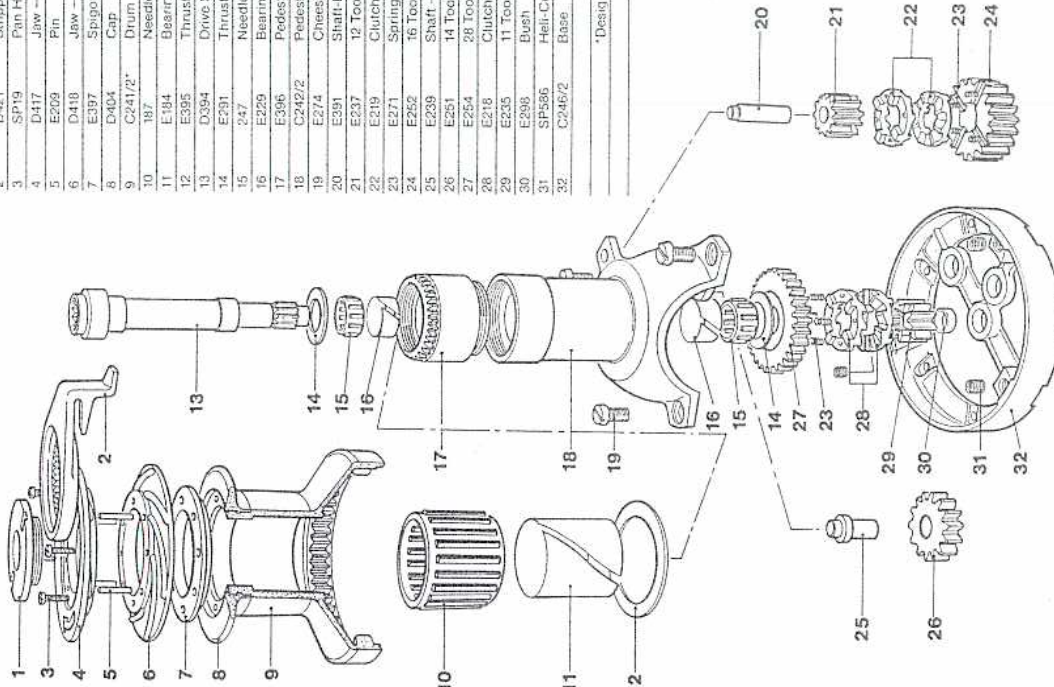

\*Designate /B for Bronze or /C for Chrome

Drawing Number  
C 100060

# MAXWELL 25STA

Two-speed Geared

MODEL	FINISH	PRODUCT CODE
25STA	Alloy	58254

ITEM	PART No.	DESCRIPTION	QTY
1	E423	Retaining Cap	1
2	D421	Stripper Arm	1
3	SP19	Pin Head Screw	4
4	D430	Jaw — Clockwise	1
5	E209	Pin	4
6	D431	Jaw — Anticlockwise	1
7	E397	Spigot Ring	1
8	D424	Cap	1
9	C241/2A	Drum	1
10	E183	Bearing Outer Race	1
11	E187	Needle Roller Bearing	1
12	E184	Bearing Inner Race	1
13	E395	Thrust Washer	1
14	D394	Drive Shaft	1
15	E291	Thrust Washer	2
16	D247	Needle Roller Bearing	2
17	E229	Bearing Outer Race	2
18	E396	Pedestal Extension	1
19	C242/2	Pedestal	1
20	E274	Cheese Head Screw	3
21	E391	Shaft-Driven Gear Cluster	1
22	E214	11 Tooth Clutch Gear	1
23	E219	Clutch — Anticlockwise	2
24	E271	Spring	8
25	E252	16 Tooth Clutch Gear	1
26	E239	Shaft — Idler Gear	1
27	E251	14 Tooth Idler Gear	1
28	E254	28 Tooth Clutch Gear	1
29	E218	Clutch — Clockwise	2
30	E235	11 Tooth Clutch Gear — Splined	1
31	E298	Bush	1
32	SP586	Helix-Coil Insert	3
33	C246/2	Base	1

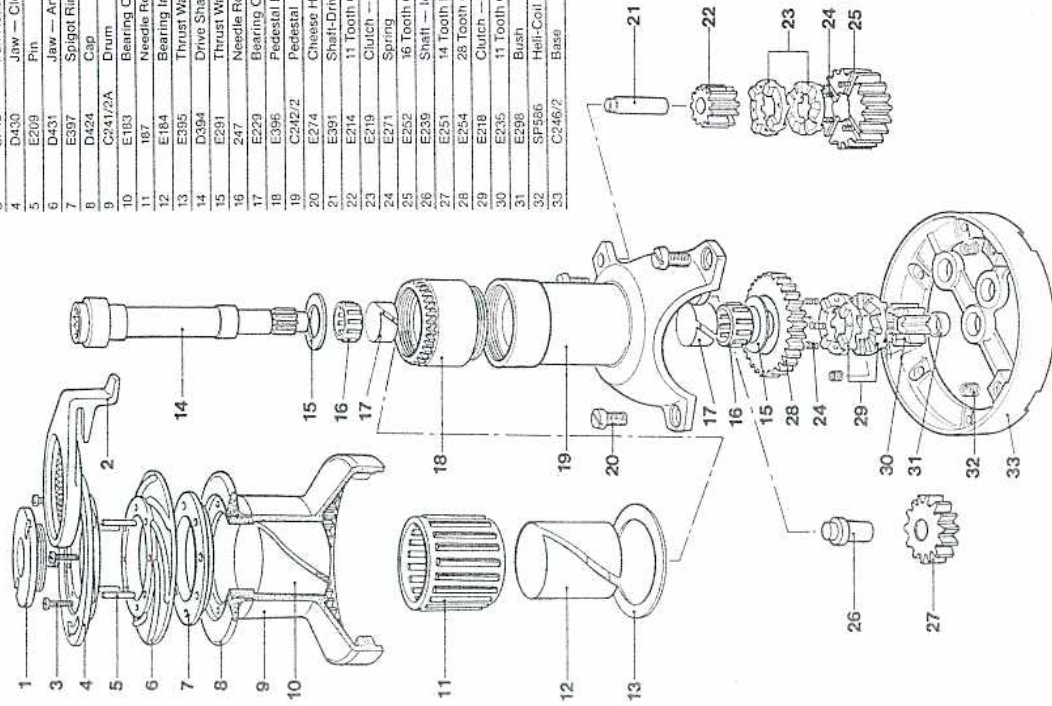

Drawing Number  
C 100063

# MAXWELL 25STB 25STC

Two-speed Geared

MODEL	FINISH	PRODUCT CODE
25STB	Bronze	58255/B
25STC	Chrome	58256/C

ITEM	PART No.	DESCRIPTION	QTY
1	E423	Retaining Cap	1
2	D421	Stripper Arm	1
3	SP19	Pin Head Screw	4
4	D430	Jaw — Clockwise	1
5	E209	Pin	4
6	D431	Jaw — Anticlockwise	1
7	E397	Spigot Ring	1
8	D424	Cap	1
9	C241/2	Drum	1
10	E187	Needle Roller Bearing	1
11	E184	Bearing Inner Race	1
12	E395	Thrust Washer	1
13	D394	Drive Shaft	1
14	E291	Thrust Washer	2
15	D247	Needle Roller Bearing	2
16	E229	Bearing Outer Race	2
17	E396	Pedestal Extension	1
18	C242/2	Pedestal	1
19	E274	Cheese Head Screw	3
20	E391	Shaft-Driven Gear Cluster	1
21	E214	11 Tooth Clutch Gear	1
22	E219	Clutch — Anticlockwise	2
23	E271	Spring	8
24	E252	16 Tooth Clutch Gear	1
25	E239	Shaft — Idler Gear	1
26	E251	14 Tooth Idler Gear	1
27	E254	28 Tooth Clutch Gear	1
28	E218	Clutch — Clockwise	2
29	E235	11 Tooth Clutch Gear — Splined	1
30	E298	Bush	1
31	SP586	Helix-Coil Insert	3
32	C246/2	Base	1

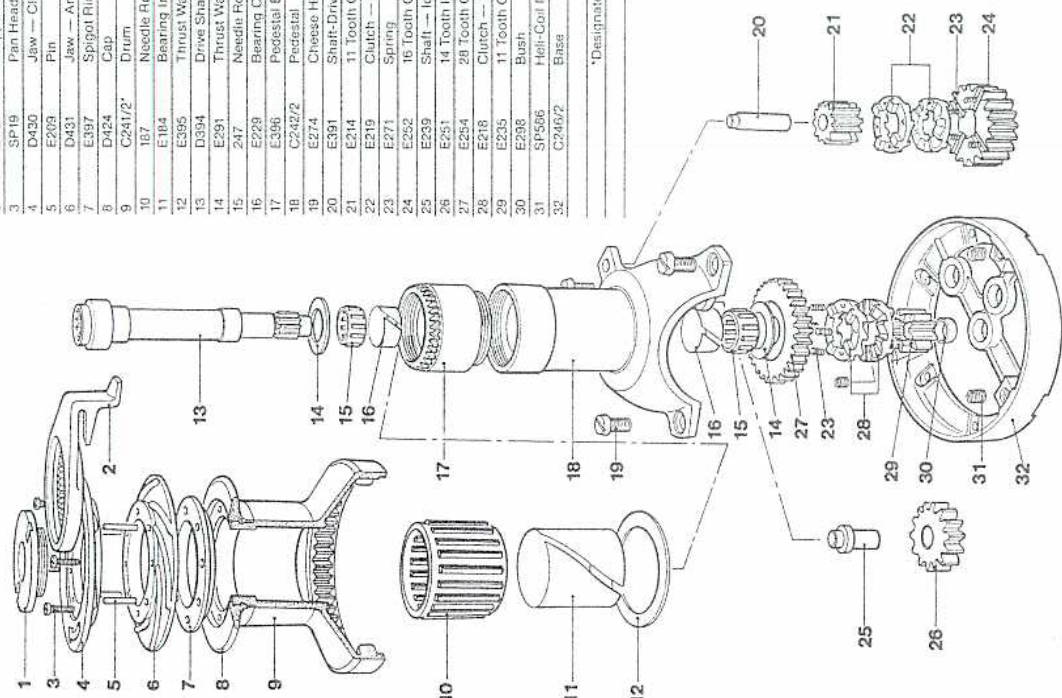

\*Designate /B for Bronze or  
/C for Chrome

Drawing Number  
C 100064



# MAXWELL 26STA

Two-speed Geared

MODEL	FINISH	PRODUCT CODE	
26STA	Alloy	58264	
ITEM	PART No.	DESCRIPTION	QTY
1	E276	Retaining Cap	1
2	D380	Stripper Arm	1
3	SP18	Pan Head Screw	4
4	D381	Jaw — Clockwise	1
5	E209	Pin	4
6	D382	Jaw — Anticlockwise	1
7	E383	Spigot Ring	1
8	D425	Cap	1
9	C261/2A	Drum	1
10	E296	Bearing Outer Race	1
11	277	Needle Roller Bearing	2
12	E297	Bearing Inner Race	1
13	E280	Thrust Washer	1
14	D384	Drive Shaft	1
15	E291	Thrust Washer	2
16	247	Needle Roller Bearing	2
17	E229	Bearing Outer Race	2
18	E385	Pedestal Extension	1
19	E262/2A	Pedestal	1
20	E274	Cheese Head Screw	3
21	E294	Shaft-Driven Gear Cluster	1
22	E266	12 Tooth Clutch Gear	1
23	E295	Clutch — Anticlockwise	2
24	E271	Spring	8
25	E257	20 Tooth Clutch Gear	1
26	E293	Shaft — Idler Gear	1
27	227	Needle Roller Bearing	1
28	E255	15 Tooth Idler Gear	1
29	E254	28 Tooth Idler Gear	1
30	E292	Clutch — Clockwise	2
31	E285	11 Tooth Clutch Gear — Splined	1
32	E298	Bush	1
33	SP586	Helix-Coil Insert	3
34	C266/2	Base	1

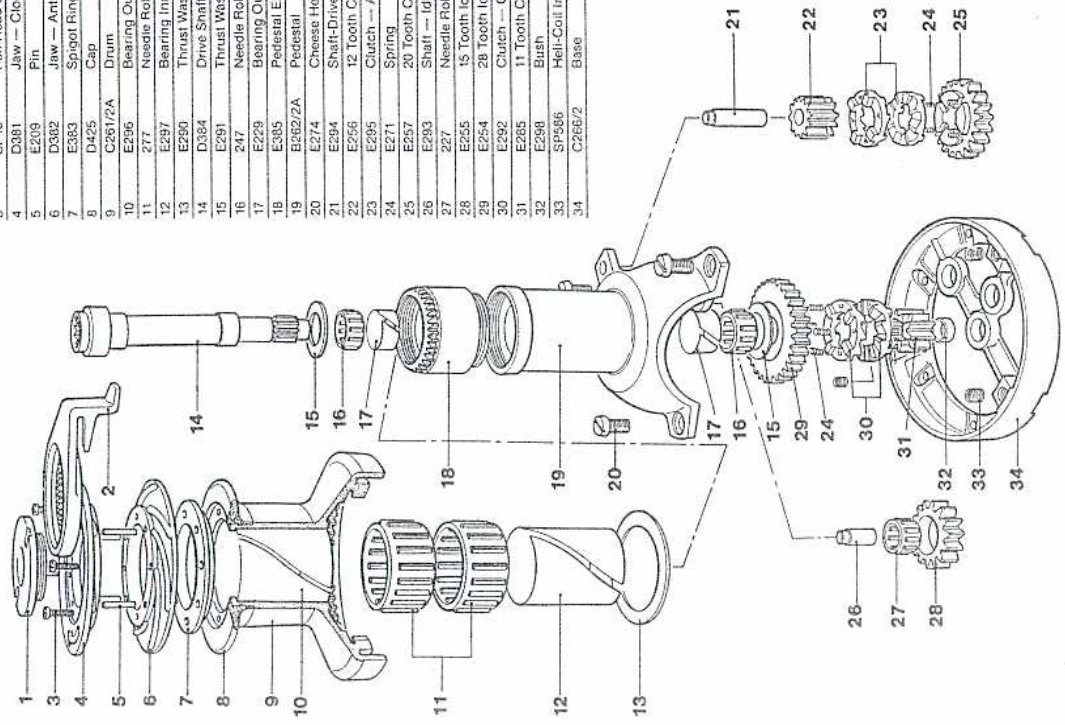

Drawing Number  
C 100069

# MAXWELL 26STB 26STC

Two-speed Geared

MODEL	FINISH	PRODUCT CODE	
26STB	Bronze	58265/B	
26STC	Chrome	58266/C	
ITEM	PART No.	DESCRIPTION	QTY
1	E276	Retaining Cap	1
2	D380	Stripper Arm	1
3	SP18	Pan Head Screw	4
4	D381	Jaw — Clockwise	1
5	E209	Pin	4
6	D382	Jaw — Anticlockwise	1
7	E383	Spigot Ring	1
8	D425	Cap	1
9	C261/2*	Drum	1
10	277	Needle Roller Bearing	2
11	E297	Bearing Inner Race	1
12	E290	Thrust Washer	1
13	D384	Drive Shaft	1
14	E291	Thrust Washer	2
15	247	Needle Roller Bearing	2
16	E229	Bearing Outer Race	2
17	E385	Pedestal Extension	1
18	B262/2A	Pedestal	1
19	E274	Cheese Head Screw	3
20	E294	Shaft-Driven Gear Cluster	1
21	E256	12 Tooth Clutch Gear	1
22	E295	Clutch — Anticlockwise	2
23	E271	Spring	8
24	E257	20 Tooth Clutch Gear	1
25	E293	Shaft — Idler Gear	1
26	227	Needle Roller Bearing	1
27	E255	15 Tooth Idler Gear	1
28	E254	28 Tooth Idler Gear	1
29	E292	Clutch — Clockwise	2
30	E285	11 Tooth Clutch Gear — Splined	1
31	E298	Bush	1
32	SP586	Helix-Coil Insert	3
33	C266/2	Base	1

\*Designate /B for Bronze or /C for Chrome

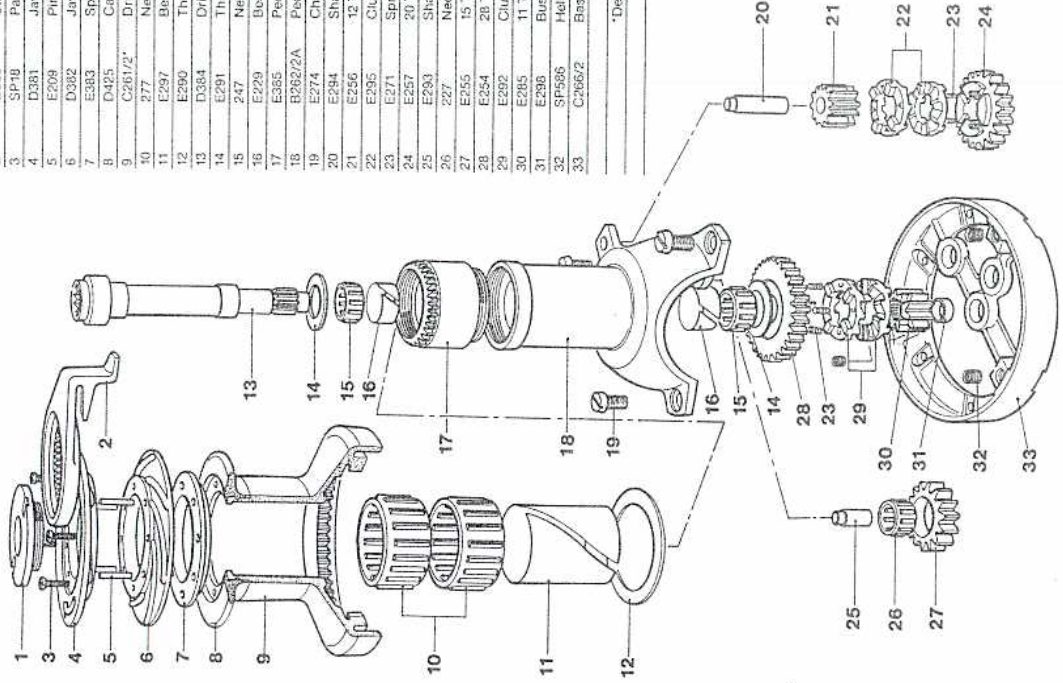

\*Designate /B for Bronze or /C for Chrome

Drawing Number  
C 100070

# MAXWELL 27STA

Two-speed Geared

MODEL	FINISH	PRODUCT CODE
27STA	Alloy	58274

ITEM	PART No	DESCRIPTION	QTY
1	E276	Retaining Cap	1
2	D380	Stripper Arm	1
3	SP18	Pan Head Screw	4
4	D432	Jaw — Clockwise	1
5	E209	Pin	4
6	D433	Jaw — Anticlockwise	1
7	E383	Spigot Ring	1
8	D426	Cap	1
9	C261/2A	Drum	1
10	E286	Bearing Outer Race	1
11	E277	Needle Roller Bearing	2
12	E297	Bearing Inner Race	1
13	E290	Thrust Washer	1
14	D384	Drive Shaft	1
15	E291	Thrust Washer	2
16	E247	Needle Roller Bearing	2
17	E229	Bearing Outer Race	2
18	E385	Pedestal Extension	1
19	B262/2A	Pedestal	1
20	E274	Cheese Head Screw	3
21	E294	Shift-Driven Gear Cluster	1
22	E256	12 Tooth Clutch Gear	1
23	E295	Clutch — Anticlockwise	2
24	E271	Spring	8
25	E259	21 Tooth Clutch Gear	1
26	E293	Shaft — Idle Gear	1
27	E255	Needle Roller Bearing	1
28	E254	15 Tooth Idle Gear	1
29	E254	28 Tooth Clutch Gear	1
30	E292	Clutch — Clockwise	2
31	E285	11 Tooth Clutch Gear — Splined	1
32	E298	Bush	1
33	SP566	Helix-Coil Insert	3
34	C266/2	Base	1

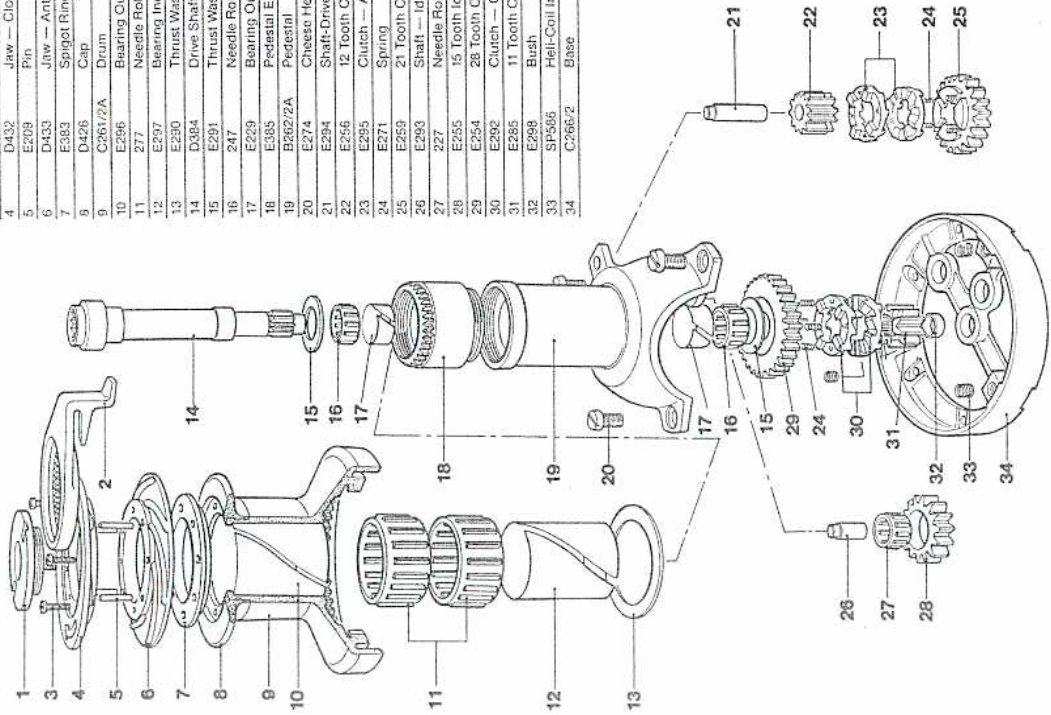

Drawing Number  
C 100073

# MAXWELL 27STB 27STC

Two-speed Geared

MODEL	FINISH	PRODUCT CODE
27STB	Bronze	58275/B
27STC	Chrome	58276/C

ITEM	PART No	DESCRIPTION	QTY
1	E276	Retaining Cap	1
2	D380	Stripper Arm	1
3	SP18	Pan Head Screw	4
4	D432	Jaw — Clockwise	1
5	E209	Pin	4
6	D433	Jaw — Anticlockwise	1
7	E383	Spigot Ring	1
8	D426	Cap	1
9	C261/2*	Drum	1
10	E277	Needle Roller Bearing	2
11	E297	Bearing Inner Race	1
12	E290	Thrust Washer	1
13	D384	Drive Shaft	1
14	E291	Thrust Washer	2
15	E247	Needle Roller Bearing	2
16	E229	Bearing Outer Race	2
17	E385	Pedestal Extension	1
18	B262/2A	Pedestal	1
19	E274	Cheese Head Screw	3
20	E294	Shift-Driven Gear Cluster	1
21	E256	12 Tooth Clutch Gear	1
22	E295	Clutch — Anticlockwise	2
23	E271	Spring	8
24	E259	21 Tooth Clutch Gear	1
25	E293	Shaft — Idle Gear	1
26	E255	Needle Roller Bearing	1
27	E254	15 Tooth Idle Gear	1
28	E254	28 Tooth Clutch Gear	1
29	E292	Clutch — Clockwise	2
30	E285	11 Tooth Clutch Gear — Splined	1
31	E298	Bush	1
32	SP566	Helix-Coil Insert	3
33	C266/2	Base	1

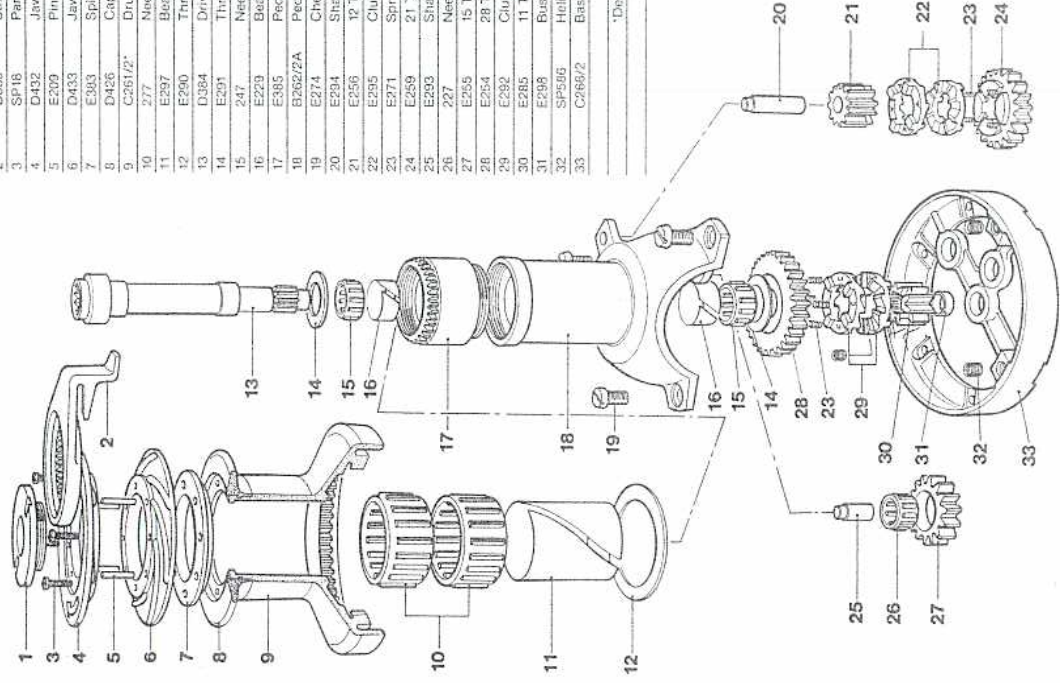

\*Designate /B for Bronze or /C for Chrome

Drawing Number  
C 100074



# MAXWELL 28STA

Two-speed Geared

MODEL	FINISH	PRODUCT CODE
28STA	Alloy	58284

ITEM	PART No	DESCRIPTION	QTY
1	E276	Retaining Cap	1
2	D386	Stripper Arm	1
3	SP17	Pin Head Screw	4
4	D387	Jaw — Clockwise	1
5	E209	Pin	4
6	D388	Jaw — Anticlockwise	1
7	E383	Spilot Ring	1
8	D299	Cap	1
9	E281/2A	Drum	1
10	E296	Bearing Outer Race	1
11	E277	Needle Roller Bearing	2
12	E297	Bearing Inner Race	1
13	E298	Thrust Washer	1
14	D389	Drive Shaft	1
15	E291	Thrust Washer	1
16	247	Needle Roller Bearing	2
17	E229	Bearing Outer Race	2
18	E385	Pedestal Extension	1
19	C282/2	Pedestal	1
20	E274	Cheese Head Screw	4
21	E294	Shaft-Driven Gear Cluster	1
22	E287	15 Tooth Clutch Gear	1
23	E295	Clutch — Anticlockwise	2
24	E271	Spring	8
25	E390	27 Tooth Clutch Gear	1
26	E293	Shaft — Idler Gear	1
27	E227	Needle Roller Bearing	1
28	E286	19 Tooth Idler Gear	1
29	E284	30 Tooth Clutch Gear	1
30	E292	Clutch — Clockwise	2
31	SP386	Hel-Coil Insert	4
32	E285	11 Tooth Clutch Gear — Splined	1
33	E298	Bush	1
34	C289/2	Base	1

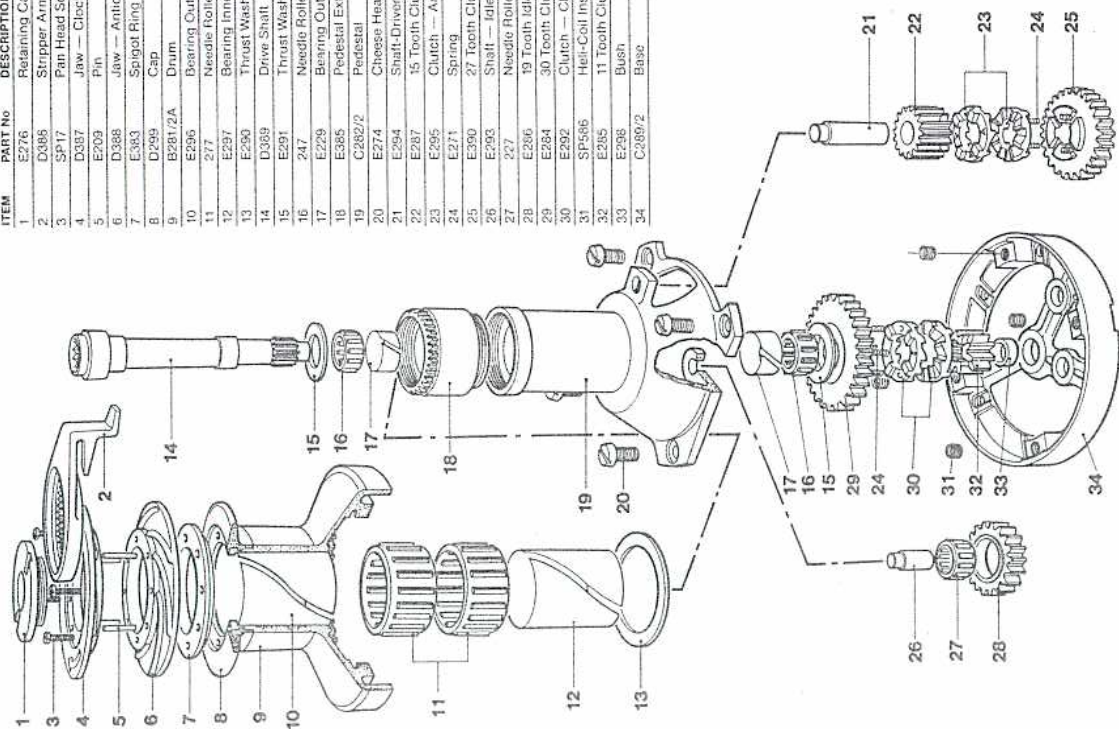

Drawing Number  
C 100081

# MAXWELL 28STB 28STC

Two-speed Geared

MODEL	FINISH	PRODUCT CODE
28STB	Bronze	58285/B
28STC	Chrome	58286/C

ITEM	PART No	DESCRIPTION	QTY
1	E276	Retaining Cap	1
2	D386	Stripper Arm	1
3	SP17	Pin Head Screw	4
4	D387	Jaw — Clockwise	1
5	E209	Pin	4
6	D388	Jaw — Anticlockwise	1
7	E383	Spilot Ring	1
8	D299	Cap	1
9	E281/2C	Drum	1
10	E277	Needle Roller Bearing	2
11	E297	Bearing Inner Race	1
12	E298	Thrust Washer	1
13	D389	Drive Shaft	1
14	E281	Thrust Washer	1
15	247	Needle Roller Bearing	2
16	E229	Bearing Outer Race	2
17	E385	Pedestal Extension	1
18	C282/2	Pedestal	1
19	E274	Cheese Head Screw	4
20	E294	Shaft-Driven Gear Cluster	1
21	E287	15 Tooth Clutch Gear	1
22	E295	Clutch — Anticlockwise	2
23	E271	Spring	8
24	E390	27 Tooth Clutch Gear	1
25	E293	Shaft — Idler Gear	1
26	E227	Needle Roller Bearing	1
27	E286	19 Tooth Idler Gear	1
28	E284	30 Tooth Clutch Gear	1
29	E292	Clutch — Clockwise	2
30	SP386	Hel-Coil Insert	4
31	E285	11 Tooth Clutch Gear — Splined	1
32	E298	Bush	1
33	C289/2	Base	1

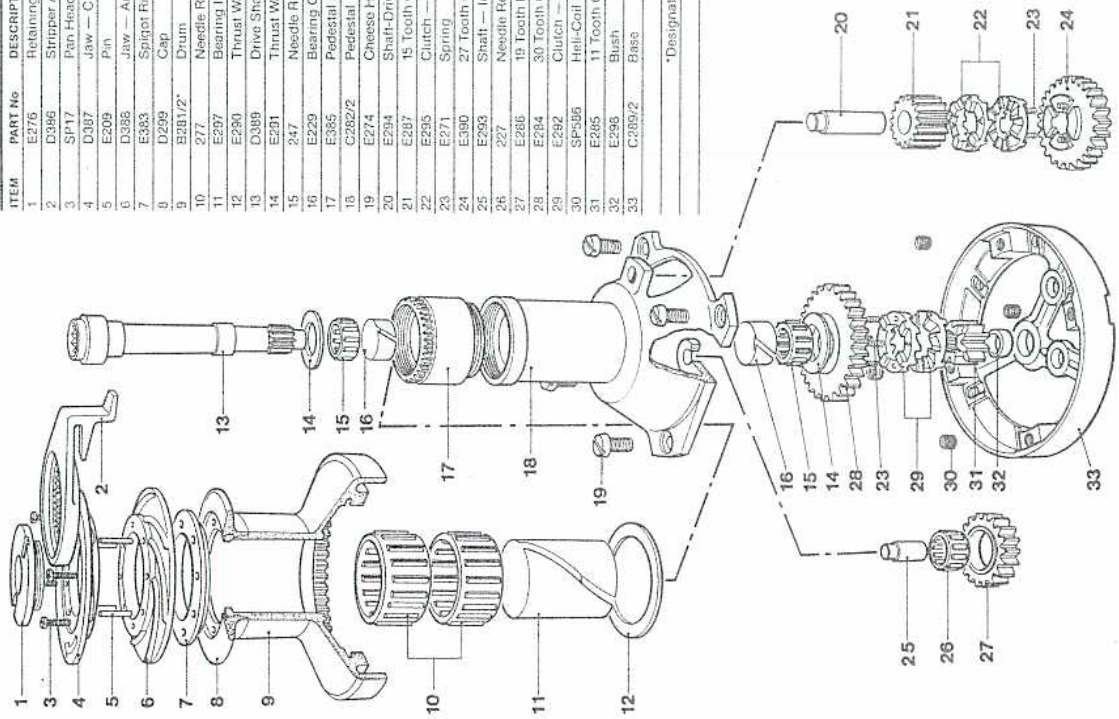

\*Designate /B for Bronze or /C for Chrome

Drawing Number  
C 100082

# MAXWELL 29STA

Two-speed Geared

MODEL	FINISH	PRODUCT CODE
29STA	Alloy	58294

ITEM	PART No	DESCRIPTION	QTY
1	E276	Retaining Cap	1
2	D386	Stripper Arm	1
3	SP17	Pan Head Screw	4
4	D435	Jaw — Clockwise	1
5	E209	Pin	4
6	D436	Jaw — Anticlockwise	1
7	E383	Spigot Ring	1
8	D434	Cap	1
9	B281/2A	Drum	1
10	E286	Bearing Outer Race	1
11	277	Needle Roller Bearing	2
12	E287	Bearing Inner Race	1
13	E280	Thrust Washer	1
14	D389	Drive Shaft	1
15	E291	Thrust Washer	2
16	247	Needle Roller Bearing	2
17	E229	Bearing Outer Race	2
18	E385	Pedestal Extension	1
19	C282/2	Pedestal	1
20	E294	Cheese Head Screw	4
21	E274	Shaft-Driven Gear Cluster	1
22	E287	15 Tooth Clutch Gear	1
23	E286	Clutch — Anticlockwise	2
24	E271	Spring	8
25	E441	29 Tooth Clutch Gear	1
26	E293	Shaft — Idler Gear	1
27	227	Needle Roller Bearing	1
28	E286	19 Tooth Idler Gear	1
29	E284	30 Tooth Clutch Gear	1
30	E282	Clutch — Clockwise	2
31	SP586	Helix-Coil Insert	4
32	E285	11 Tooth Clutch Gear — Splined	1
33	E288	Bush	1
34	C289/2	Base	1

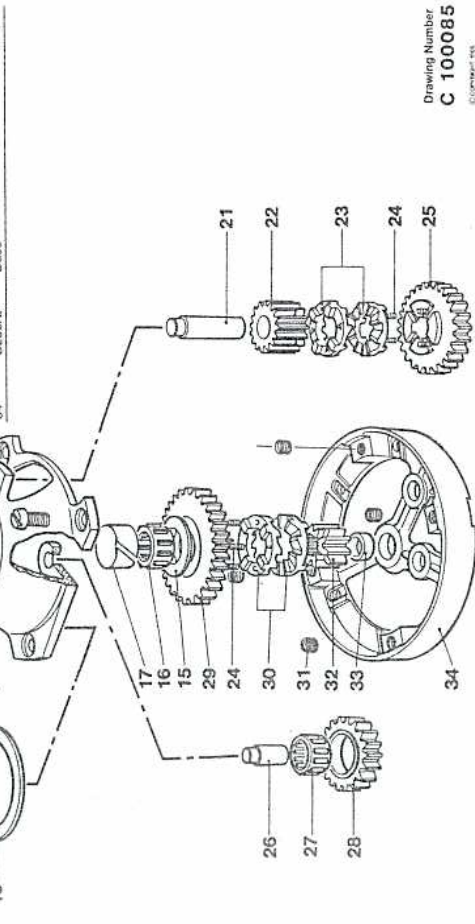

Drawing Number  
C 100085

# MAXWELL 29STB 29STC

Two-speed Geared

MODEL	FINISH	PRODUCT CODE
29STB	Bronze	58295/B
29STC	Chrome	58296/C

ITEM	PART No	DESCRIPTION	QTY
1	E276	Retaining Cap	1
2	D386	Stripper Arm	1
3	SP17	Pan Head Screw	4
4	D435	Jaw — Clockwise	1
5	E209	Pin	4
6	D436	Jaw — Anticlockwise	1
7	E383	Spigot Ring	1
8	D434	Cap	1
9	B281/2*	Drum	1
10	277	Needle Roller Bearing	2
11	E287	Bearing Inner Race	1
12	E280	Thrust Washer	1
13	D389	Drive Shaft	1
14	E291	Thrust Washer	2
15	247	Needle Roller Bearing	2
16	E229	Bearing Outer Race	2
17	E385	Pedestal Extension	1
18	C282/2	Pedestal	1
19	E294	Cheese Head Screw	4
20	E274	Shaft-Driven Gear Cluster	1
21	E287	15 Tooth Clutch Gear	1
22	E286	Clutch Anticlockwise	2
23	E271	Spring	8
24	E441	29 Tooth Clutch Gear	1
25	E293	Shaft — Idler Gear	1
26	227	Needle Roller Bearing	1
27	E286	19 Tooth Idler Gear	1
28	E284	30 Tooth Clutch Gear	1
29	E282	Clutch — Clockwise	2
30	SP586	Helix-Coil Insert	4
31	E285	11 Tooth Clutch Gear — Splined	1
32	E288	Bush	1
33	C289/2	Base	1

\*Designate /B for Bronze or /C for Chrome

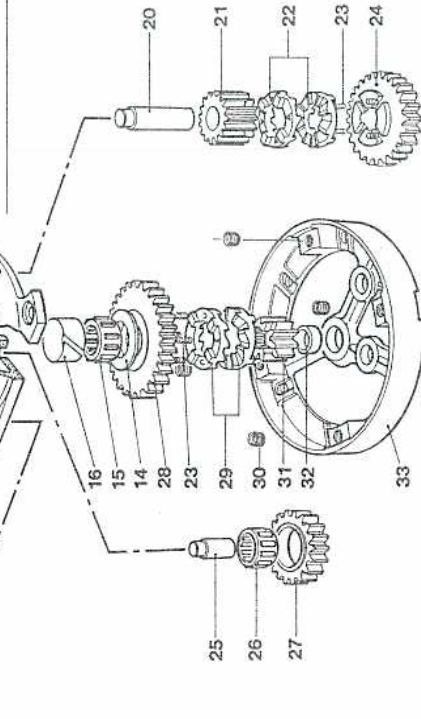

Drawing Number  
C 100086



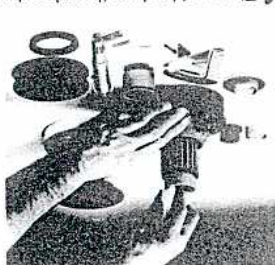

**1** Procure appropriate conversion kit and remove retaining cap — tap undone in anti-clockwise direction.



**2** Lift drum and extract drive shaft. Lock-in handle can assist.



**3** Remove thrust washer, bearing race and stainless steel bearing race from top of pedestal.

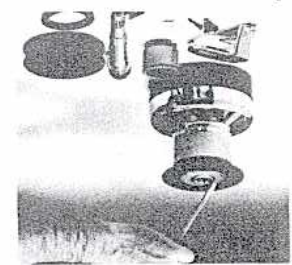

**4** Thoroughly clean thread on top of pedestal.



**5** Apply LOCTITE™ supplied with kit to the male thread of pedestal extension.

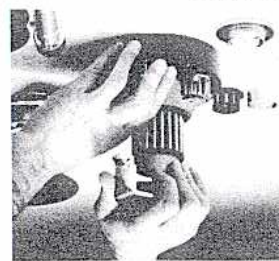

**6** Screw extension into top of pedestal and tighten firmly using a spanner.

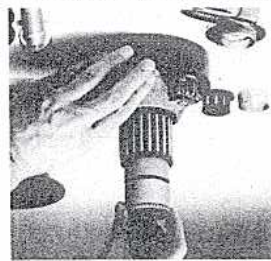

**7** Stripper arm applied to spline as

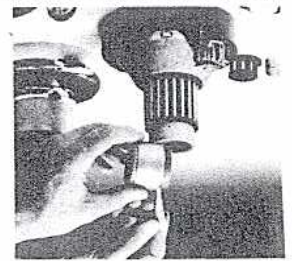

**8** Grease spline, raise drum and fit stripper arm, positioning so as to unload line into safe storage position.



**9** Using 4 screws supplied, screw jaw assembly down firmly.



**10** Locate spigot ring supplied in top of drum.



**11** Locate jaw assembly, jaw with arrow showing correct rotation uppermost, on to spigot ring and tap dowel pins into holes — tap home flush. **IMPORTANT:** Be sure to use dowel holes — not screw holes.

## Self-tailing Conversion Kits

Self-tailing conversion kits are available for the following standard MAXWELL winches:-

- 16 Bottom handle, 17, 20, 21, 22, 23, 24, 25, 26, 27, 28, 29.

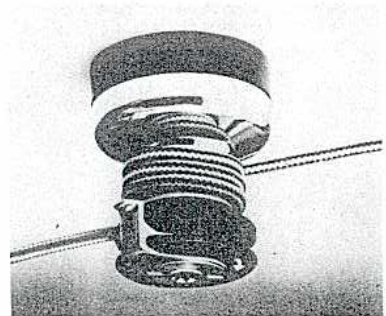

**1** Place a minimum of 3 turns of rope around the drum. Wrap in direction of arrows.

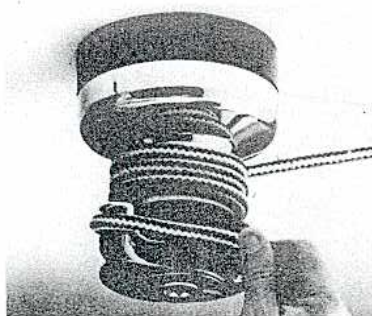

**2** Place rope over stripper arm.

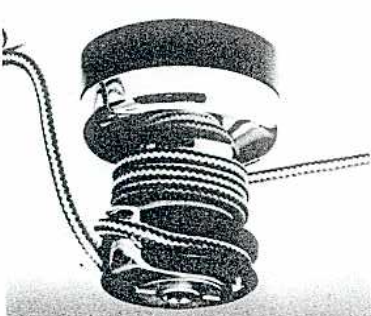

**3** Cleat into jaws — you are now ready to tail automatically.

**Notes:**  
The stripper arm should be positioned to unload the line into a safe storage position. Maxwell self-tailers automatically handle a wide variety of sheet and halyard sizes without the need for adjustment. The winch should only be used within the recommended range of line diameters. Because there is no differential and few frictional losses in the mechanism, you can through tail by hand. This means the winch can be set up before going about, for fast, safe tacking.

## Recommended Line Sizes

MODEL		
17ST	8mm - 13mm	5/16" - 1/2"
18BHST	8mm - 14mm	5/16" - 9/16"
20ST	8mm - 13mm	5/16" - 1/2"
21ST	8mm - 13mm	5/16" - 1/2"
22ST	8mm - 14mm	5/16" - 9/16"
23ST	8mm - 14mm	5/16" - 9/16"
24ST	10mm - 16mm	3/8" - 5/8"
25ST	10mm - 16mm	3/8" - 5/8"
26ST	10mm - 16mm	3/8" - 5/8"
27ST	10mm - 16mm	3/8" - 5/8"
28ST	10mm - 16mm	3/8" - 5/8"
29ST	10mm - 16mm	3/8" - 5/8"