

CRG. No. E 3018
 PRODUCT GROUP: 811
 USED ON: E03068

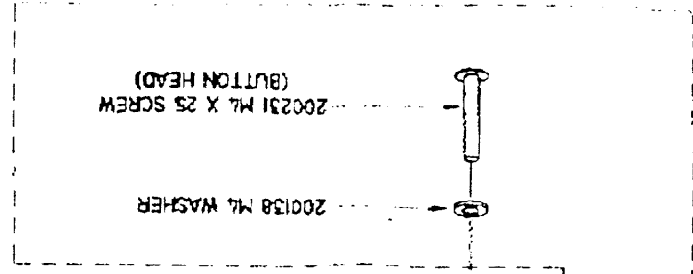
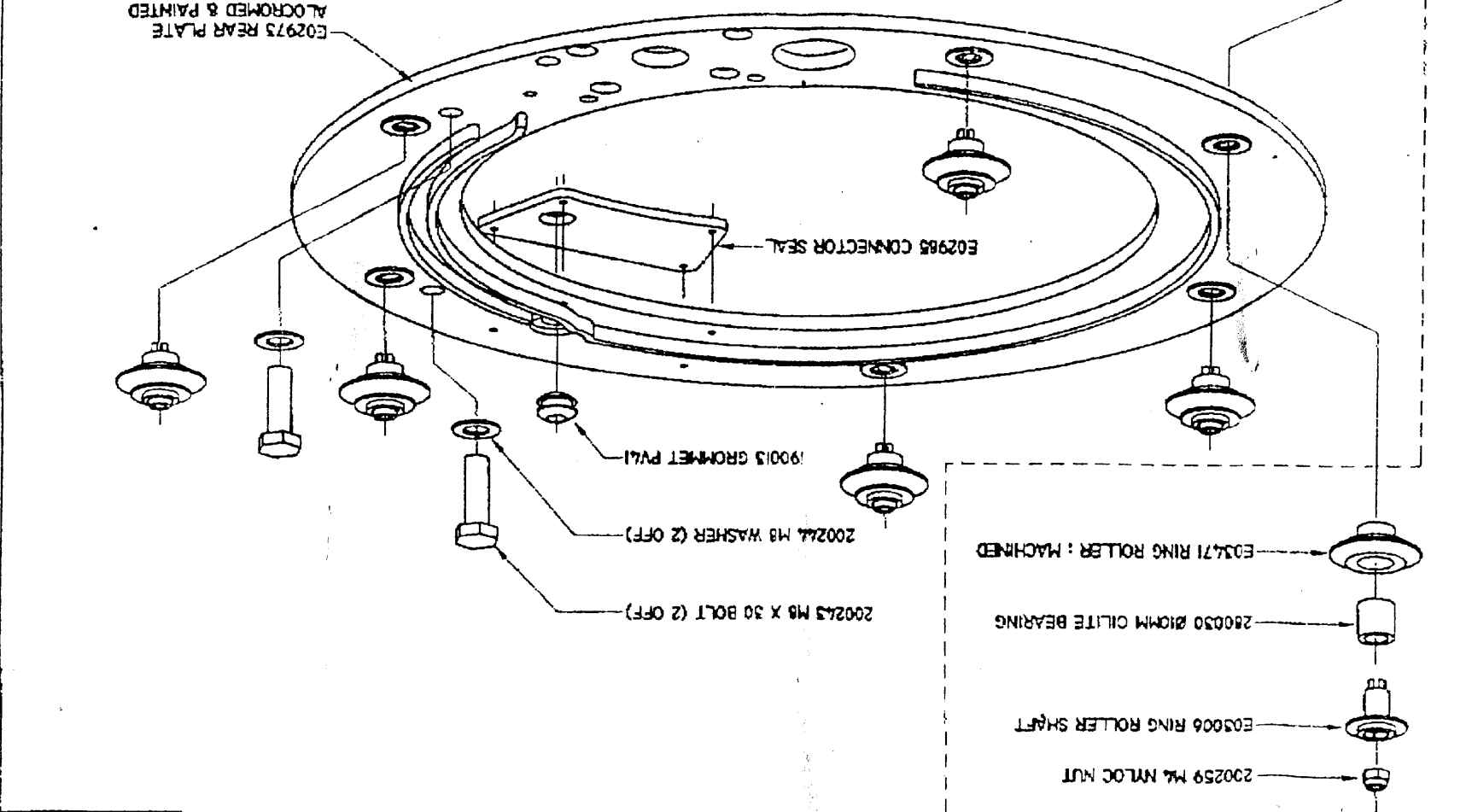

RING ROLLER ASSEMBLY - 6 OFF

200259 1/4 NMLC NUT

E03006 RING ROLLER SHAFT

280030 210MM OILITE BEARING

E03471 RING ROLLER: MACHINED

1247	5	18/10/98	E03471 RING ROLLER (6) WAS E02966 (6)
1162	2	18/4/98	200138 PIN REMOVED
Modifications			

NAVICO NAVIGATION AND COMMUNICATIONS

DATE: 18/4/98
 ORIGINAL SC: NTS

STAN LANE, HARVEST, ROYSTON CEB 44P
 TEL: 01454 380088 FAX: 01454 380073
 ADD: 1454 HOBSON

Drawn: BPL
 Checked: BM
 Approved: [Signature]
 Date: 18/10/98

Model: WP100 / 300CX
 COMPUTER GENERATED DRAWING
 MAINT. MODIFICATION INVALUABLES CAD FILE

Dimensions: + - 0.50
 0.0 - 0.25
 0.00 - 0.10
 AMG. = 0.5
 SHT. 1 OF 1

1998
 ALL DIMENSIONS IN MM

ASSY: REAR PLATE
 Dwg No.: E03018
 Issue: 3

DO NOT SCALE IF IN DOUBT ASK