

Group 104: Cooling System

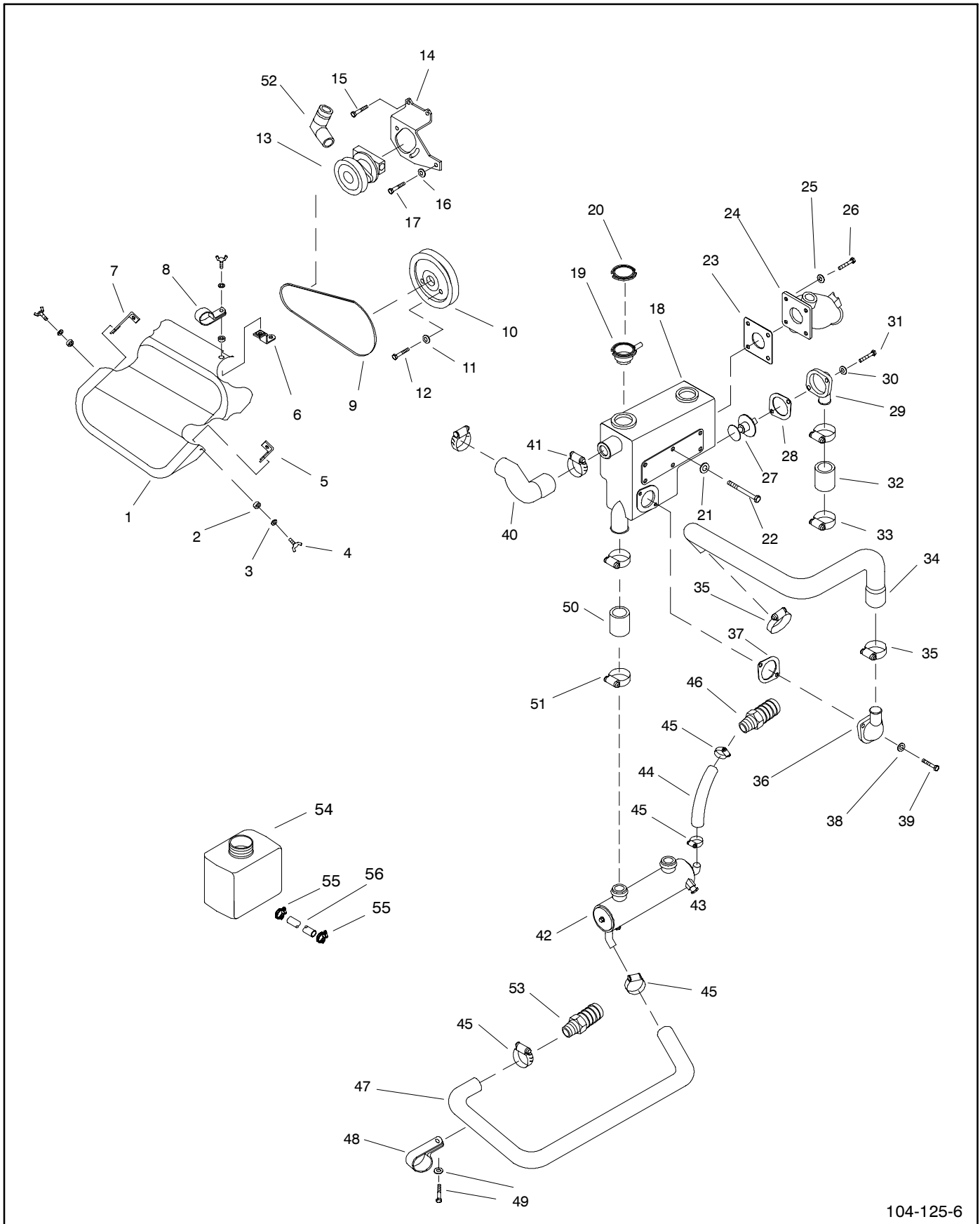

104-125-6

Group 104: Cooling System

Item	Part Number	Description	Quantity				
			Variation Number				
			6	9	13	14	16
1	229062	Guard, belt	1	1			
1	344319	Guard, belt			1	1	1
1	344815	Guard, alternator fan (not shown)					1
2	X-284-39	Grommet	3	3	3	3	3
3	#	Washer, 1/4	3	3	3	3	3
4	229330	Screw, wing	3	3	3	3	3
5	229069	Bracket, belt guard	1	1	1	1	
5	344816	Bracket, belt guard					1
6	229067	Bracket, belt guard	1	1	1	1	
6	344817	Bracket, belt guard					1
7	229068	Bracket, belt guard	1	1	1	1	
7	344818	Bracket, belt guard					1
8	X-672-25	Clamp, insulated	1	1	1	1	1
9	229125	V-Belt	1	1	1	1	1
10	229054	Pulley, seawater pump	1	1	1	1	1
11	#	Washer, 7/16	2	2	2	2	2
12	X-6051-3	Screw, H.C	2	2	2	2	2
13	See Table on page 38	Pump, seawater	1	1	1	1	1
14	344844	Bracket, seawater pump	1	1	1	1	1
15	X-6068-4	Screw, HC	2	2	2	2	2
16	X-400-199	Spacer	1	1	1	1	1
17	X-6050-6	Screw, hex head cap	1	1	1	1	1
18	260115	Manifold, exhaust	1	1	1	1	1
19	241311	Neck (50 440 01)	1	1	1	1	1
20	276954	Cap, 7 psi	1	1	1	1	
20	229980	Cap, 14 psi	1	1	1	1	
20	226734	Cap, 14 psi					1
21	#	Washer, 5/16	6	6	6	6	6
22	X-6050-14	Screw, hex head cap	6	6	6	6	6
23	249905	Gasket, exhaust	1	1	1	1	1
24	229063	Tube, mixing	1	1	1	1	1
25	#	Washer, 5/16	4	4	4	4	4
26	X-125-5	Screw, 5/16-18 x 1, ref.	4	4	4	4	
27	254920	Thermostat	1	1	1	1	1
28	229963	Gasket, water outlet	1	1	1	1	1
29	229064	Cover, thermostat	1	1	1	1	1
30	#	Washer, 5/16	2	2	2	2	2
31	X-125-31	Screw, 5/16-8 x .875, ref.	2	2	2	2	2
32	229232	Hose, coolant	1	1	1	1	1
33	X-426-8	Clamp, hose 15/16 x 1-3/4	2	2	2	2	
34	229272	Hose, molded	1	1	1	1	
34	344825	Hose, molded					1
35	X-426-8	Clamp, hose 15/16 x 1-3/4	2	2	2	2	2
36	229064	Cover, thermostat	1	1	1	1	1
37	229963	Gasket, water outlet	1	1	1	1	1
38	#	Washer, 5/16	2	2	2	2	2
39	X-125-31	Screw, 5/16-8 x .875, ref.	2	2	2	2	2
40	229057	Hose, molded	1	1	1	1	1
41	X-426-8	Clamp, hose 15/16 x 1-3/4	2	2	2	2	2
42	229058	Exchanger, heat (includes item 43)	1	1	1	1	1
43	260085	Zinc anode 0.375 in., 9.52 mm	1	1	1	1	1
43	229972	Zinc anode 0.5 in., 12.70 mm	1	1	1	1	1
44	X-312-16	Hose	1	1	1	1	1
45	X-426-3	Clamp, hose 1/2 x 1-13/32	4	4	4	4	4
46	X-391-26	Connector, hose	1	1			
46	X-391-2	Connector, hose			1	1	1
47	X-312-46	Hose	1	1	1	1	1
48	X-672-3	Clamp, insulating	1	1	1	1	1
49	#	Washer, 5/16	1	1	1	1	1
50	229232	Hose, coolant	1	1	1	1	1
51	X-426-8	Clamp, hose 15/16 x 1-3/4	2	2	2	2	2
52	X-391-26	Elbow, 90 deg. hose connector	1				
52	X-391-31	Elbow, 90 deg. hose connector		1		1	
52	X-391-2	Elbow, 90 deg. hose connector			1		1
53	X-582-19	Hose connector	1	1			
53	X-582-2	Hose connector			1	1	1
54	249396	Bottle, overflow (cap 229980)	1	1			
54	359037	Bottle, overflow			1	1	1
54	359038	Bracket, water bottle (not shown)			1	1	1
54	X-400-74	Spacer (not shown)			1	1	1
54	X-6050-8	Screw, hex head cap (not shown)			1	1	1
55	X-426-9	Clamp, hose	1	1	2	2	2
56	X-386-34	Line, flex fuel 5/16 x 28			1	1	1

Common hardware. Procure locally.