

WESTERBEKE 52 - COOLING SYSTEM

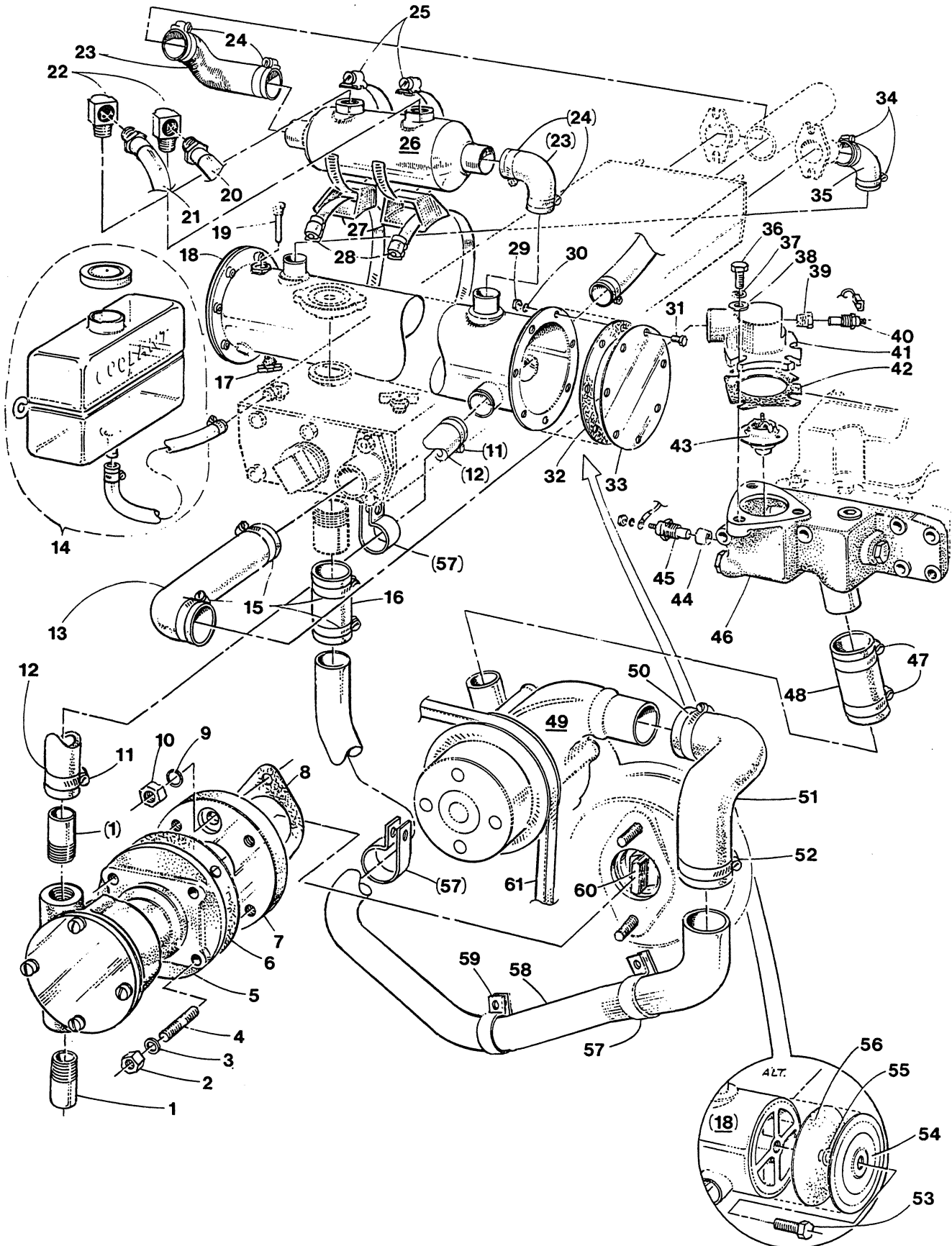

WESTERBEKE 52 – COOLING SYSTEM

REF	PN	NAME	REMARKS	QUAN
1	32230	NIPPLE	1/2NPT TO 7/8ID HOSE	2
2	31760	NUT	5/16NF	4
3	31758	LOCKWASHER	5/16	4
4	11263	STUD		4
5	16423	PUMP	SEA WATER	1
6	11143	GASKET	SEA WATER PUMP TO ADAPTER	1
7	30106	ADAPTER	SEA WATER PUMP TO TIMING COVER	1
8	24399	GASKET	ADAPTER TO TIMING COVER	1
9	31758	LOCKWASHER	5/16	2
10	31761	NUT	5/16NF JAM	2
11	11386	CLAMP	HOSE 12	2
12	19059	HOSE	WIRE INSERTED 7/8ID INCHES REQD	32
13	24334	HOSE	ELBOW	1
14	24977	KIT	COOLANT RECOVERY TANK	1
15	21878	CLAMP	HOSE 20	4
16	24974	HOSE	WIRE INSERTED 1-3/8ID INCHES REQD	4
17	11471	PETCOCK		1
18	36905	EXCHANGER	HEAT	1
19	11885	ZINC		1
20	30957	HOSE	OIL 27IN LONG	1
21	30958	HOSE	OIL 21IN LONG	1
22	13330	ELBOW		2
23	24305	HOSE	ELBOW	2
24	21878	CLAMP	HOSE 20	4
25	11411	CLAMP	HOSE 32	2
26	34484	COOLER	OIL	1
27	24295	ADAPTER	COOLER TO EXCHANGER	2
28	30047	CLAMP	MOUNT EXCHANGER TO HOUSING	2
29	31750	NUT	1/4NC	14
30	31752	LOCKWASHER	1/4	14
31	31502	CAPSCREW	1/4NC X 5/8	14
32	31291	GASKET	EXCHANGER END COVER	2
33	31290	COVER	EXCHANGER END	2
34	21878	CLAMP	HOSE 20	2
35	24974	HOSE	WIRE INSERTED 1-3/8ID INCHES REQD	7
36	31580	CAPSCREW	5/16NF x 1	3
37	31758	LOCKWASHER	5/16	3
38	31759	WASHER	FLAT 5/16	3
39	22131	BUSHING	1/4NPT TO 1/8NPT	1
40 – 1	30125	SWITCH	WATER TEMPERATURE FOR ALARM – PROPULSION	1
40 – 2	30096	SWITCH	WATER TEMPERATURE FOR SAFETY- GENSET	1
41	24258	HOUSING	UPPER THERMOSTAT	1
42	24323	GASKET	THERMOSTAT	1
43	24690	THERMOSTAT	WITH BOTTOM BYPASS AND BLEED HOLE	1
44	24672	BUSHING	HOUSING TO 1/8NPT FOR SENDER	1
45	23571	SENDER	WATER TEMPERATURE	1
46	30981	HOUSING	LOWER THERMOSTAT	1
47	11405	CLAMP	HOSE 16	2
48	24415	HOSE	THERMOSTAT HOUSING TO FRESH WATER PUMP	1
49	32213	PUMP	FRESH WATER	1